

Astronaut Projection Lamp

Product Instruction

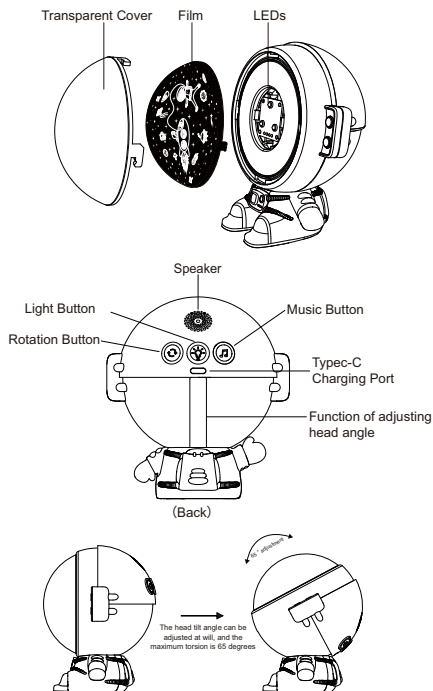

Product Features

- 1.This product has the function of projector lamp, which is colorful and interesting.
- 2.This product has the music function, which creates a romantic atmosphere.

Product Information

Item Name	Astronaut Projection Lamp	Rated Power	4.1W
Item No	YS-LSL545	Battery Capacity	1200mAh
Rated Current	5V	Accessory	Type-C USB Cable
Rated Voltage	1A	Material	ABS+PC+PVC+ Electronic components
Item Size	110x93x121mm		

Function Instruction

Rotation Button

	When turn on the light
Press once	The projection screen rotates clockwise
Press twice	Pause rotation function

Light Button

1st Press	Cold White light
2nd Press	Blue light
3rd Press	Warm yellow light
4th Press	Three color gradient
5th Press	Turn off light

Step-less dimming: press and hold for two seconds to enter step-less dimming, and the light brightness will increase from the initial brightness to 100%. Release the button, press and hold for two seconds again, and the light will reduce from 100% to 30%. Light has memory function (Memorize the final brightness), Three color gradient mode can not use step-less dimming.

Music Button

Press the music button, the music will play. Press it once to switch to different music, a total of 8 songs; press for two seconds to turn off the music. (No need to turn on the light.)

Instructions of use

1. The product is powered by 5V \pm 1A, please do not use an adapter with power over 5V \pm 2A to charge or power it.(The product is only equipped with USB cable without adapter)
2. Please fully charge the product before using it. The red light flashes when charging and the red light stays on when fully charged. It takes about 2.5 hours to fully charge, and the longest charging time can not exceed 8 hours, so as not to damage the battery and shorten the product life.
3. This product can be used for 2-24 hours with full charge according to different gears.
4. How to use :

- ① Press and hold the transparent lamp cover and turn it counterclockwise to take out the transparent lamp cover.

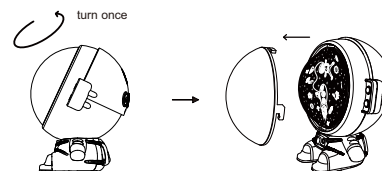

- ② Take out the film, put in the film to be replaced, and align it with the snap position device.

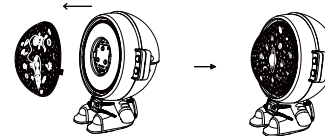

- ③ Close the transparent lamp cover, align it with the snap position device of the transparent lamp cover, press and hold the transparent lamp cover, and rotate it clockwise for fixation.

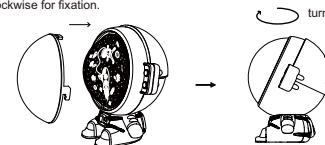

Attention

1. Please check the voltage of this product and its compatibility before use.
2. Do not expose to the sun, and do not use in the environment of water mist, humidity, dirt, high temperature, etc.
3. It is forbidden to put the product into or close to the fire source to avoid fire and explosion hazards.
4. Please use it on the table with inclination no more than 6 degrees to prevent dumping.
5. Do not use the product for children under 6 years old to avoid danger.
6. When assembling the lampshade, attention should be paid to whether the lampshade is screwed in place, to avoid the failure of fastening, and the lampshade falling off.
7. The light source in the lamp shall be replaced by the manufacturer or other agent or person with similar qualification.
8. The battery should be disposed of safely. The waste battery should not be discarded randomly. and it should be placed in special battery recycling bin.

YS-LSL545宇航员投影灯英文说明书尺寸35x10.5cm 折叠尺寸7x10.5cm