

0094NOTIC6130

# AMENAGEMENT PLACARD

OPEN DRESSING UNIT

UKŁAD SZAFY

ASPECT DULAP

ARREGLO DE ARMARIO

ARRUMAÇÃO

DOLAP DÜZENI



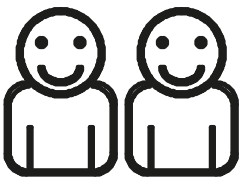

## FR- Conseils de préparation au montage

EN- Assembly preparation tips PL- Wskazówki dotyczące przygotowania montażu RO- Sfaturi de pregătire pentru asamblare

ES- Consejos de preparación para el montaje PT- Conselhos de preparação para a montagem TR- Montaj hazırlığı ipuçları

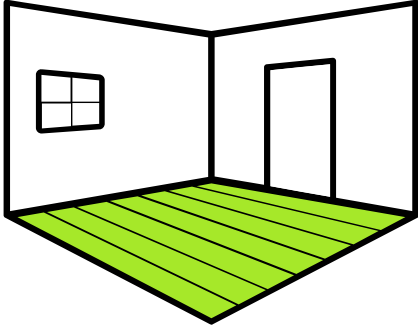

### FR- Faire un peu de place

EN- Make a little room  
PL- Zrób sobie trochę miejsca  
RO- Faceți o cameră  
ES- Encontrar algo de espacio  
PT- Um pouco de espaço  
TR- Yer açmak

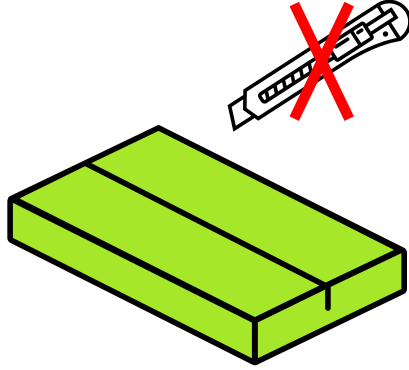

### FR- Pas d'outils tranchants

EN- No sharp tools  
PL- Brak ostrych narzędzi  
RO- Fără scule ascuțite  
ES- No hay herramientas afiladas  
PT- Sem ferramentas de corte  
TR- Keskin alet yok

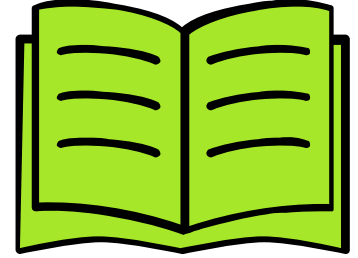

### FR- Bien suivre les instructions de la notice de montage

EN- Follow the instructions in the installation instructions  
PL- Postępuj zgodnie z instrukcjami zawartymi w instrukcji instalacji  
RO- Urmați instrucțiunile din instrucțiunile de instalare  
ES- Siga las instrucciones de montaje  
PT- Seguir as instruções de montagem  
TR- Kurulum talimatlarındaki talimatları uygulayın

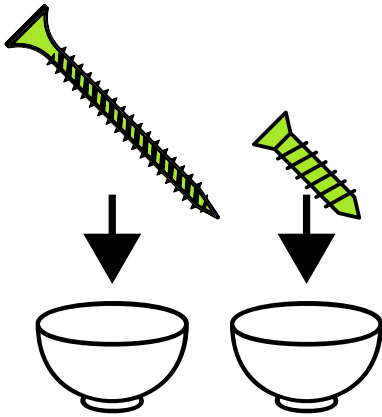

### FR- Trier vos quincailleries

EN- Sort your hardware stores  
PL- Uporządkuj sklepy sprzętowe  
RO- Sortați magazinele de hardware  
ES- Ordenar sus ferreterías  
PT- Separar as suas ferragens  
TR- Donanım mağazalarınızı sıralama

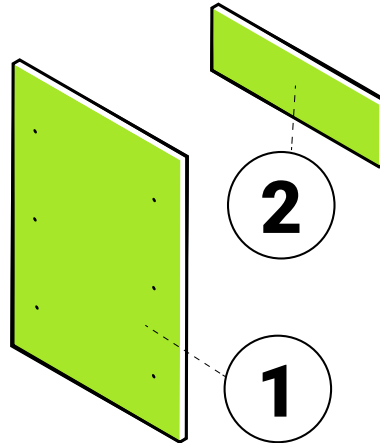

### FR- Repérer vos pièces

EN- Locate your parts  
PL- Zlokalizuj swoje części  
RO- Localizați piesele  
ES- Detectar sus piezas  
PT- Localizar as suas peças  
TR- Parçalarınızı bulun

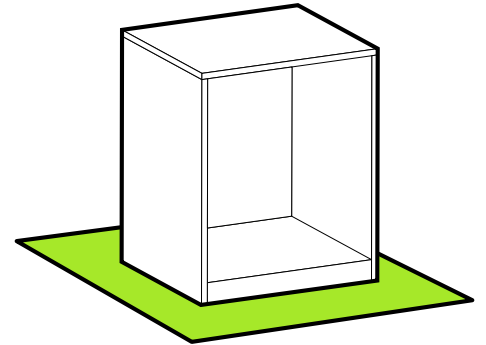

### FR- Protéger votre sol

EN- protecting your floor  
PL- Chronić swoją glebę  
RO- Protejați-vă solul  
ES- proteger su suelo  
PT- Proteger o seu solo  
TR- Toprağınızı koruyun

## FR- Matériel nécessaire

EN- necessary equipment PL- niezbędny sprzęt RO- materialele necesare

ES- material necesario PT- material necessário TR- gerekli malzemeler

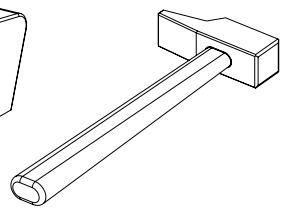
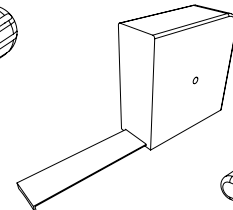
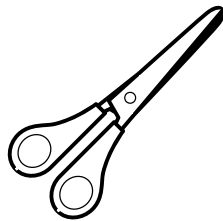
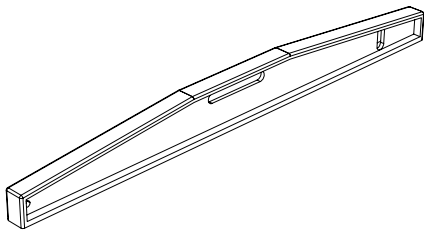

## Conseils d'entretien

EN- maintenance tips PL- Porady pielęgnacyjne  
RO- sfaturi de îngrijire ES- consejos de mantenimiento  
PT- dicas de manutenção TR- Bakım Talimatları

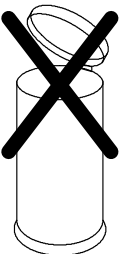
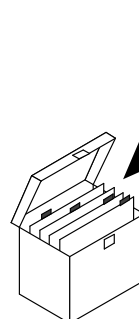

COLIS 1/2

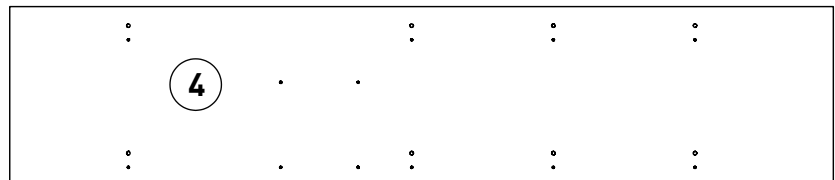

186x39,9x1,5cm

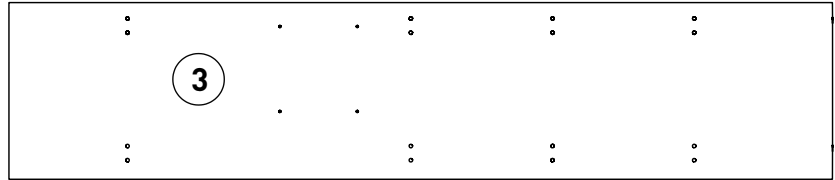

186x39,9x1,5cm

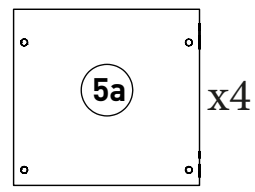

42x39,8x1,5cm

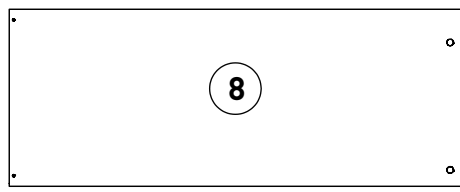

102x40x1,5cm

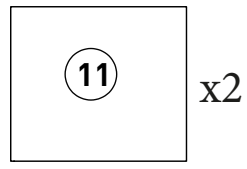

39,7x34,9x0,25cm

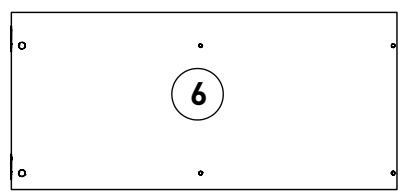

87,1x40x1,5cm

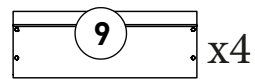

41,5x15x1,5cm

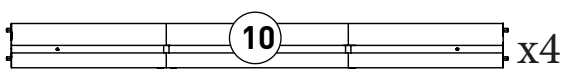

111,1x10x1,25cm

COLIS 2/2

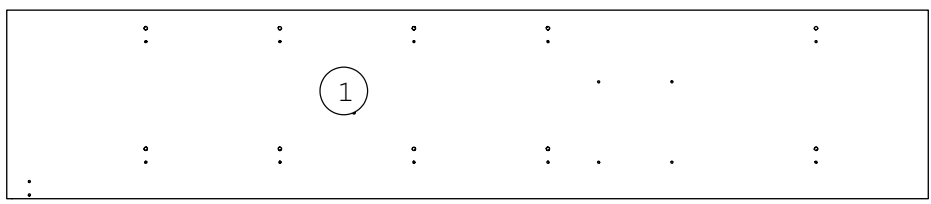

220x45x1,5cm

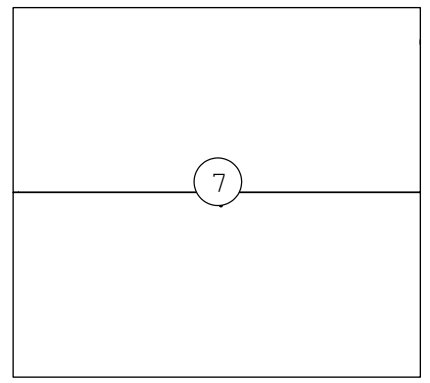

97,2x88,2x0,25cm

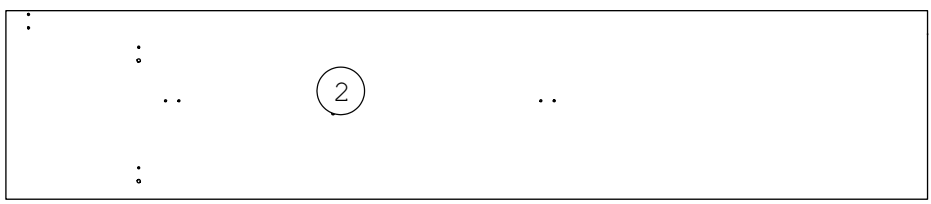

220x45x1,5cm

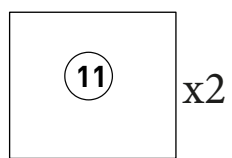

39,7x34,9x0,25cm

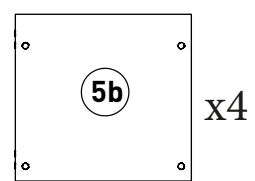

42x39,8x1,5cm

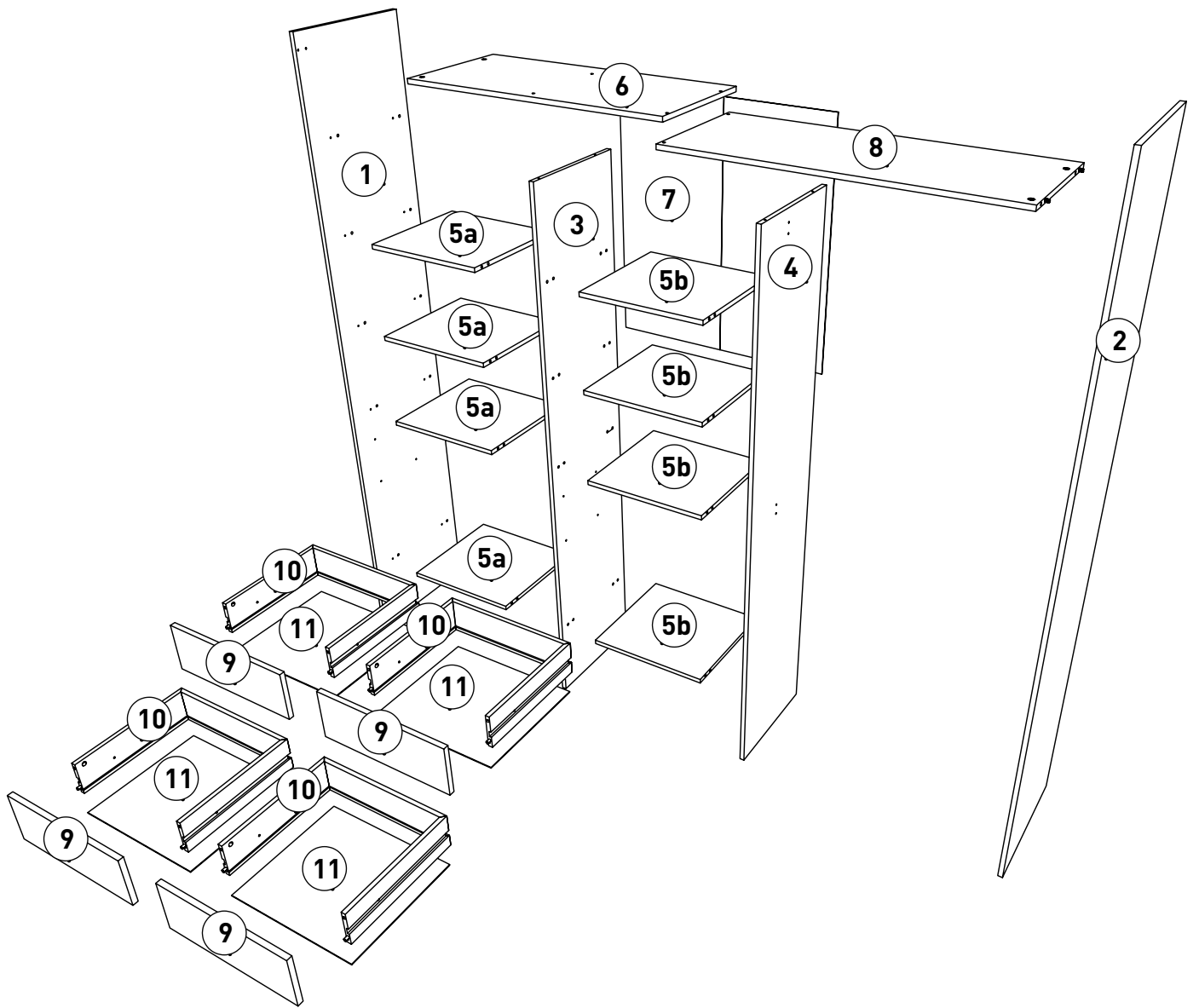

0 1cm 2 3 4 5

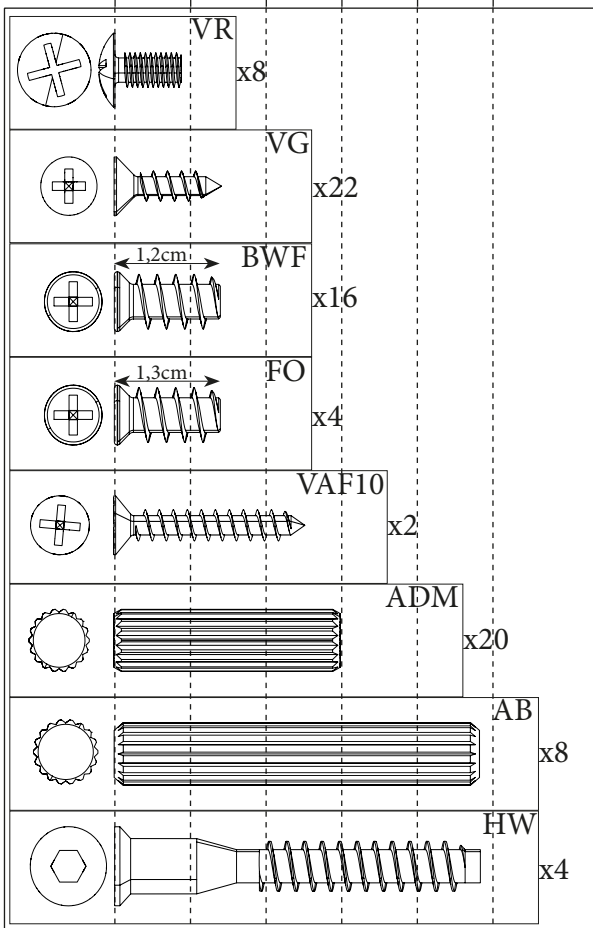

FR- Trier vos quincailleries  
 EN- Sort your hardware stores  
 PL- Uporządkuj sklepy sprzętowe  
 RO- Sortați magazinele de hardware  
 ES- Ordenar sus ferreterías  
 PT- Separar as suas ferragens  
 PT- Donanım mağazalarınızı sıralama

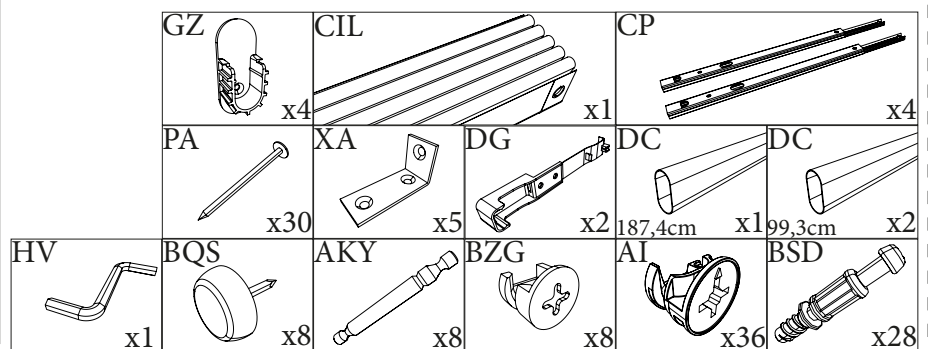

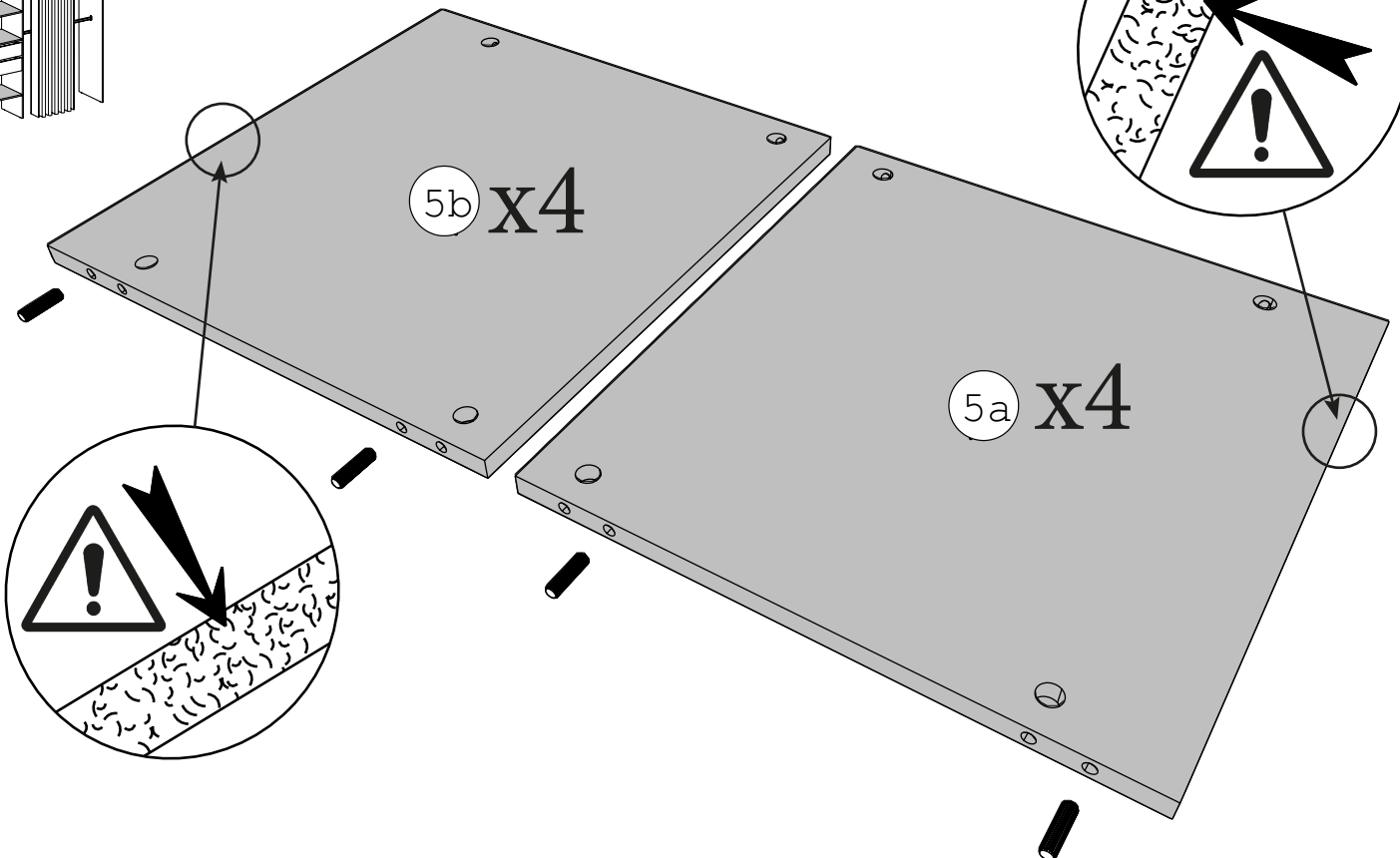
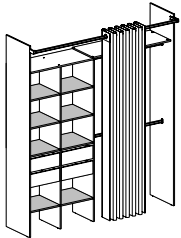
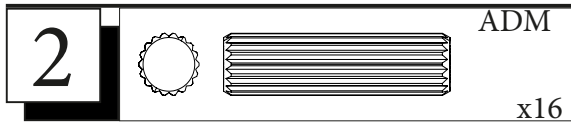
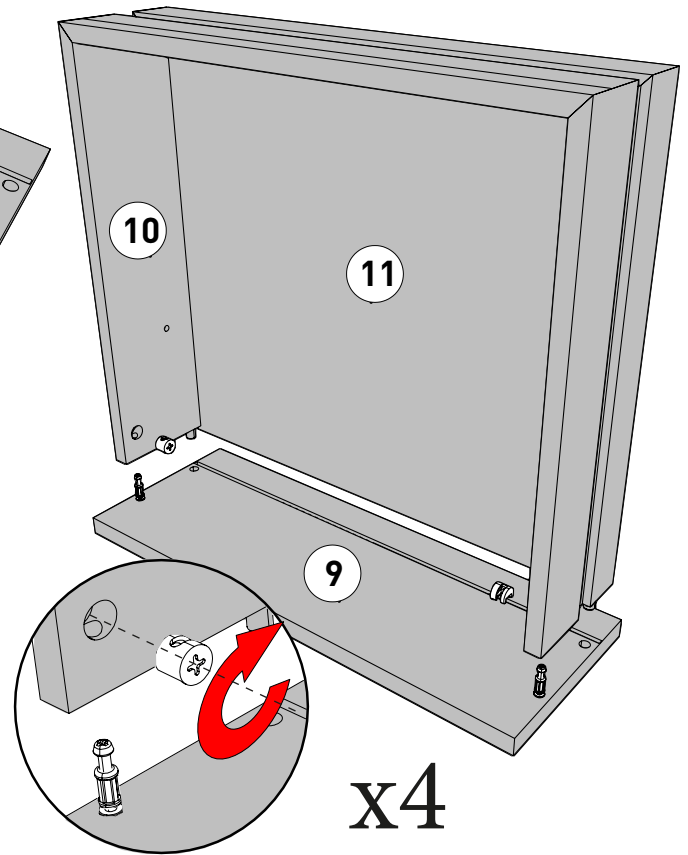
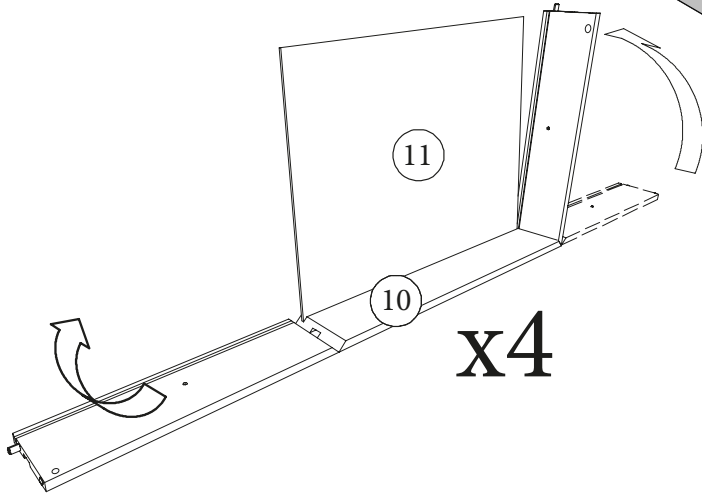
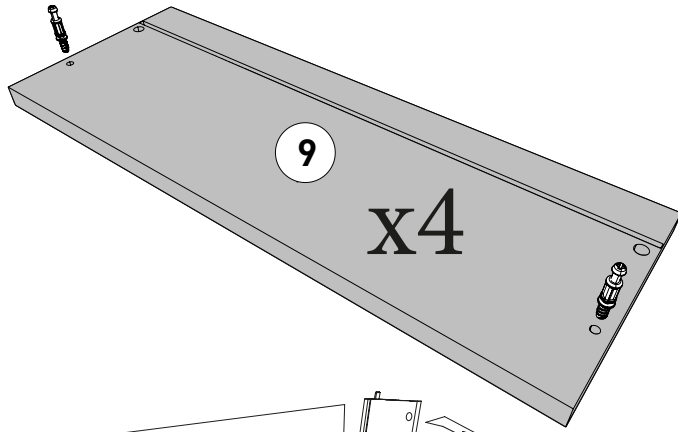
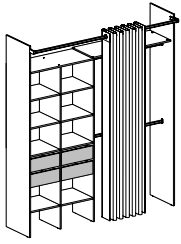
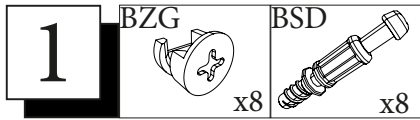

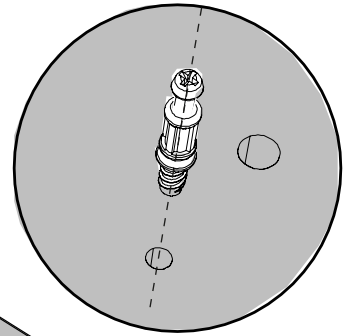
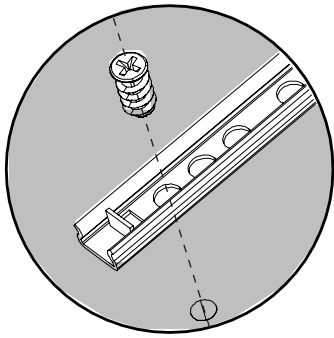
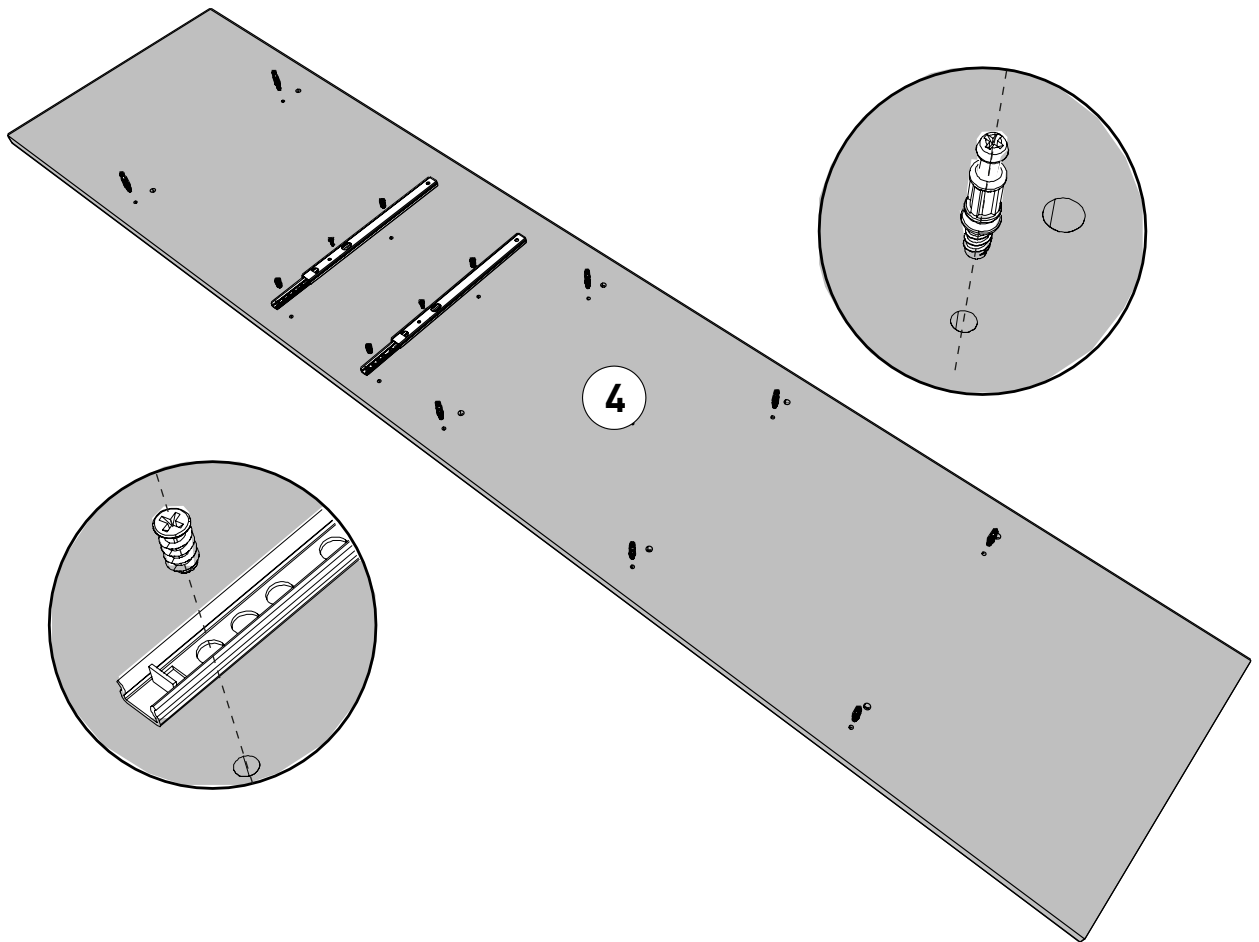
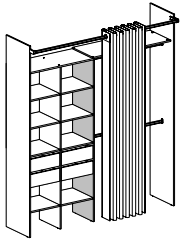
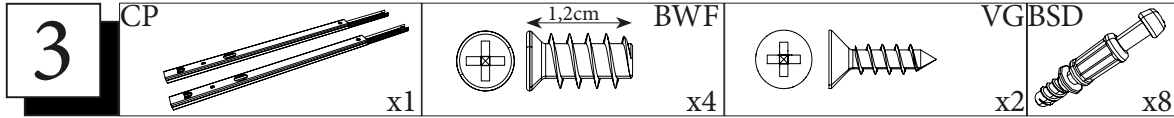

## Extérieur du meuble

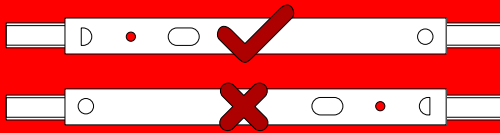

EN - Exterior of the furniture PL - Zewnętrzne elementy mebli  
 RO - Exteriorul mobilei ES - Exterior del mueble  
 PT - Exterior do móvel TR - Mobilyaların dışı

1

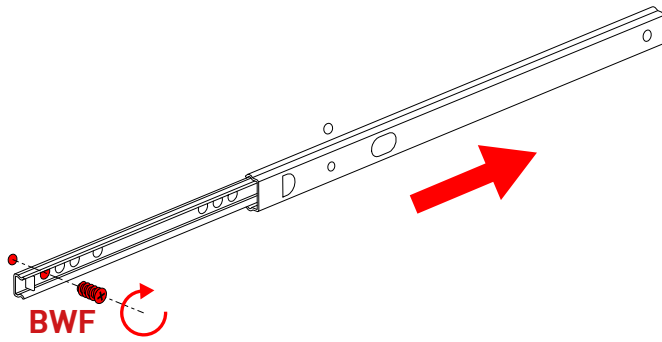

2

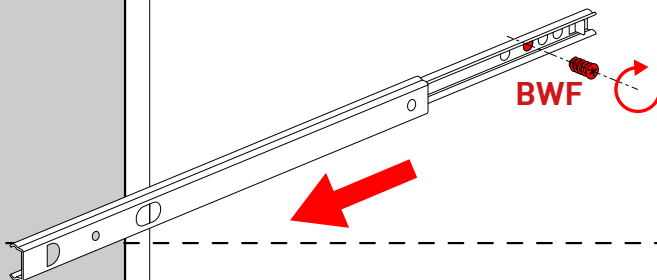

3

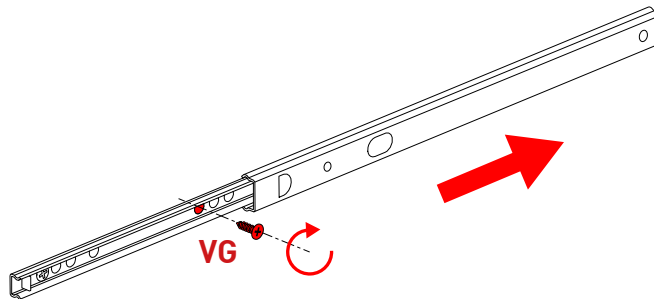

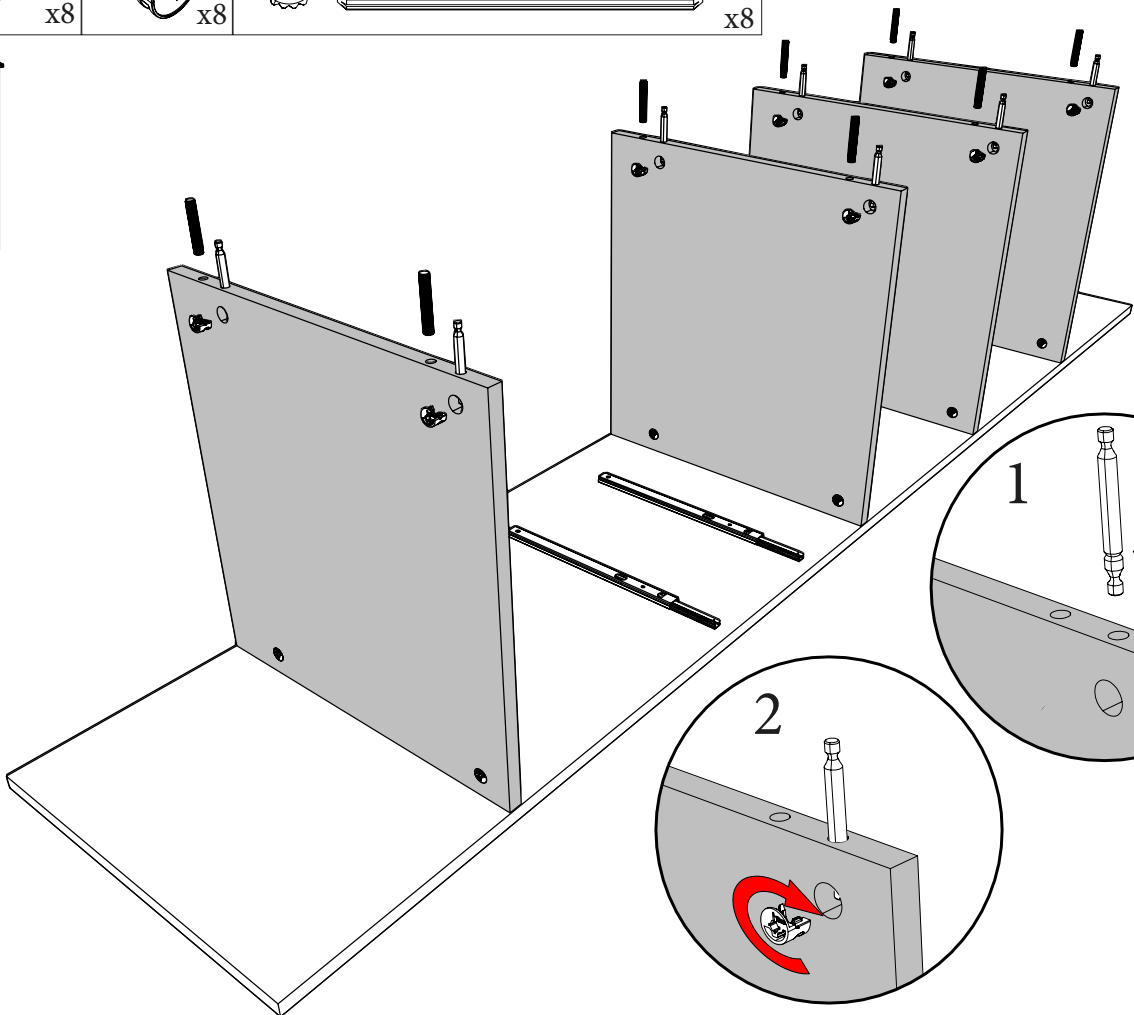
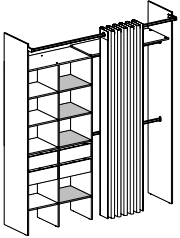
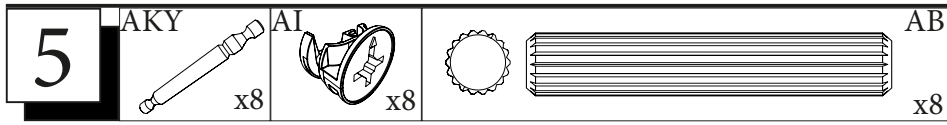
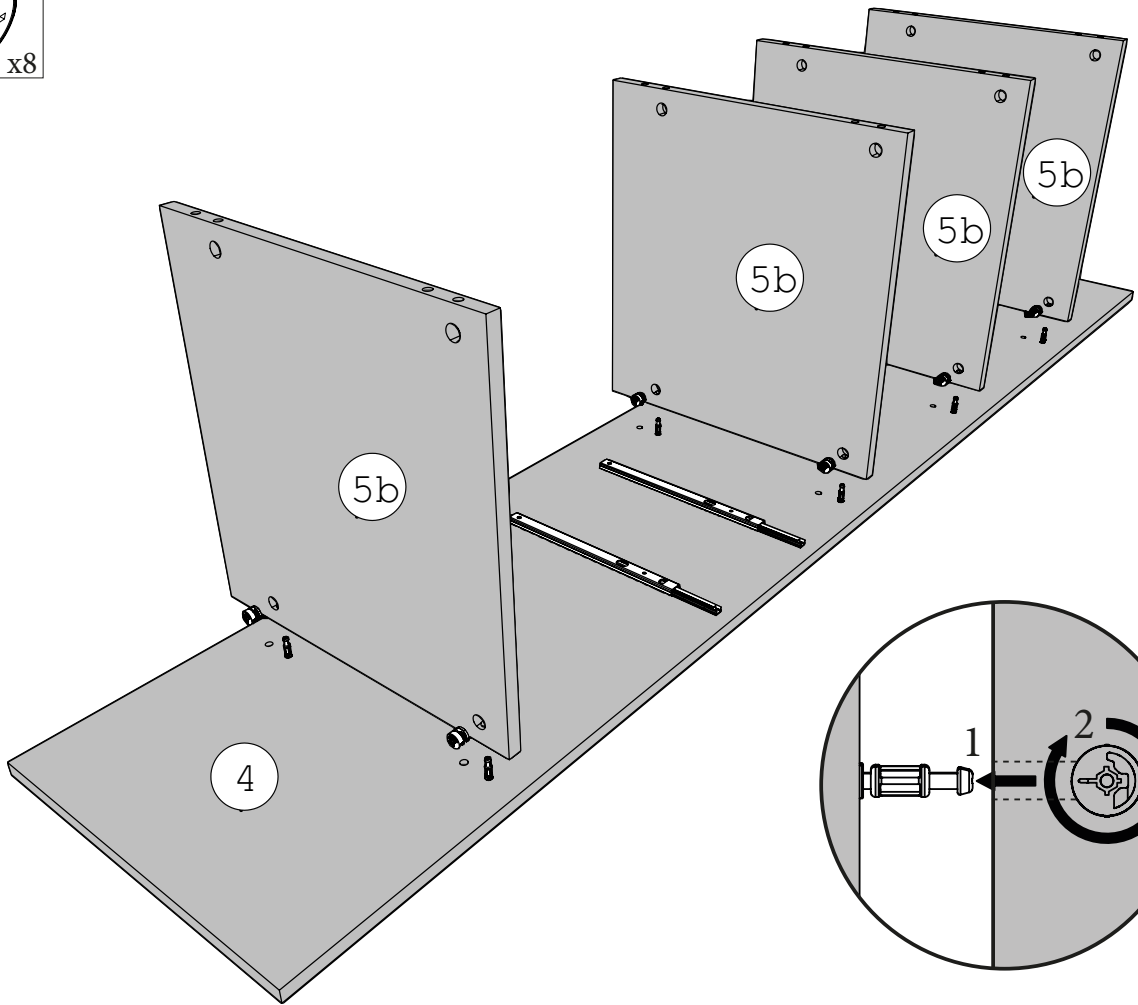
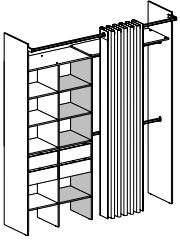
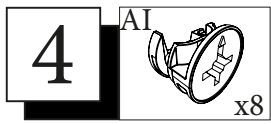

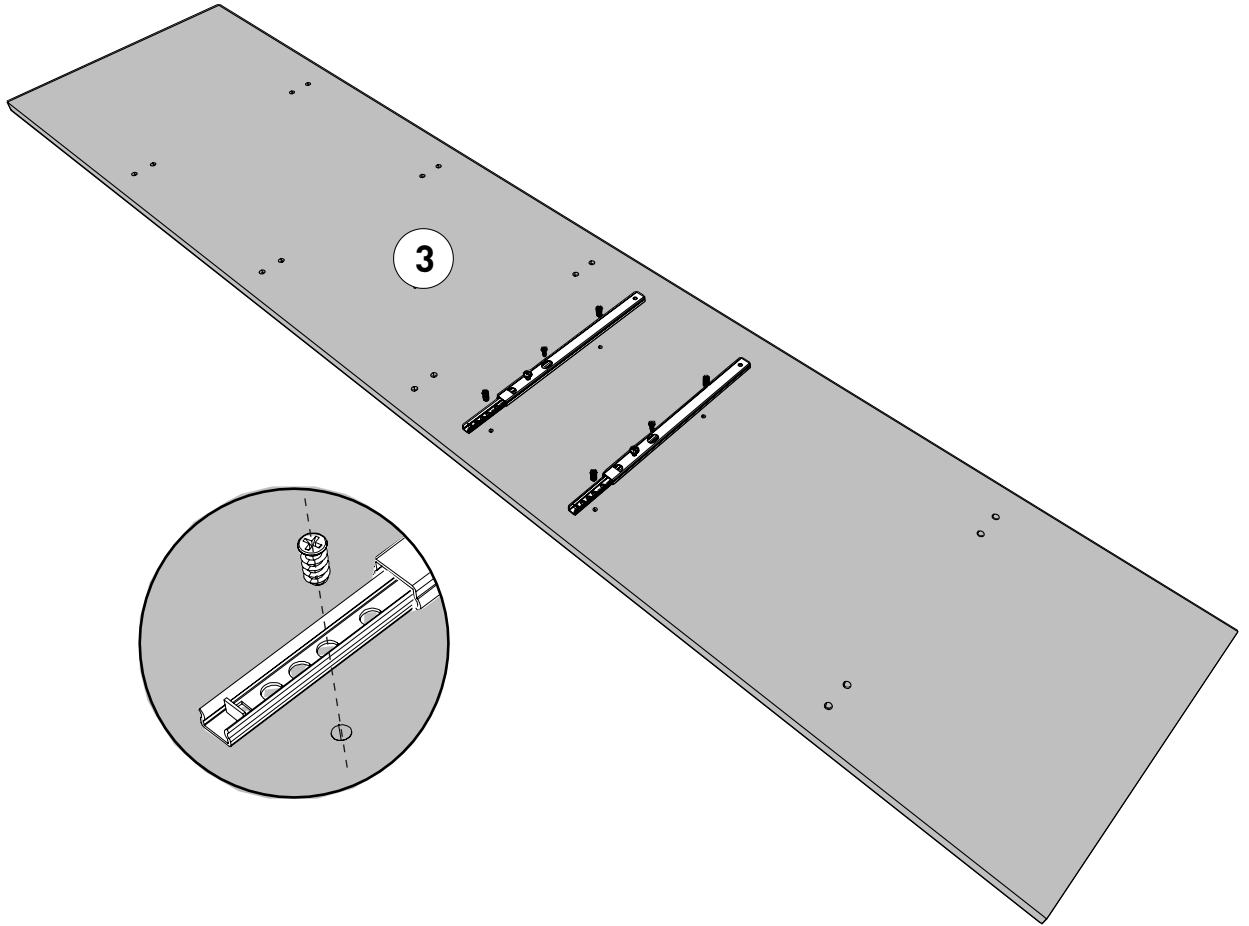
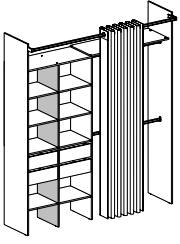
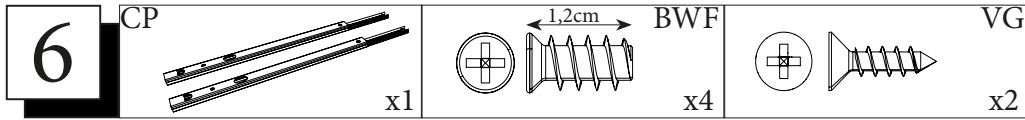

**Extérieur du meuble**

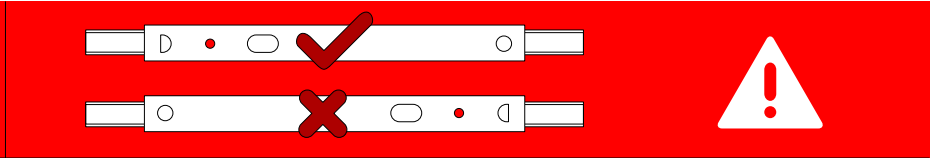

EN - Exterior of the furniture PL - Zewnętrzne elementy mebli  
 RO - Exteriorul mobilei ES - Exterior del mueble  
 PT - Exterior do móvel TR - Mobilyaların dışı

**1**

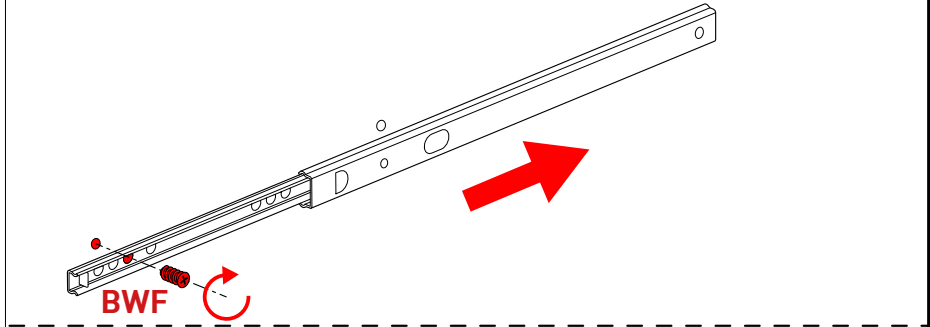

**2**

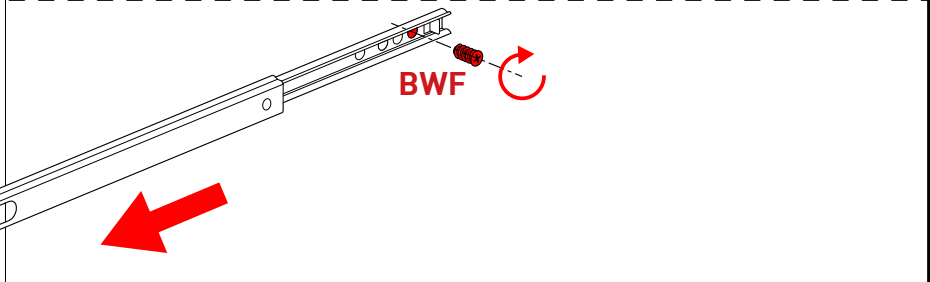

**3**

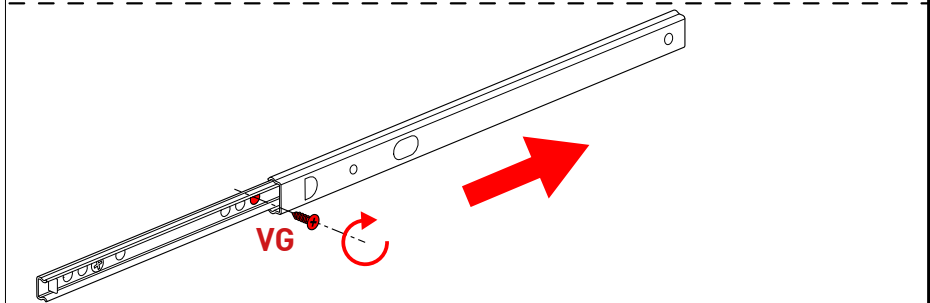

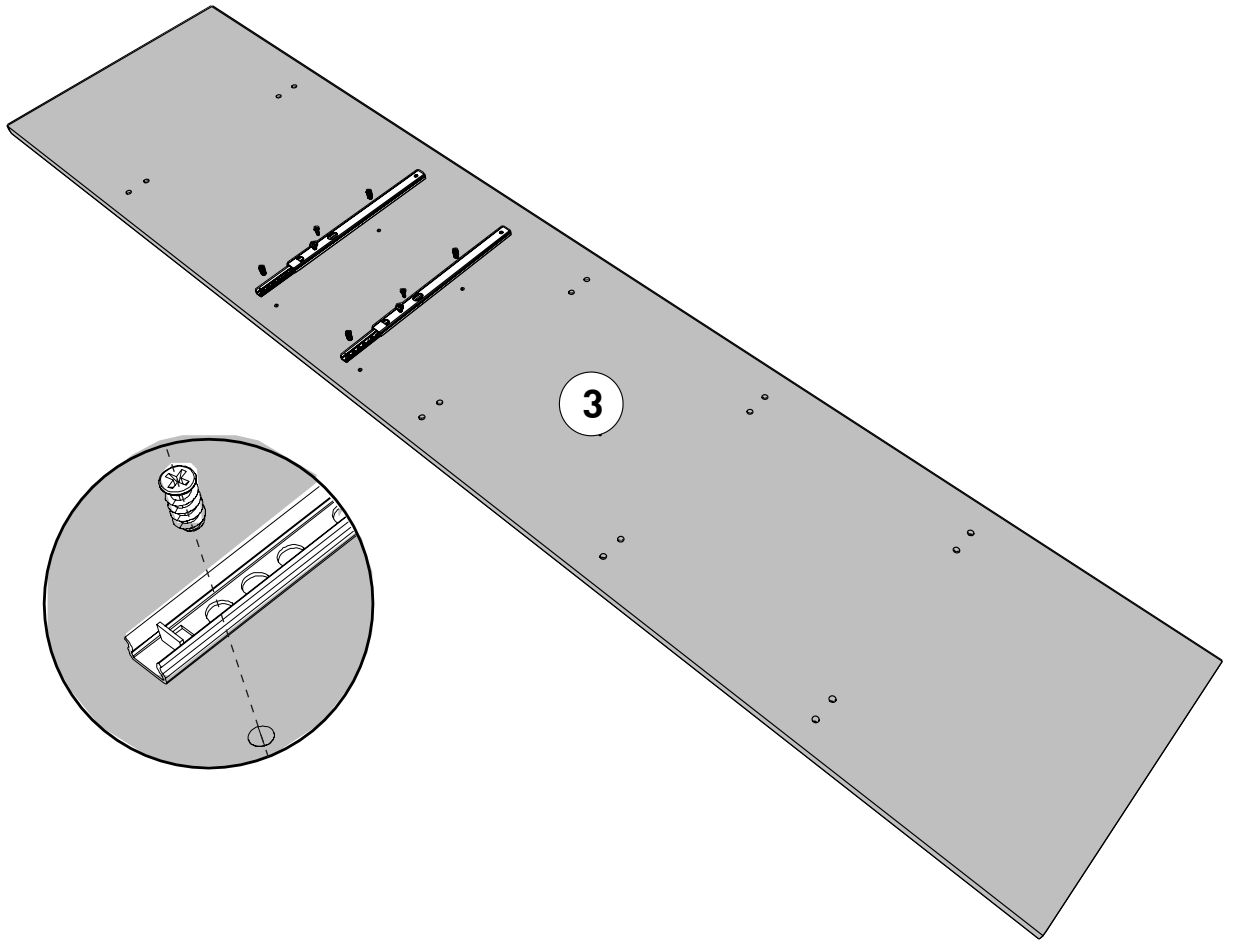
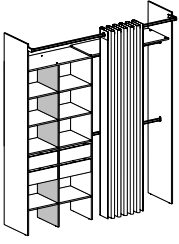
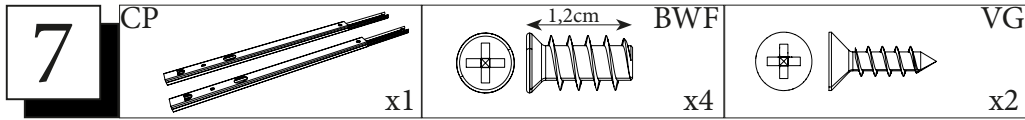

**Extérieur du meuble**

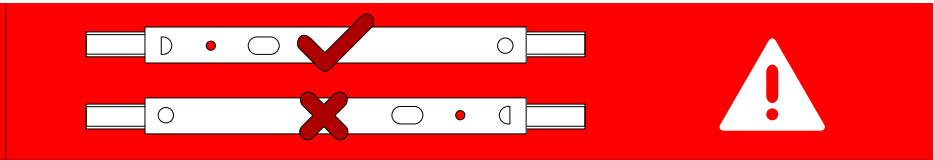

EN - Exterior of the furniture PL - Zewnętrzne elementy mebli  
 RO - Exteriorul mobilei ES - Exterior del mueble  
 PT - Exterior do móvel TR - Mobilyaların dışı

**1**

---

**2**

---

**3**

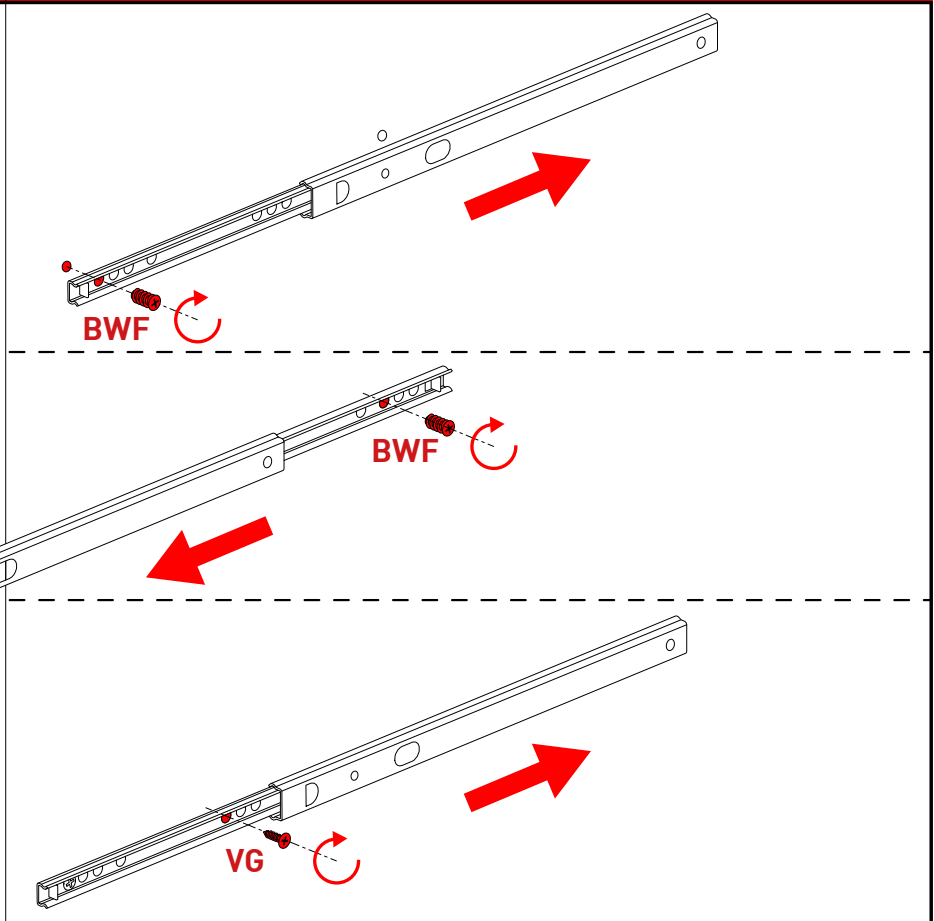

8

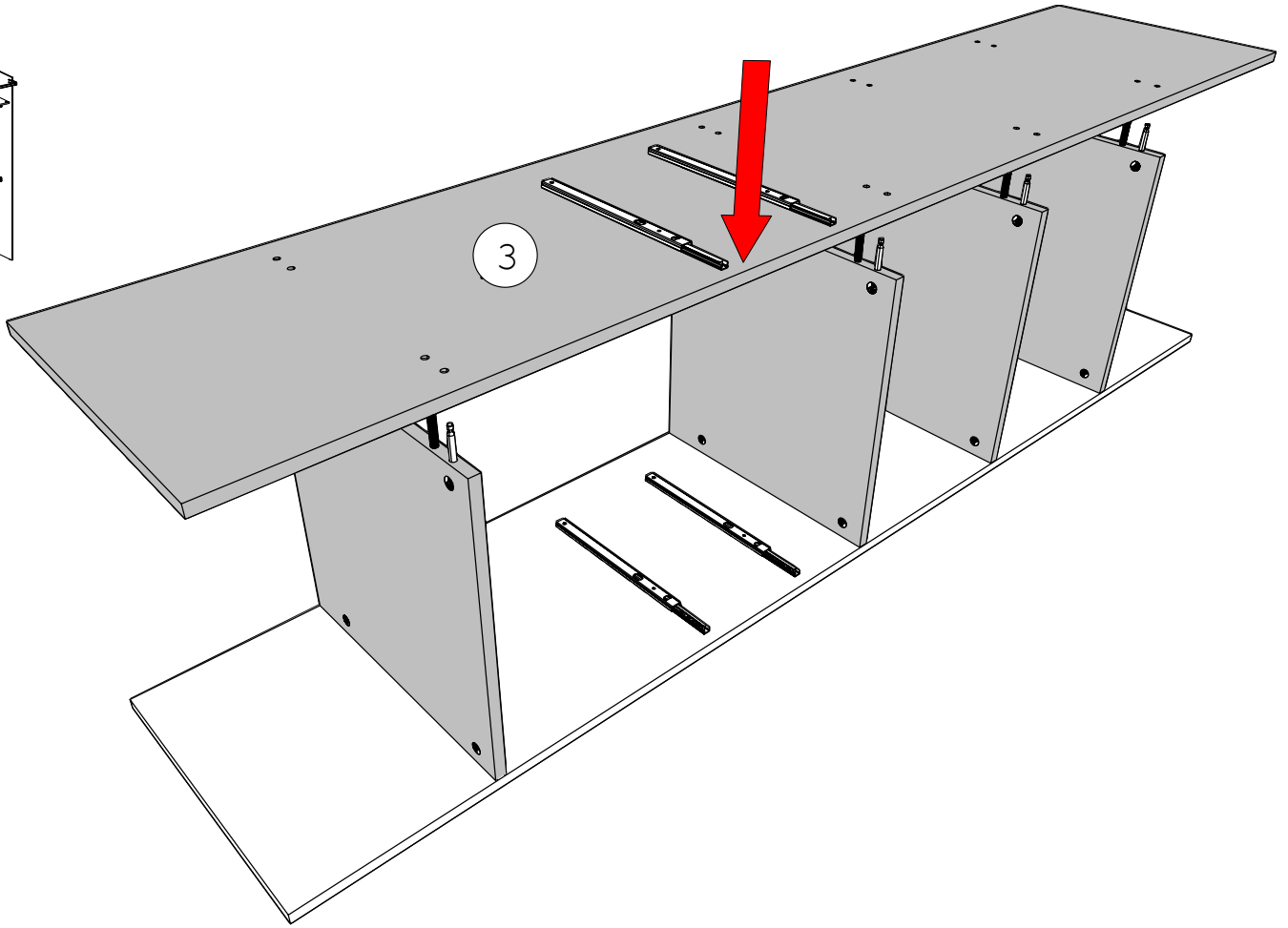
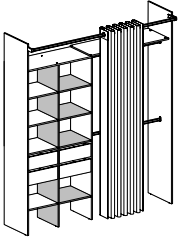

9

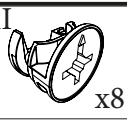

x8

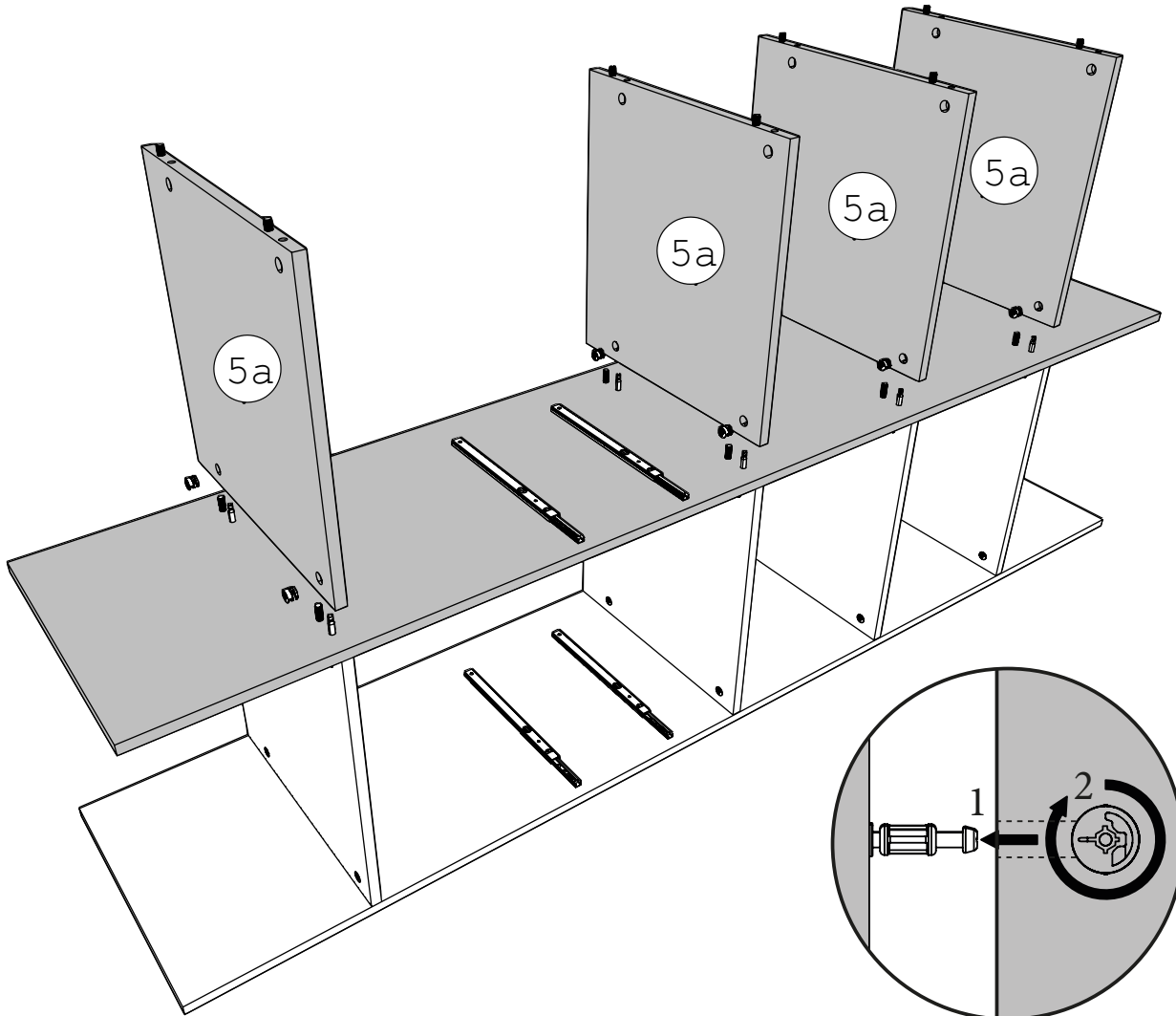
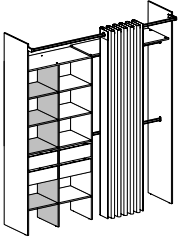

10

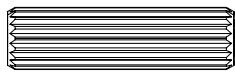

ADM

x2

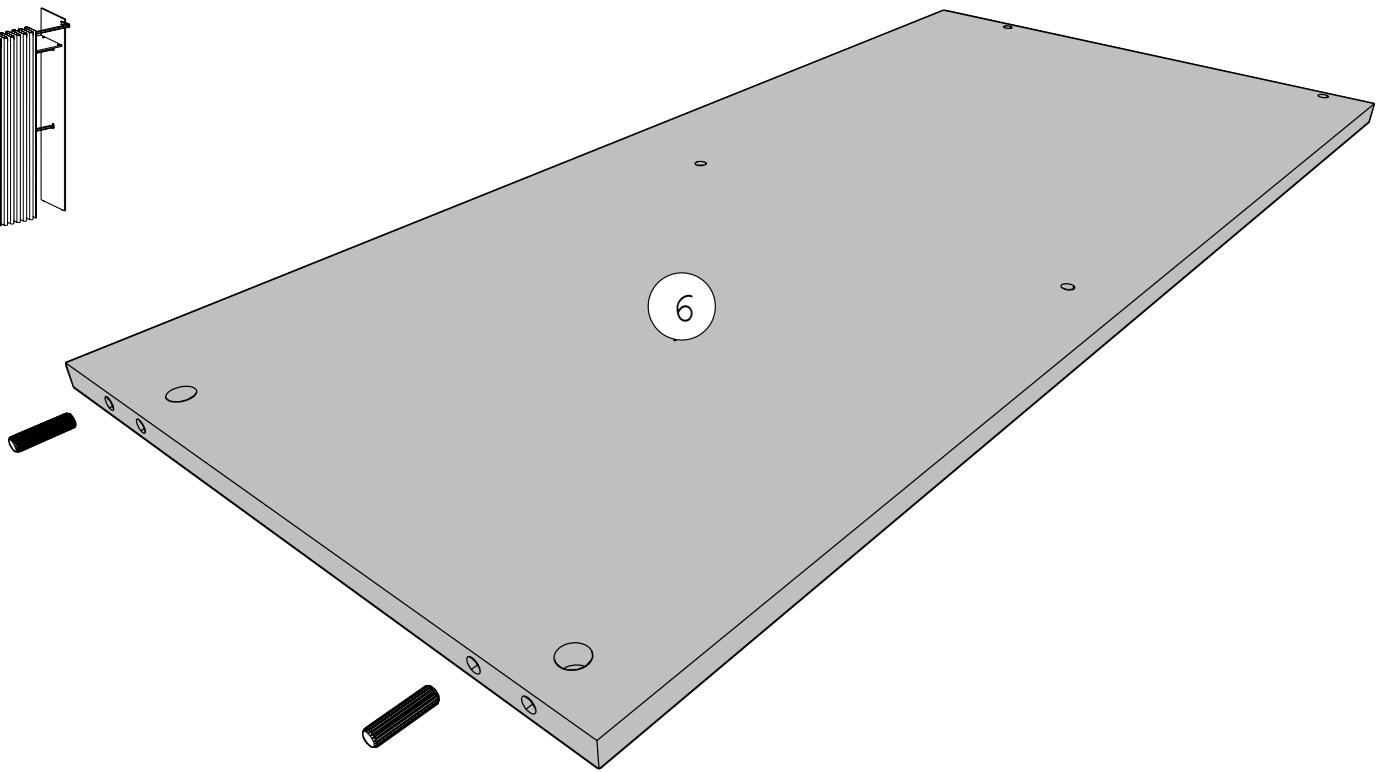
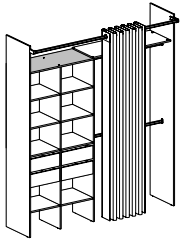

11

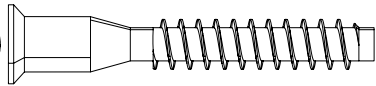

HWHV

x4

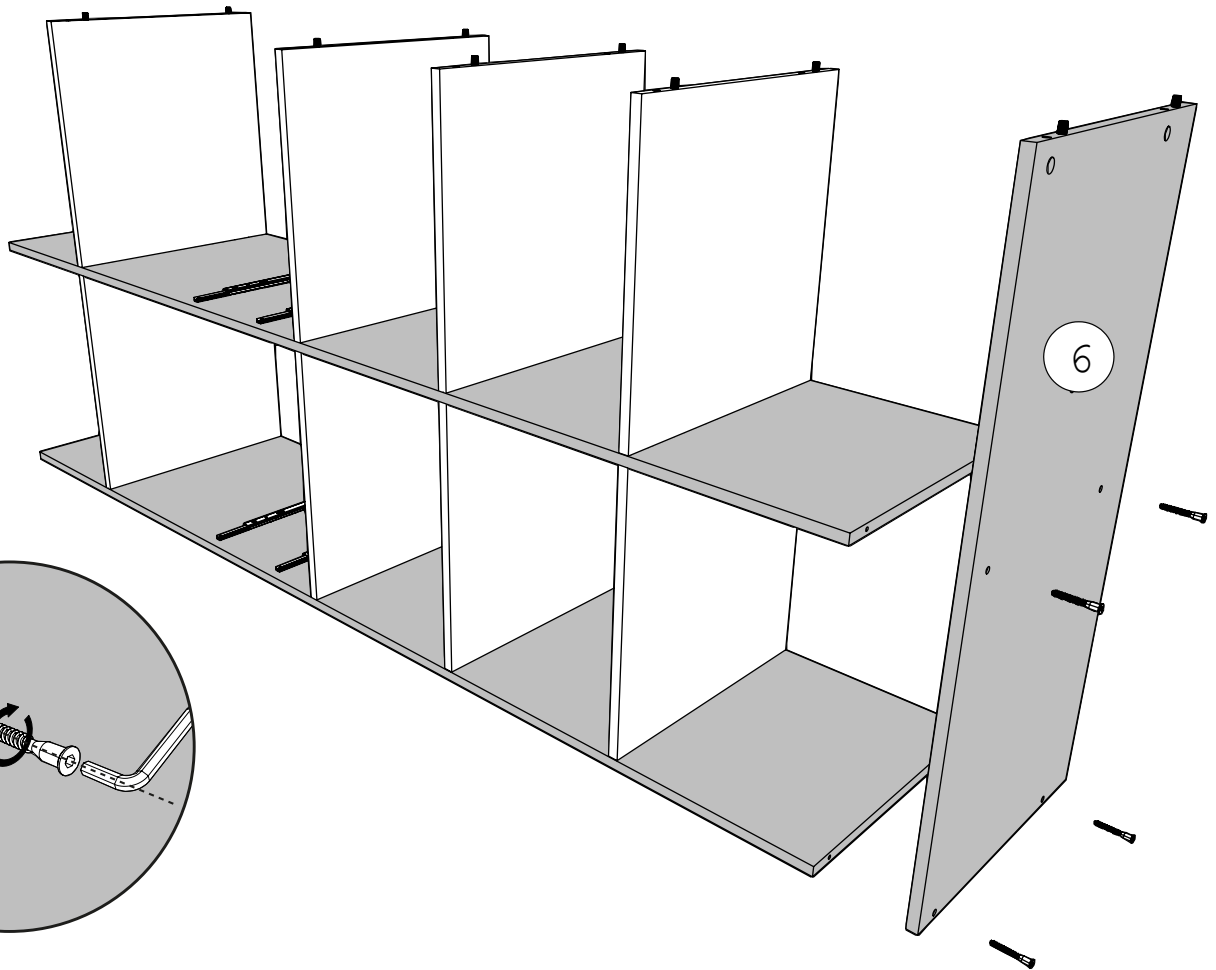
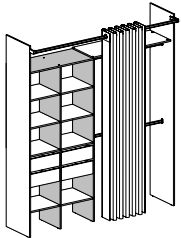
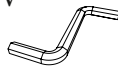

12

CP

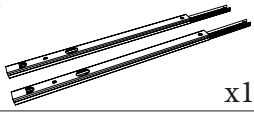

x1

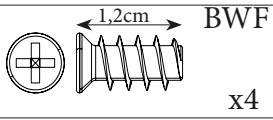

x4

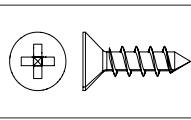

x2

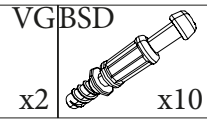

x10

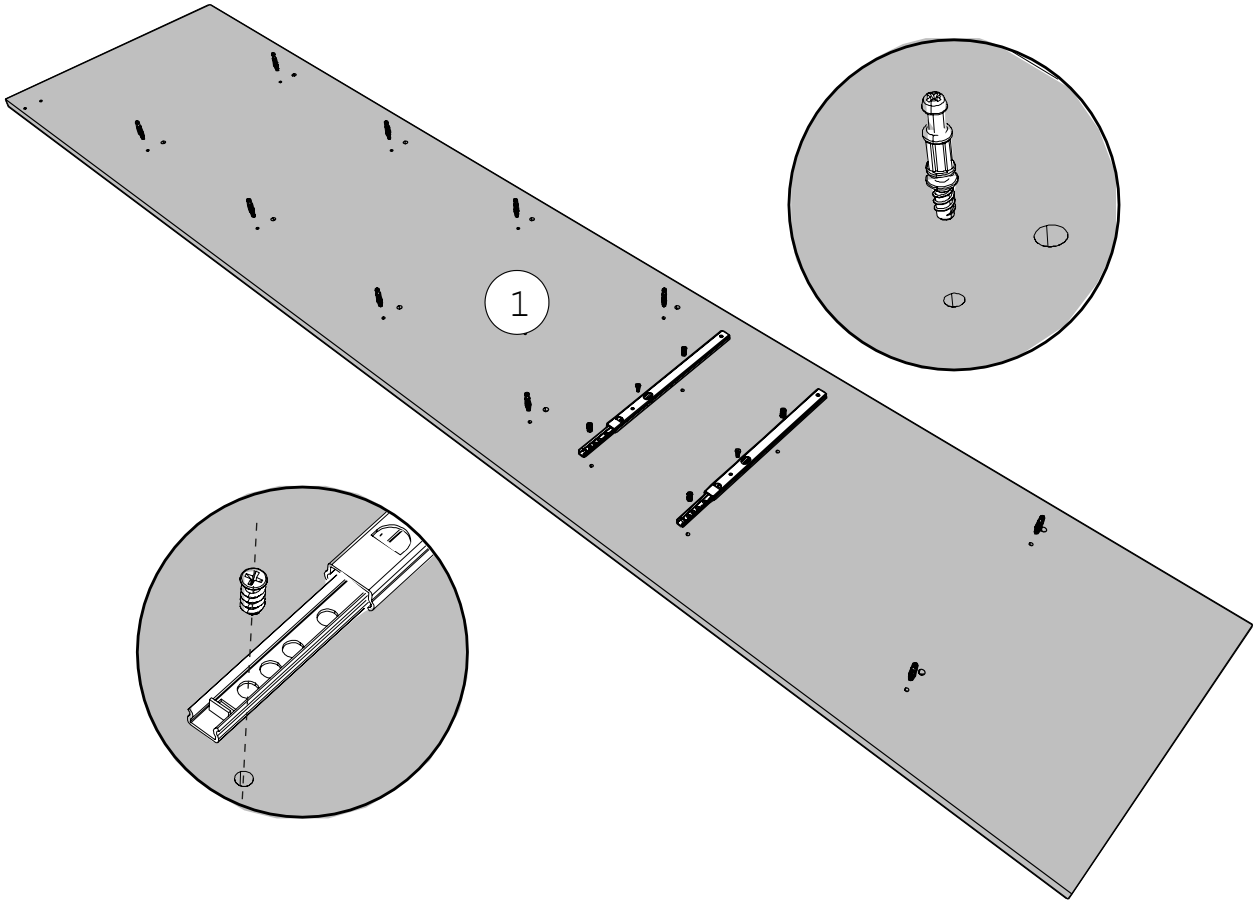
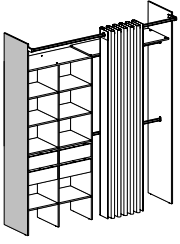

### Extérieur du meuble

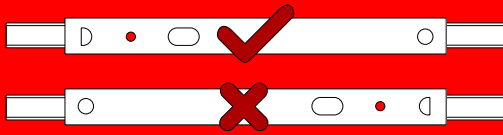

EN- Exterior of the furniture PL- Zewnętrzne elementy mebli  
RO- Exteriorul mobilei ES- Exterior del mueble  
PT- Exterior do móveis TR- Mobilyaların dışı

1

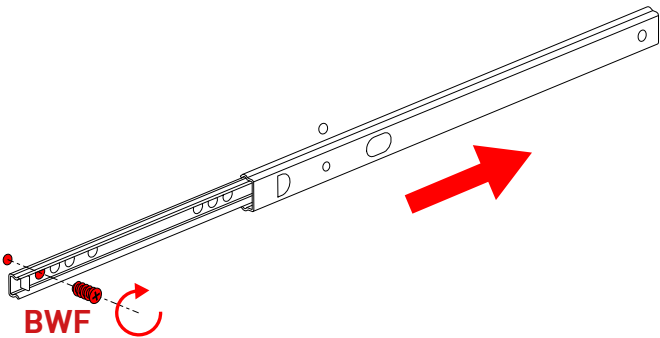

2

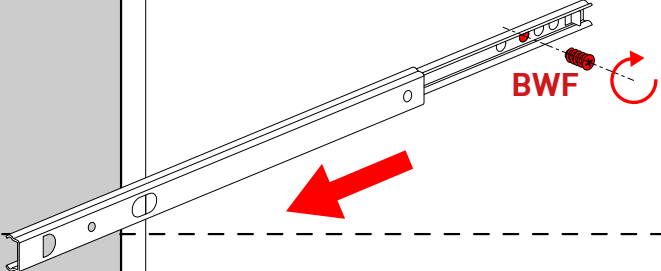

3

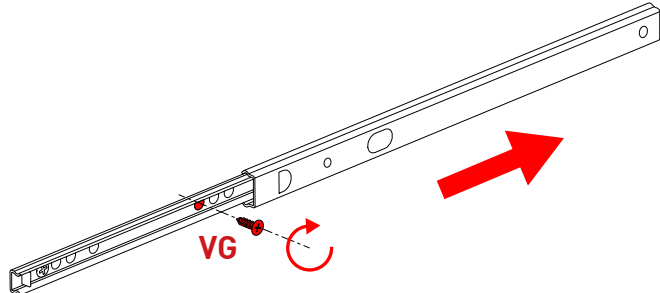

# 13 AI



x10

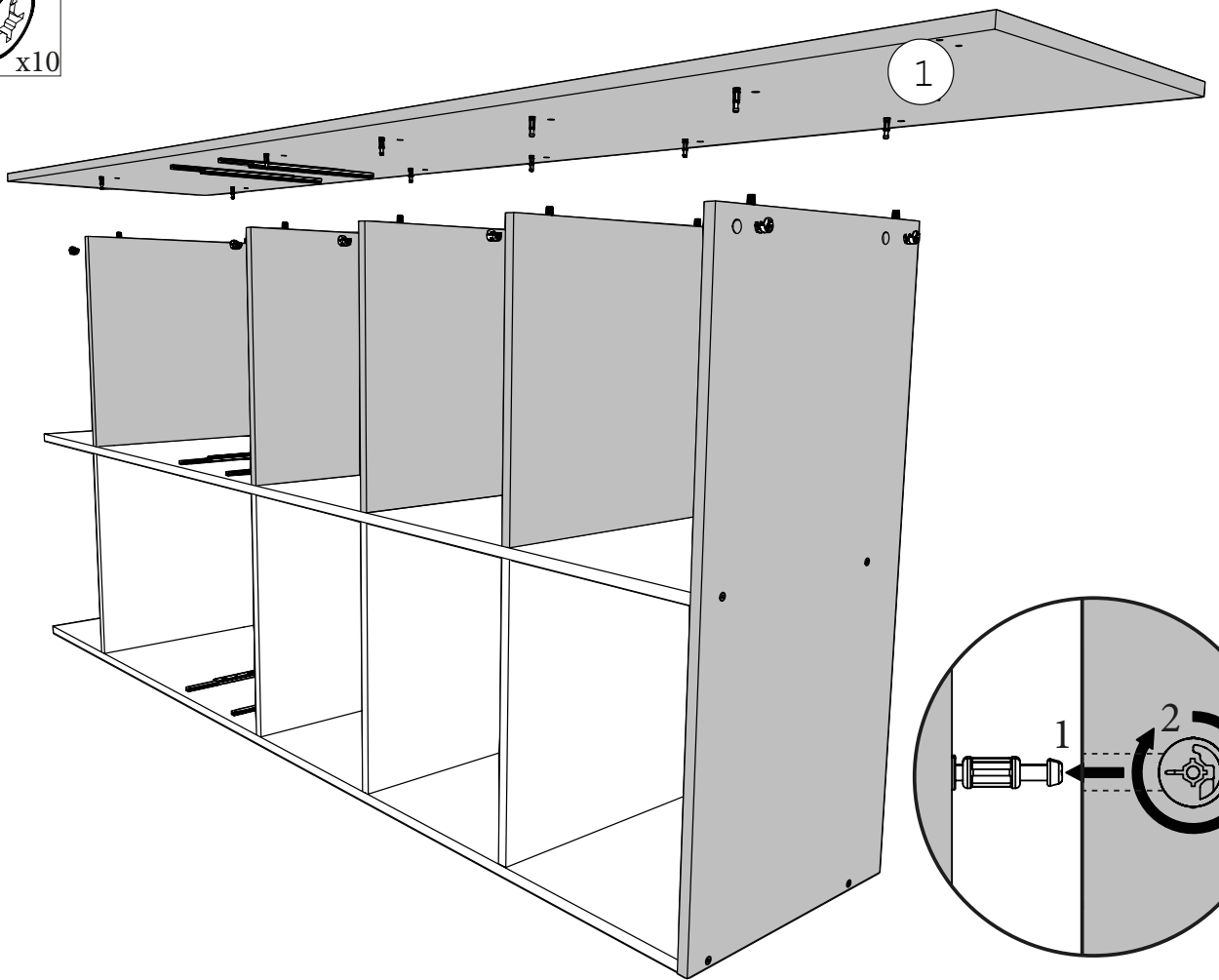
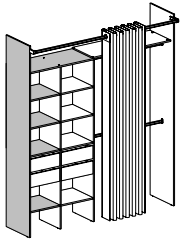

# 14 PA



x30

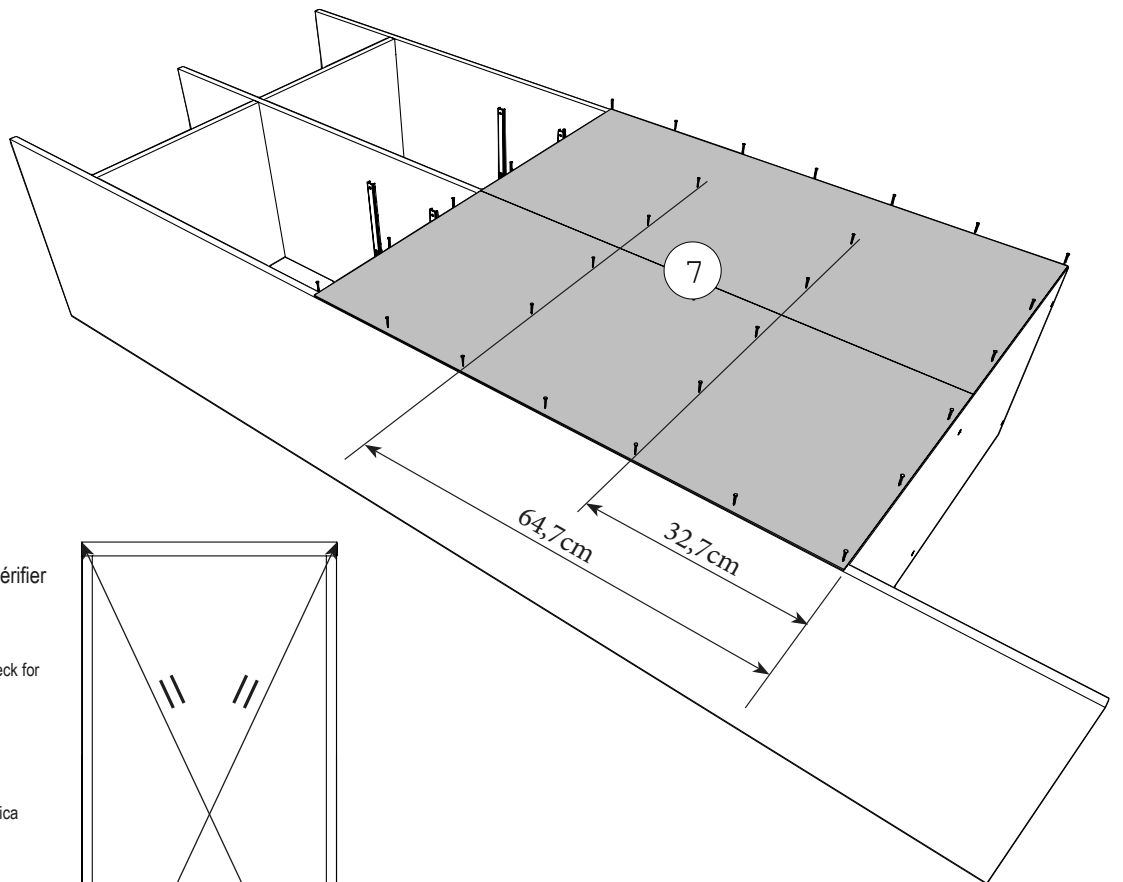
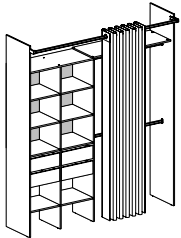

FR- Mesurer les diagonales du meuble pour vérifier l'équerrage.  
La mesure doit être identique.

EN- Measure the diagonals of the piece of furniture to check for straightening.  
The measurement must be identical.

PL- Zmierz przekątne mebel, aby sprawdzić prostowanie.  
Pomiar musi być identyczny.

RO- Măsurăți diagonalele piesei de mobilier pentru a verifica îndreptarea.  
Măsurătoarea trebuie să fie identică.

ES- Medir las diagonales del mueble para comprobar la escuadra.  
La medición deberá ser idéntica.

PT- Medir as diagonais do móvel para verificar o esquadro.  
A medição deve ser idéntica.

TR- Doğrultma için kontrol etmek üzere mobilya parçasının çaprazlarını ölçün.  
Ölçüm aynı olmalıdır.

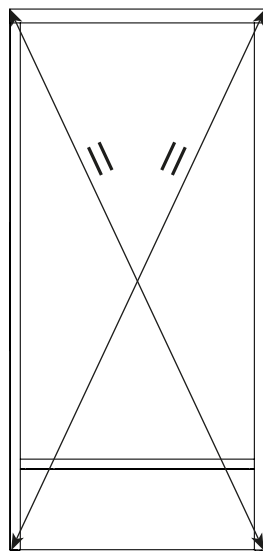

15 XA x3 VG x6

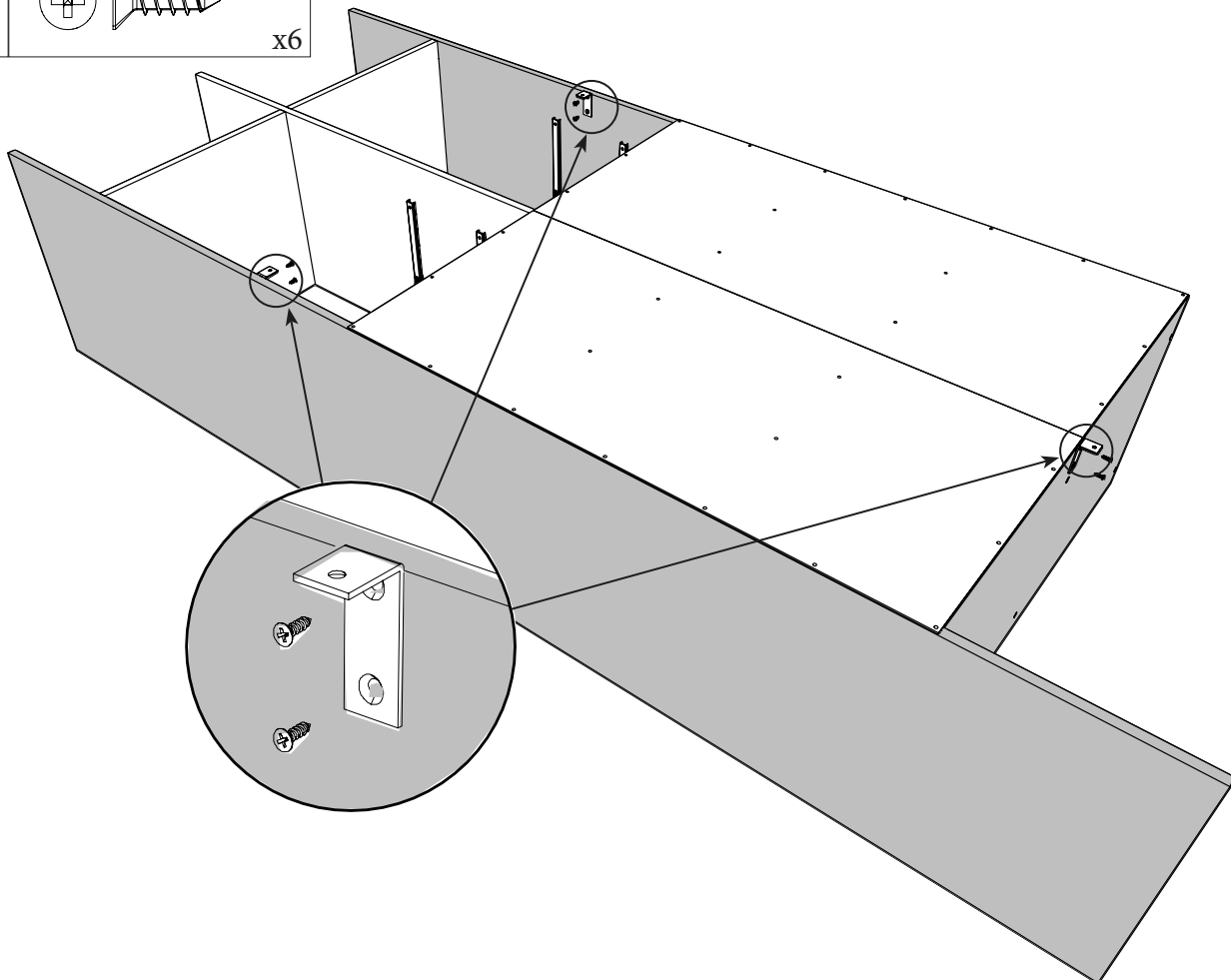
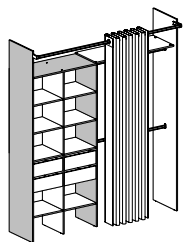

16 BQS x6

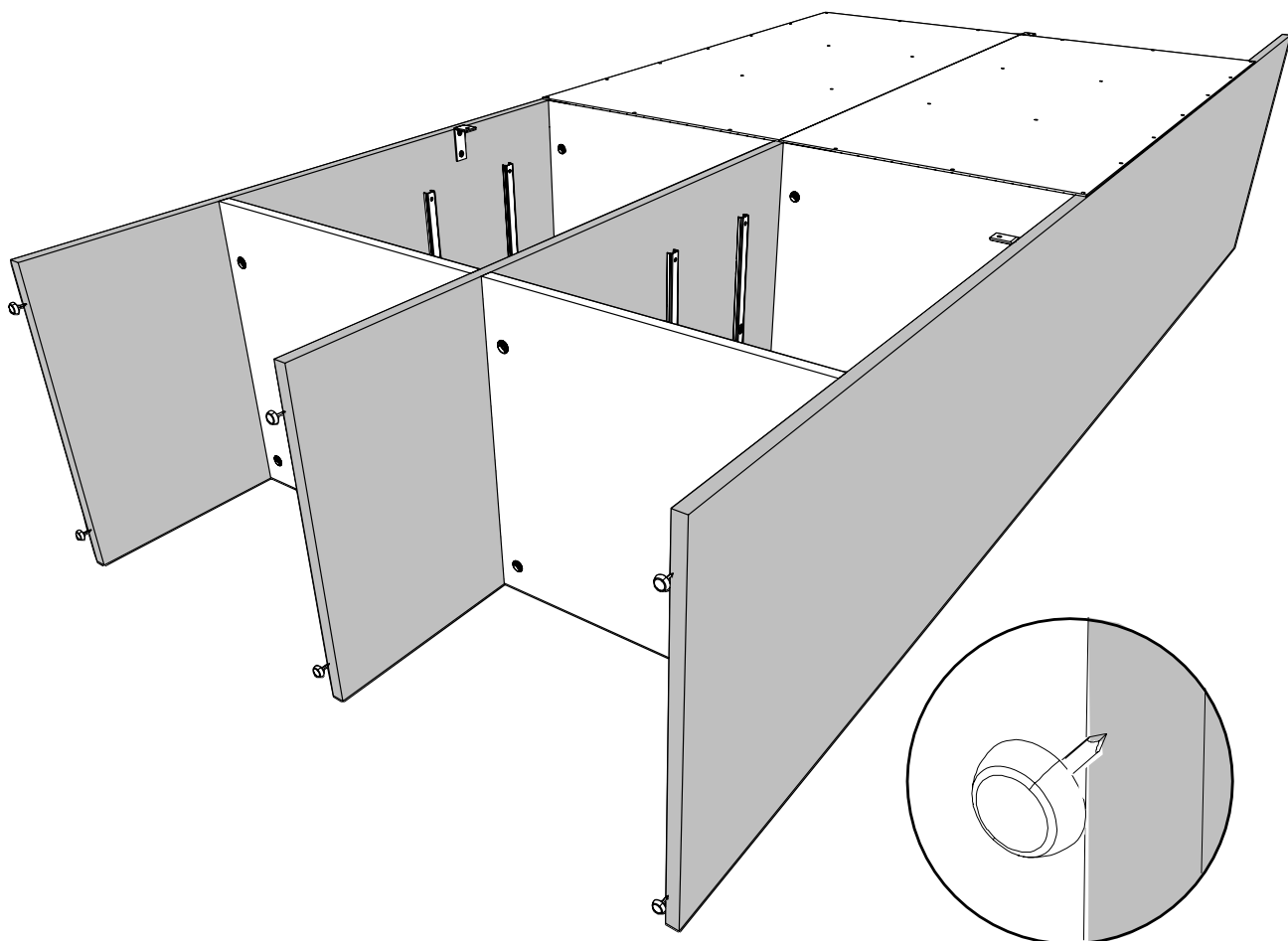
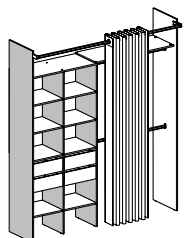

17

BSD

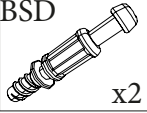

x2

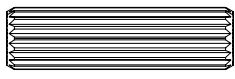

ADM

x2

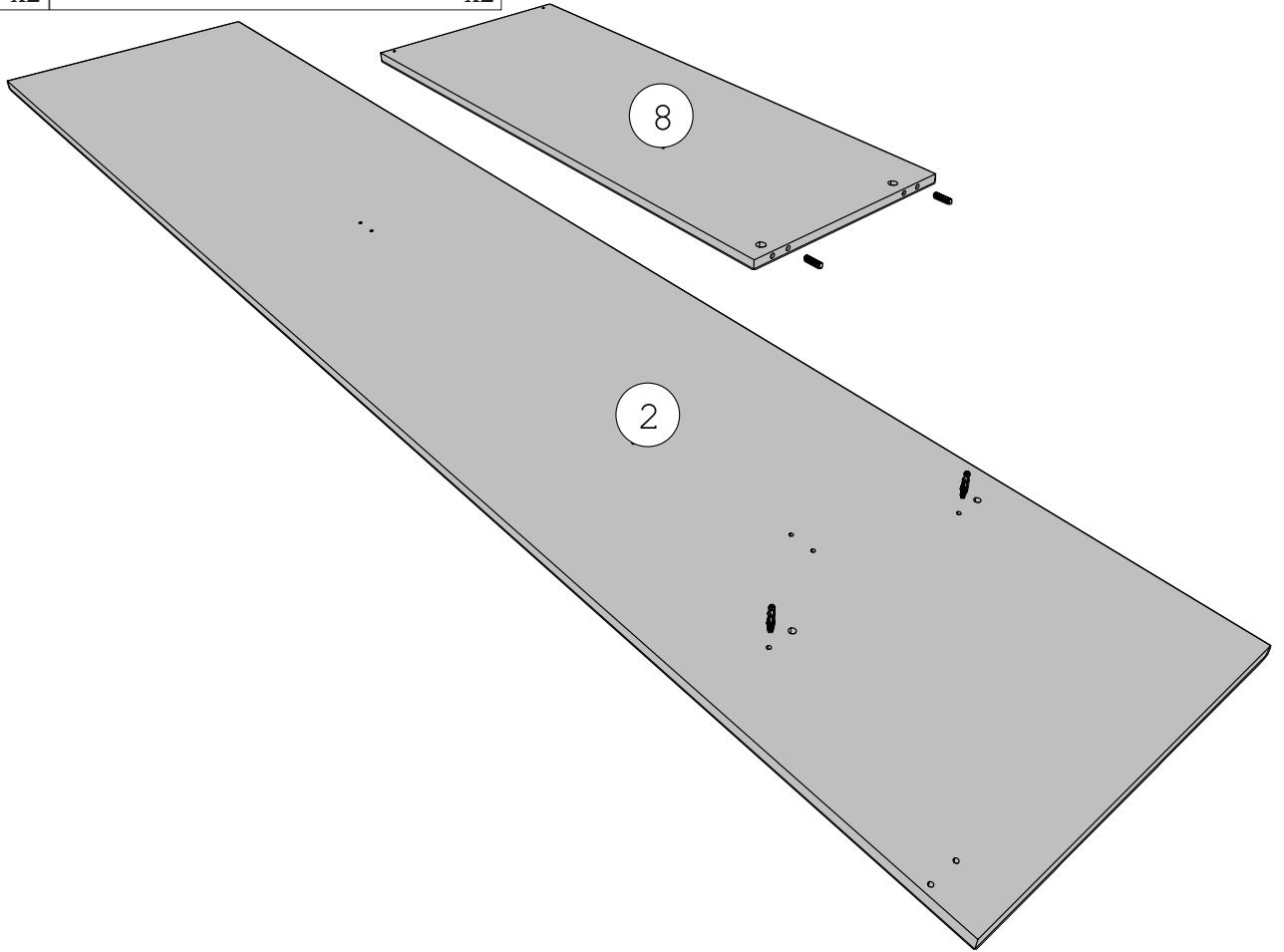
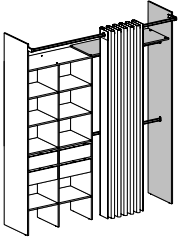

18

AI



x2

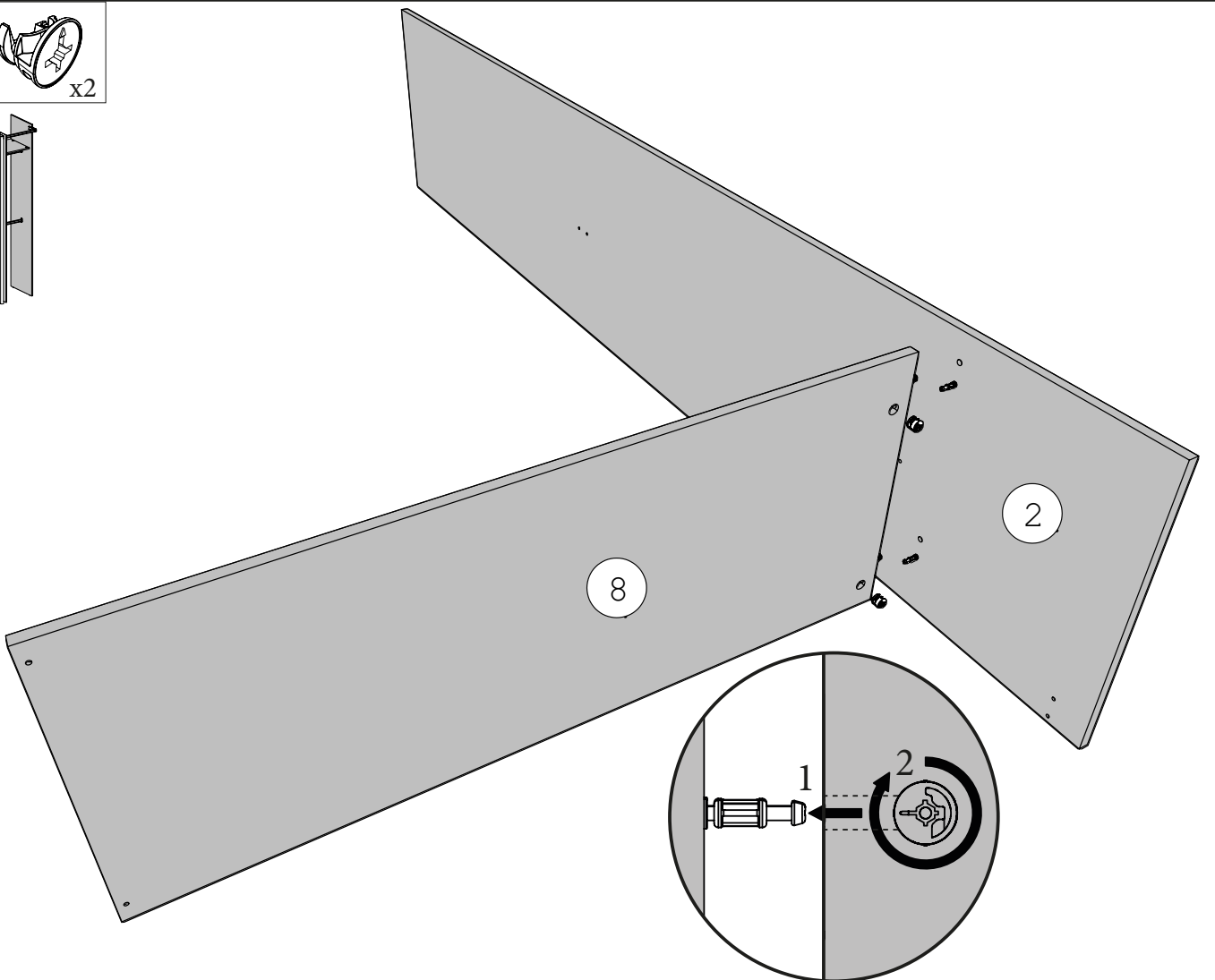
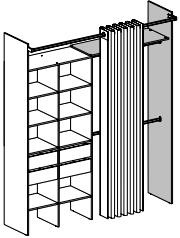

19

BQS

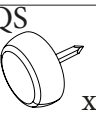

x2

XA

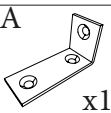

x1

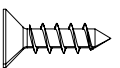

VG

x2

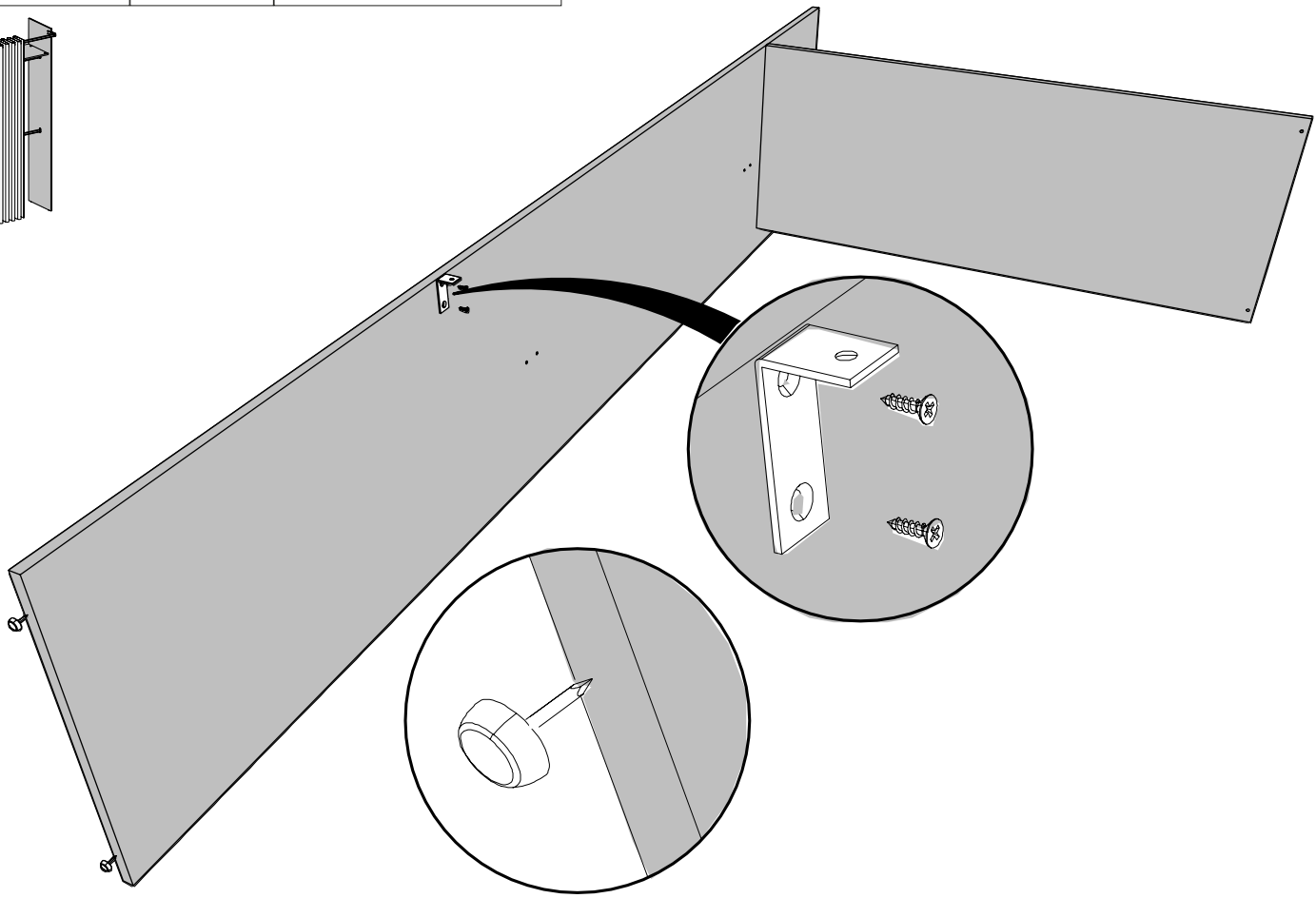
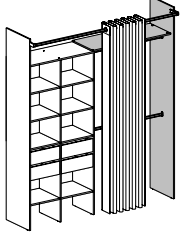

20

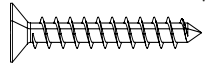

VAF10

x2

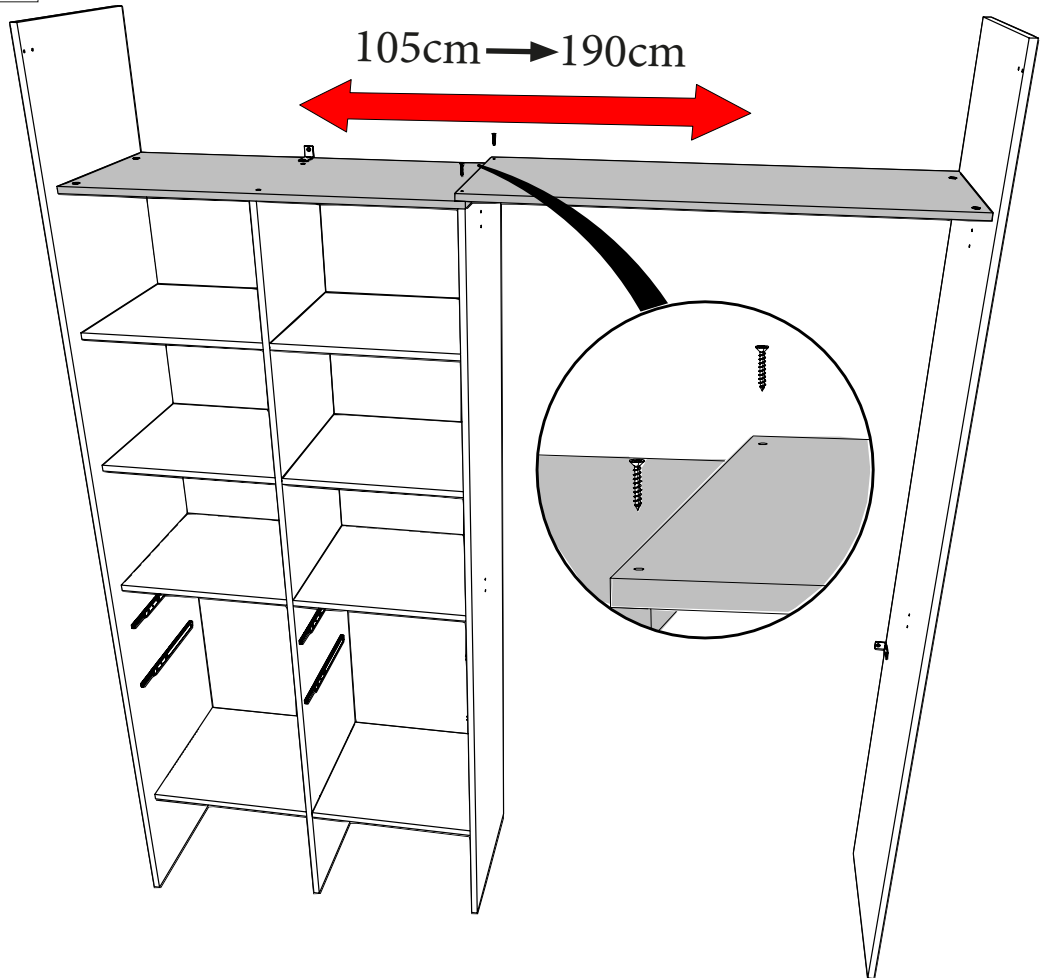
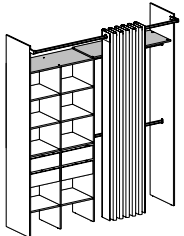

21

XA

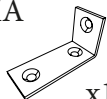

x1



VG

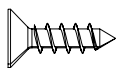

x2

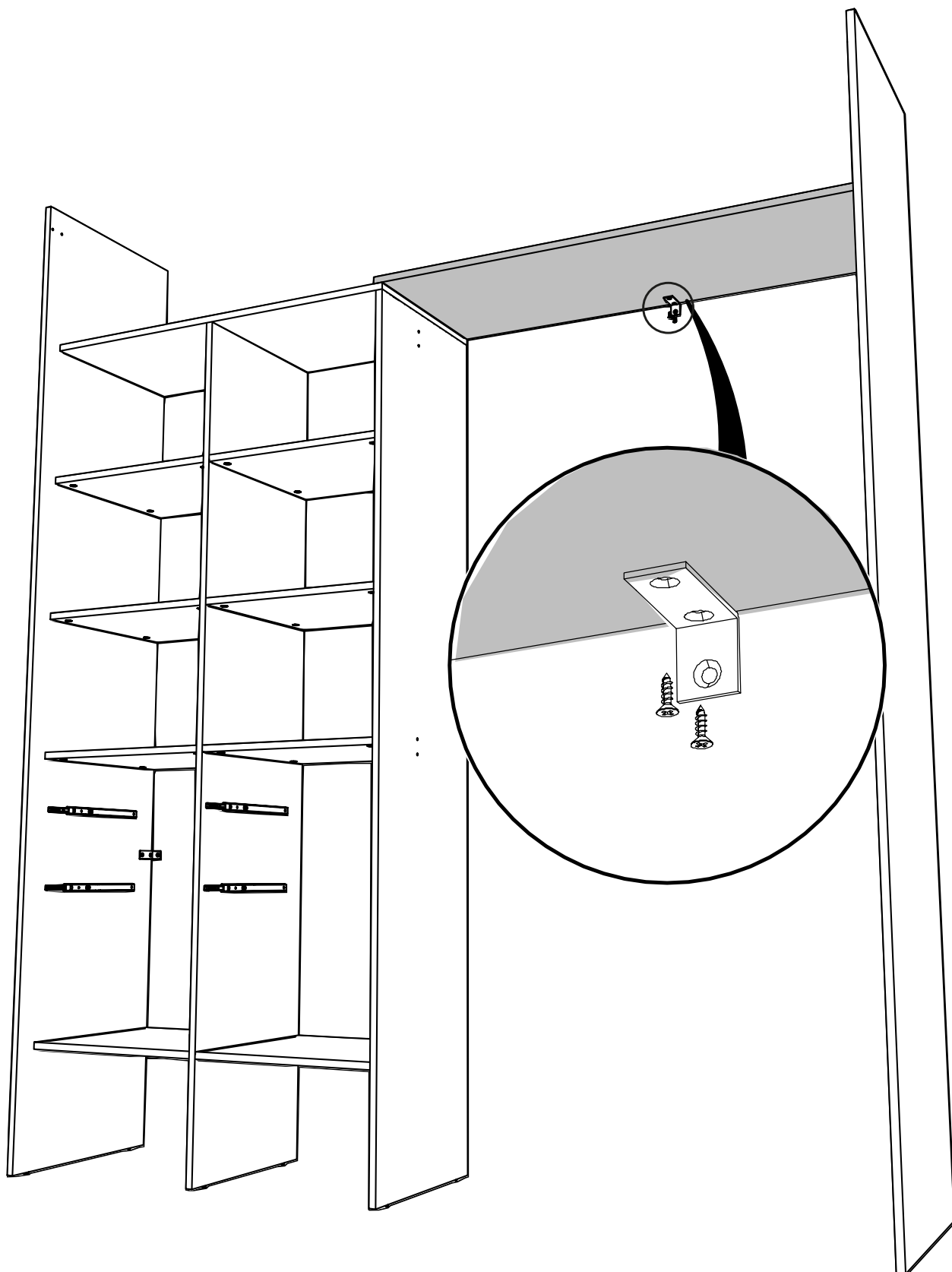
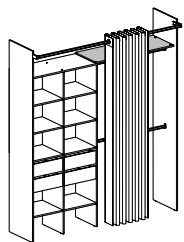

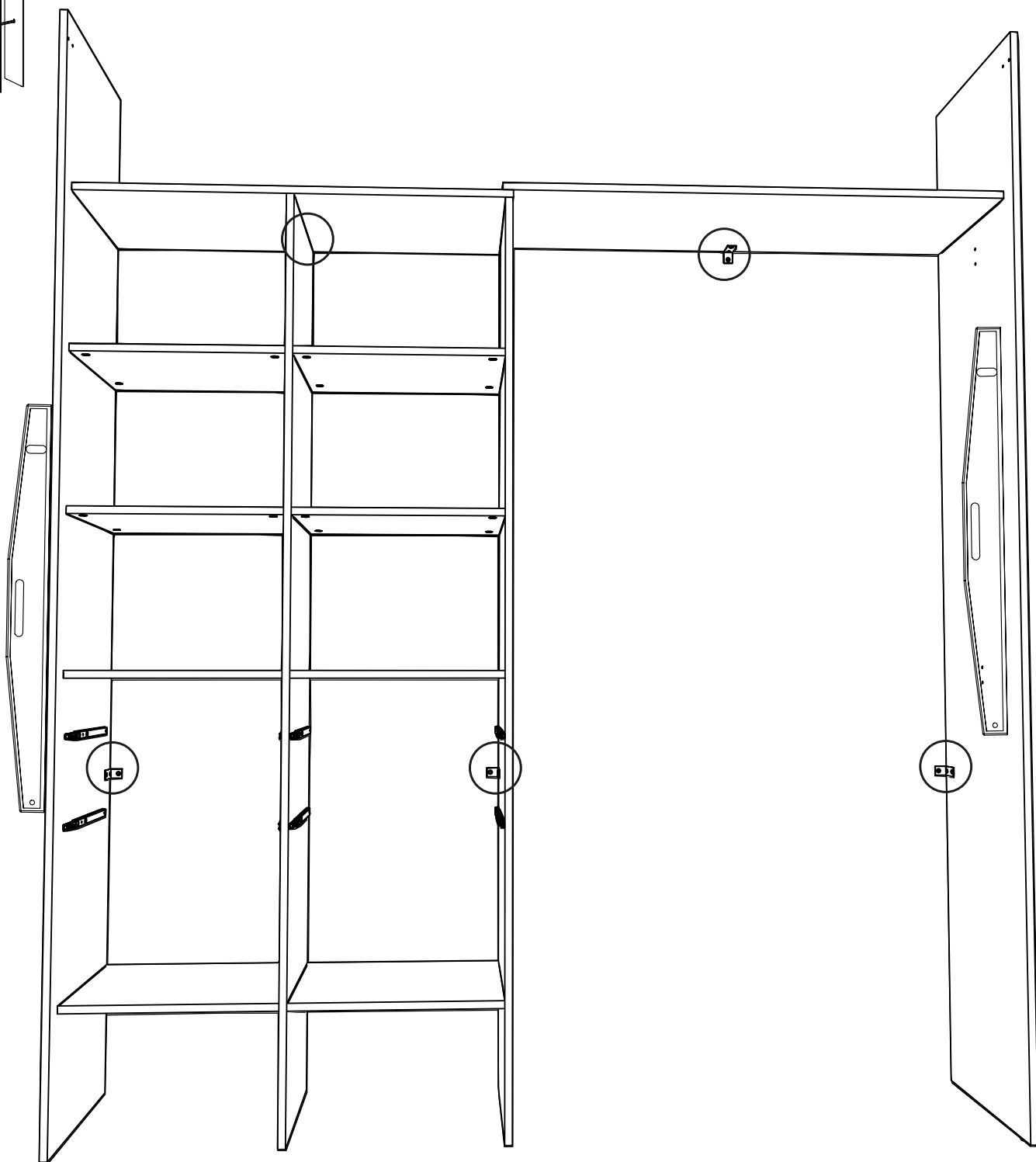
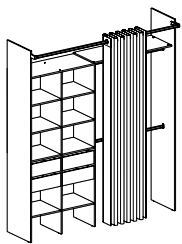

**EN****WARNING:**

to prevent the risk of tipping, this product must be used with suitable fasteners.

**Caution:**

the screws and wall anchors are not supplied because they depend on the type of wall the unit will be affixed to. Seek advice from an instore salesperson.

Failure to follow these instructions could result in bodily injury and damage to the product and property.

**PL****OSTRZEŻENIE:**

Aby uniknąć przechylenia produktu, musi on być używany z odpowiednimi systemem mocującym.

**Uwaga:**

śruby i wsporniki mocujące nie znajdują się w zestawie, gdyż ich rodzaj zależy od rodzaju ściany, do której będzie przy-mocowany mebel. Poprosić sprzedawcę sklepie.

Nieprzestrzeganie tych instrukcji może spowodować obrażenia ciała oraz uszkodzenie produktu i mienia.

**ES****ADVERTENCIA:**

con el fin de impedir que vuelque, hay que usar este producto con los dispositivos de fijación adaptados.

**Atención:**

los tornillos y clavijas de fijación a la pared no se incluyen, ya que dependen del tipo de pared donde se va a fijar, Pida consejo a un vendedor de la tienda donde lo compre.

El hecho de no respetar estas instrucciones puede acarrear lesiones corporales y daños al producto u otros bienes.

**TR****UYARI:**

Ürün, devrilmemesi için uygun bağlantı elemanları ile birlikte kullanılmalıdır.

**Dikkat:**

duvar montajı için vida ve dübelleri ürüne dahil değildir, çünkü bu parçalar mobilyanın sabitleneceği duvar tipine bağlıdır. Mağaza satış görevlilerinden yardım isteyin.

Bu talimatlara uyulmaması kişisel yaralanmalara, ürün ve mal hasarına yol açabilir.

**FR****AVERTISSEMENT:**

afin d'empêcher le basculement, ce produit doit être utilisé avec les dispositifs de fixation adaptés.

**Attention:**

Les vis et chevilles de fixation murale ne sont pas fournies car elles dépendent du type de mur sur lequel le meuble est fixé. Demandez conseil à un vendeur en magasin.

Le non respect de ces instructions peut entraîner des blessures corporelles et l'endommagement du produit et des biens.

**RO****AVERTISMENT:**

Pentru a preveni răsturnarea, acest produs trebuie utilizat cu dispozitivele de fixare adaptate.

**Atenție:**

șuruburile și diblurile de prindere pe perete nu sunt incluse deoarece acestea depind de tipul de perete de care este fixat mobilierul. Solicitați sfatul unui vânzător din magazin.

Nerespectarea acestor instrucțiuni poate duce la vătămări corporale și deteriorarea produsului și proprietății.

**PT****AVISO:**

De modo a impedir a oscilação, este produto deve ser utilizado com os dispositivos de fixação adaptados.

**Atenção:**

Os parafusos e cavilhas de fixação na parede não são fornecidos, pois dependem do tipo de parede onde vai fixar o móvel. Aconselhe-se com um vendedor na loja.

O desrespeito por estas instruções pode dar origem a lesões corporais e a danos no produto e nos seus bens.

**23** GZ x4 VG x4

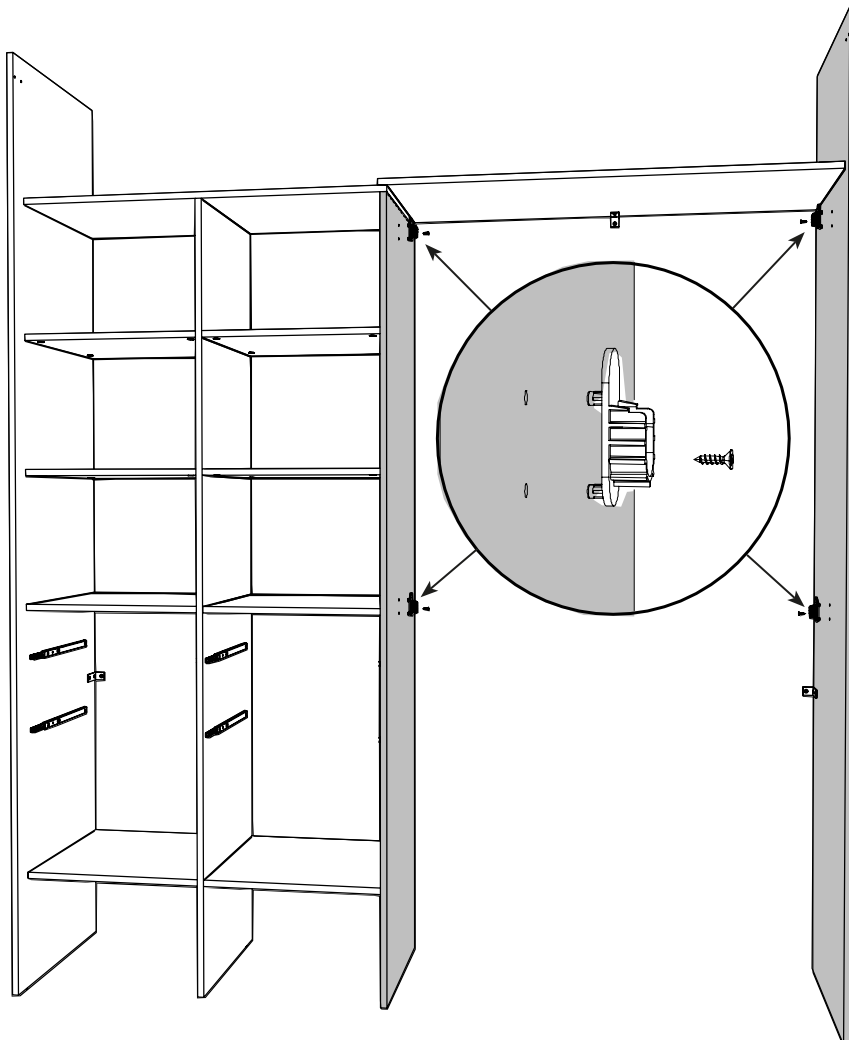
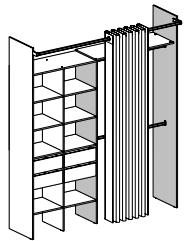

**24** DC 99,3cm x2

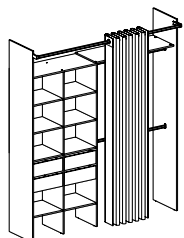

$X = Y - 0,7\text{cm}$

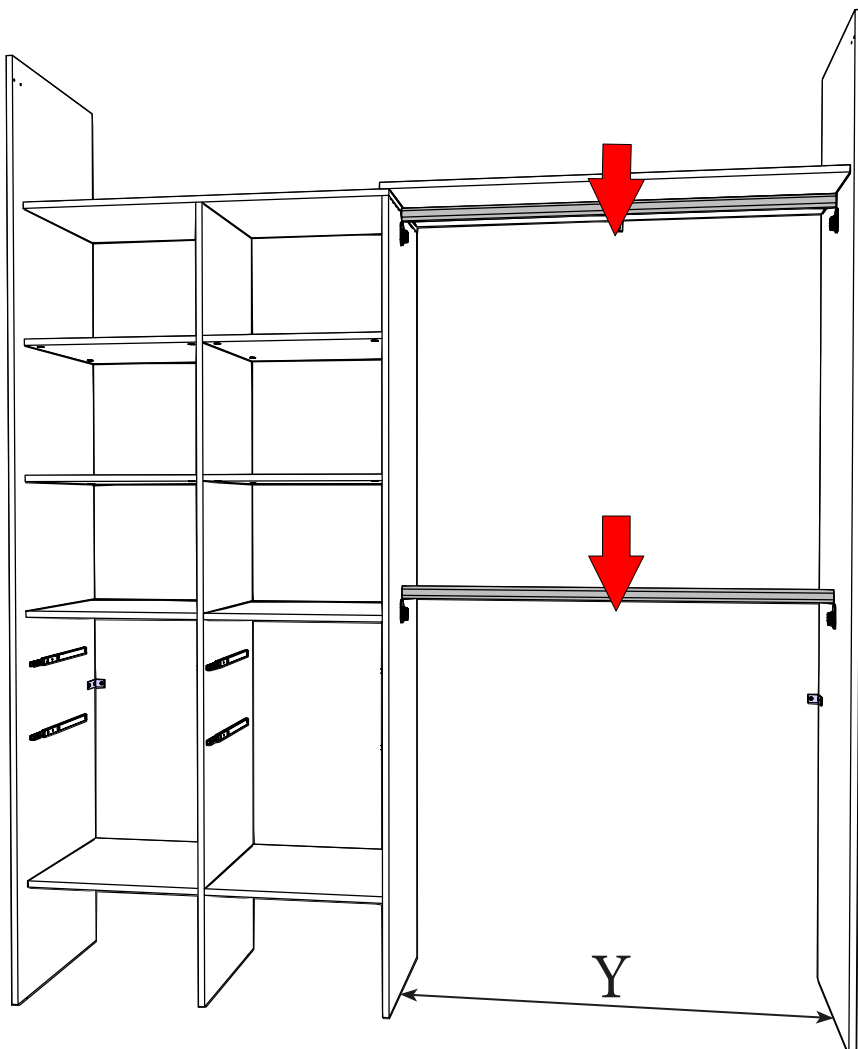
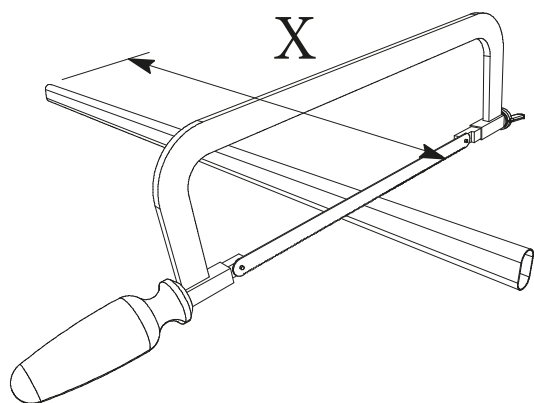

25 VR  
x8

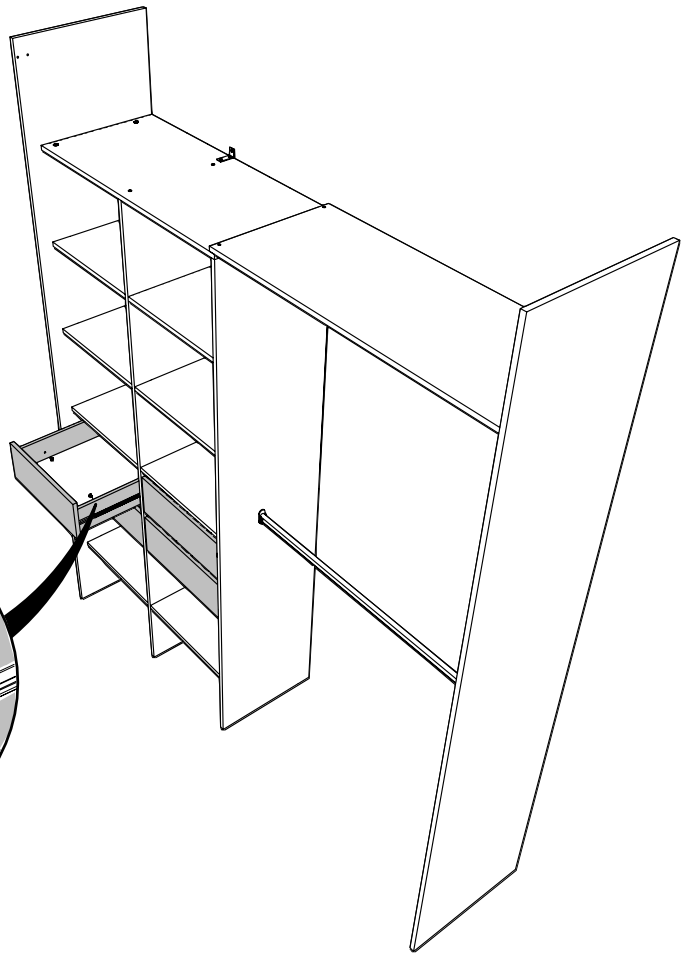
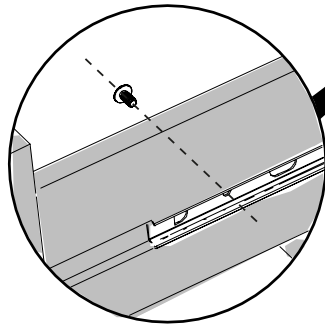
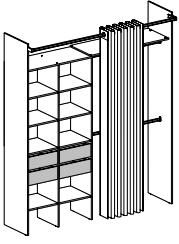

26 DC DG FO  
187,4cm x1 x2 x4  
CIL x1

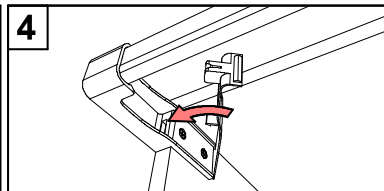
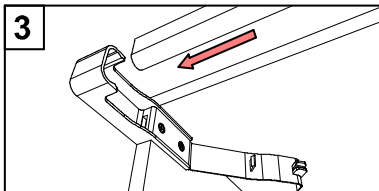
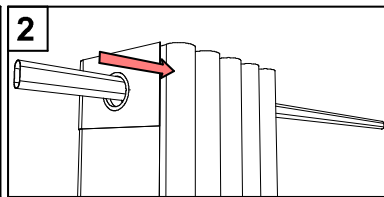
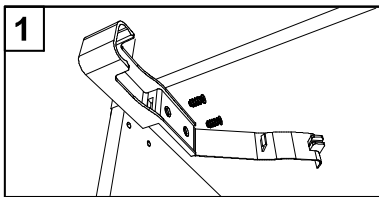
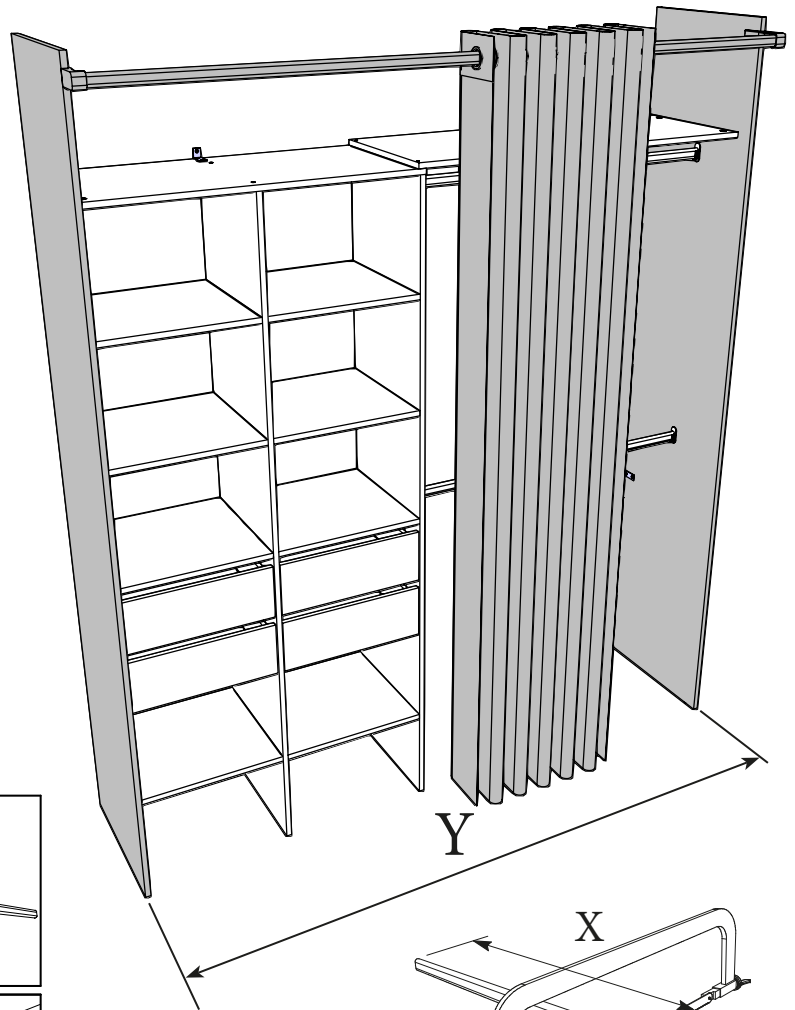
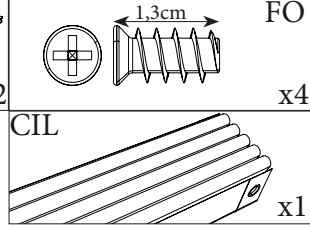
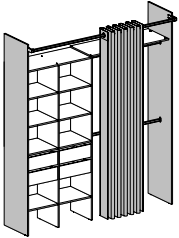

$$X = Y - 2,6\text{cm}$$

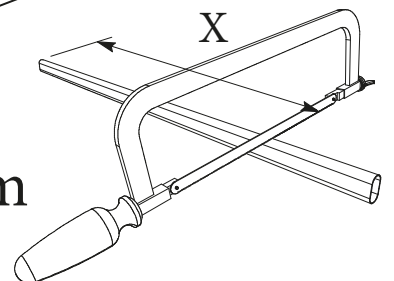





# Manufacturer • Fabricant • Producent • Producător:

**UK**

**Manufacturer:**

Kingfisher International Products Limited,  
3 Sheldon Square, London, W2 6PX,  
United Kingdom  
[www.kingfisher.com/products](http://www.kingfisher.com/products)

**EN**

**Distributor:**

B&Q Limited, Chandlers Ford, Hants, SO53 3LE  
United Kingdom  
[www.diy.com](http://www.diy.com)

Screwfix Direct Limited, Trade House,  
Mead Avenue, Yeovil, BA22 8RT,  
United Kingdom  
[www.screwfix.com](http://www.screwfix.com)

To view instruction manuals online, visit  
[www.kingfisher.com/products](http://www.kingfisher.com/products)

**Customer Service:**

0333 014 3098 (General Enquiries)  
[bandqcustomerservices@b-and-q.co.uk](mailto:bandqcustomerservices@b-and-q.co.uk)  
(General Enquiries)  
0333 014 3357 (Home Delivery only)  
[home.delivery@b-and-q.co.uk](mailto:home.delivery@b-and-q.co.uk) (Home Delivery only)

**Customer Service:**

0333 011 2112  
[online@screwfix.com](mailto:online@screwfix.com)

**PL**

**Dystrybutor:**

Castorama Polska Sp. z o.o. ul.  
Krakowiaków 78, 02-255 Warszawa  
[www.castorama.pl](http://www.castorama.pl)

Aby zapoznać się z instrukcją obsługi online,  
odwiedź stronę  
[www.kingfisher.com/products](http://www.kingfisher.com/products)  
Aby skontaktować się z działem obsługi klienta,  
należy udać się do sklepu

**EU**

**Manufacturer:**

Kingfisher International Products B.V.,  
Rapenburgerstraat 175E, 1011 VM Amsterdam,  
The Netherlands

**FR**

**Distributeur:**

Castorama France C.S. 50101 Templemars 59637  
Wattignies CEDEX  
[www.castorama.fr](http://www.castorama.fr)

**Service client :**

09 74 75 01 74 (prix d'un appel local)  
[www.castorama.fr/services/contactez-nous/](http://www.castorama.fr/services/contactez-nous/)

BRICO DÉPÔT 30-32 rue de la Tourelle  
91310 Longpont-sur-Orge France  
[www.bricodepot.com](http://www.bricodepot.com)

**Service client :**

[contact@contact.bricodepot.com](mailto:contact@contact.bricodepot.com)  
09.74.48.17.96 (achats en ligne uniquement)  
Pour consulter les manuels d'instructions en ligne,  
rendez-vous sur le site  
[www.kingfisher.com/products](http://www.kingfisher.com/products)

**RO**

**Distribuitor:**

SC Bricostore România SA  
Calea Giulești 1-3, Sector 6,  
București , România  
[www.bricodepot.ro](http://www.bricodepot.ro)

Pentru a consulta manualele de instrucțiuni online,  
vizitați  
[www.kingfisher.com/products](http://www.kingfisher.com/products)  
Pentru Serviciul de asistență clienți, reveniți în  
magazin