

# INSTALLATION GUIDE | GUIDE D'INSTALLATION

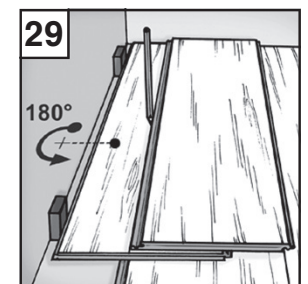

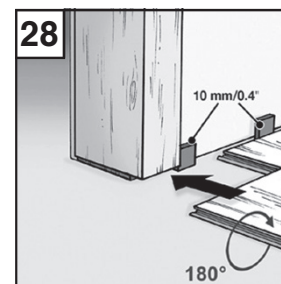
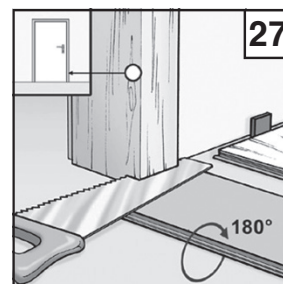
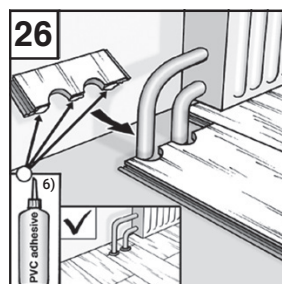
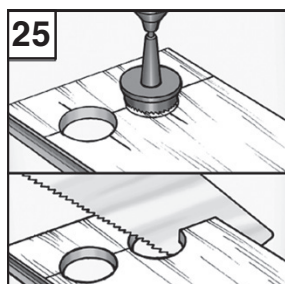
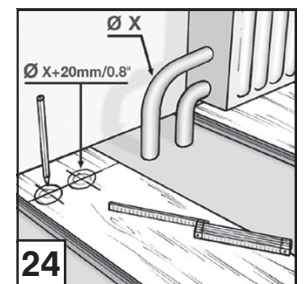
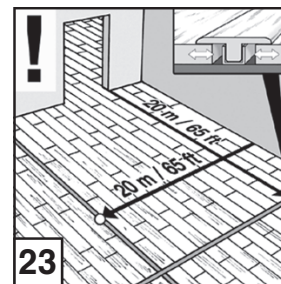
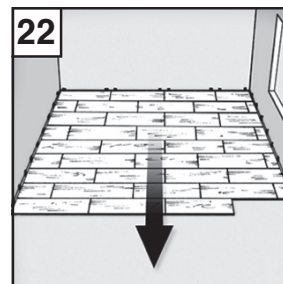
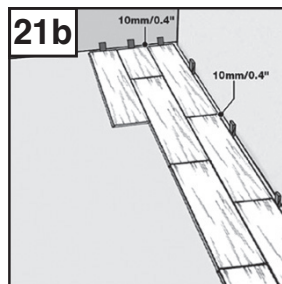
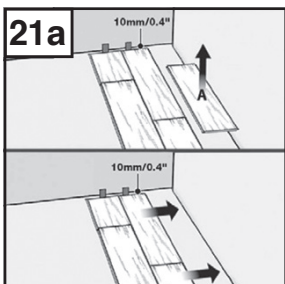
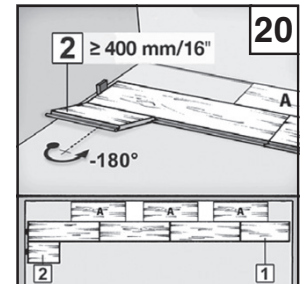
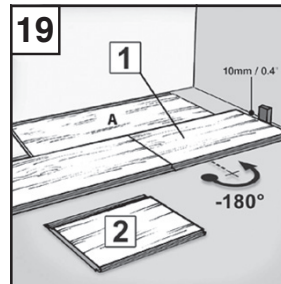
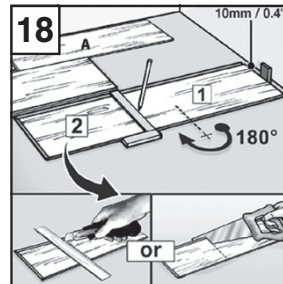
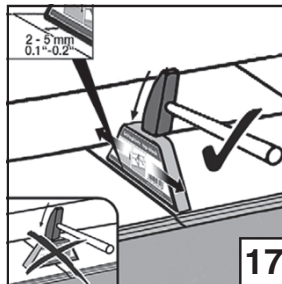
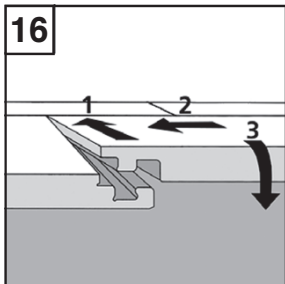
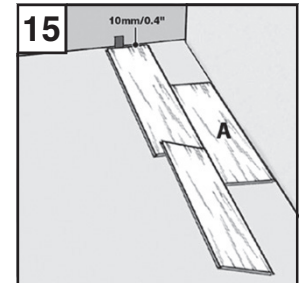
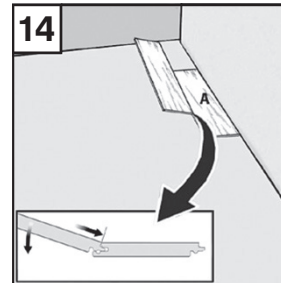
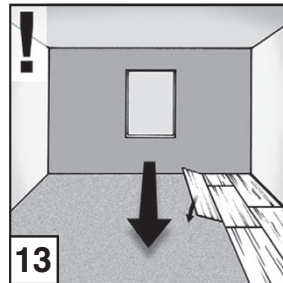
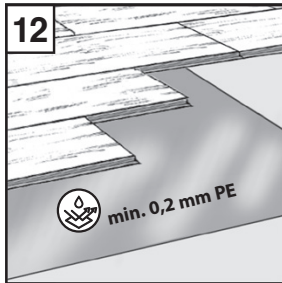
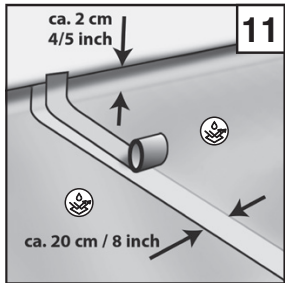
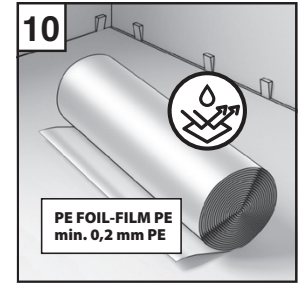
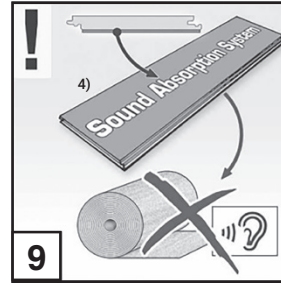
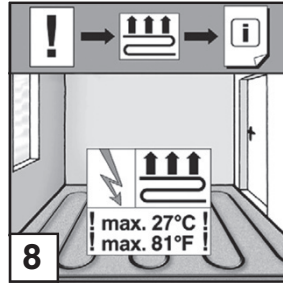
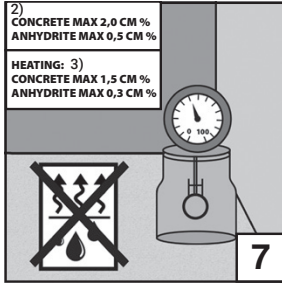
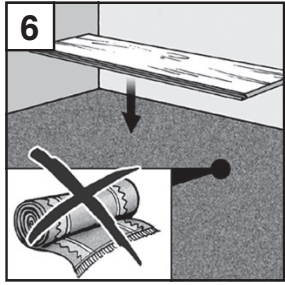
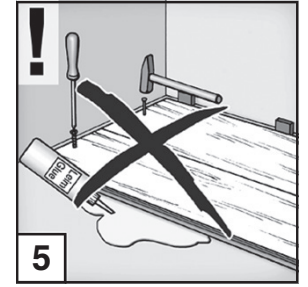
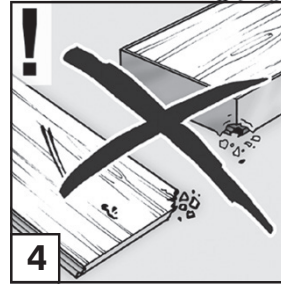
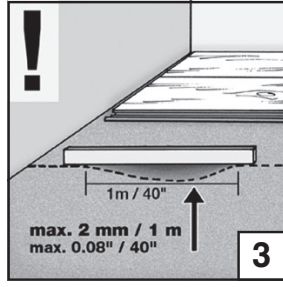
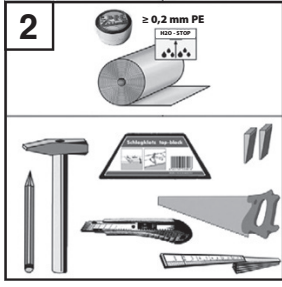
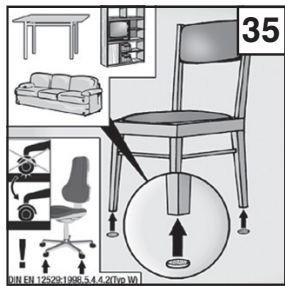
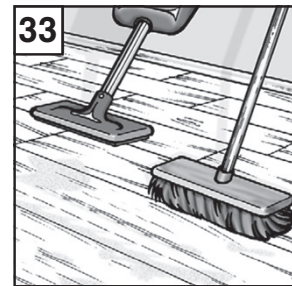
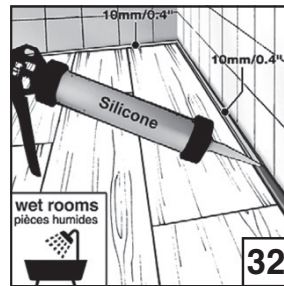
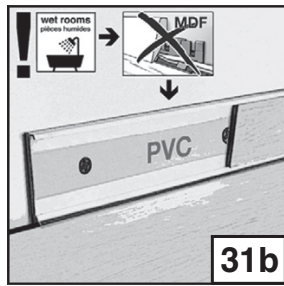
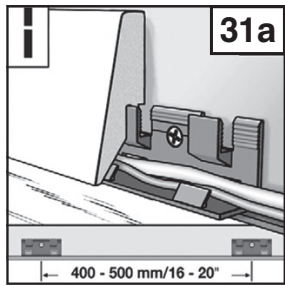
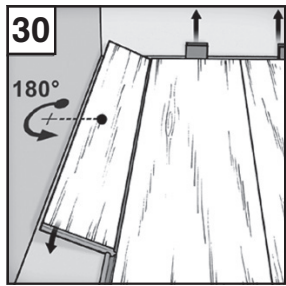

- 1) Humidity = Humidité
- 2) Concrete = béton
- 3) Heating = chauffage au sol
- 4) Sound absorption system = Isolation acoustique
- 5) PVC adhesive = colle PVC
- 6) Oil = huile

Demontaž/  
 Disassembly/  
 Le Déassemblage/  
 Deinstallation/  
 Demontáž/  
 Demontare/  
 Deinstalación:  
 Disinstallazione:

