

**PHILIPS**

hue personal  
wireless  
lighting

**Lightstrip Plus**



HUE serial number



User manual  
Benutzerhandbuch  
Notice d'emploi  
Manual de usuario  
Manual do usuário  
Manuale d'uso

Incl.

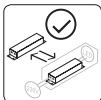
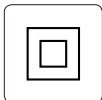
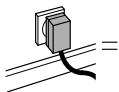
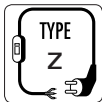
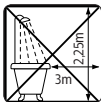
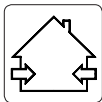
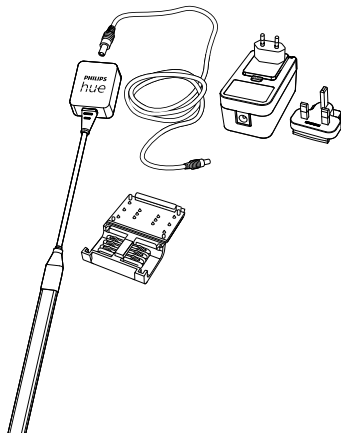

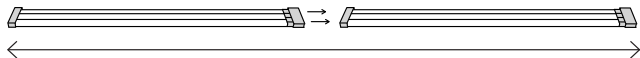

Max. 10m

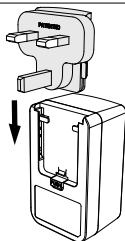
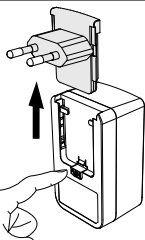

UK

click



OK

Not OK

LED!

Not OK

Min. 90°



X

X



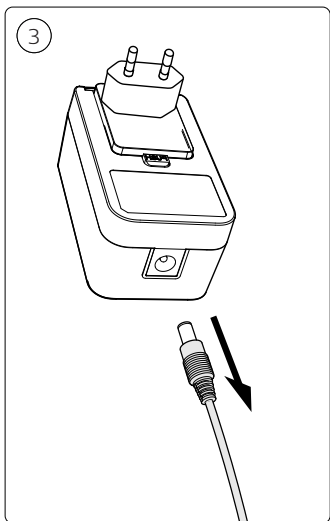
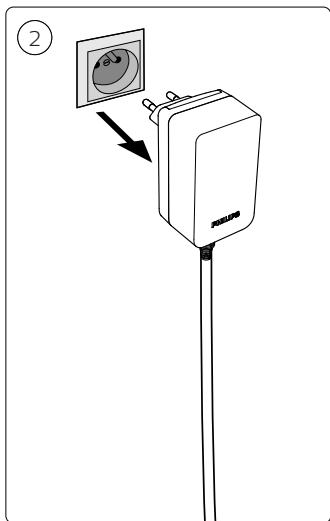
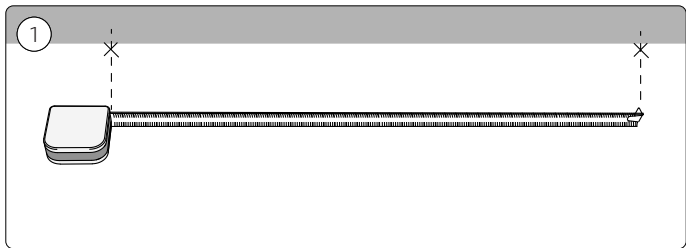

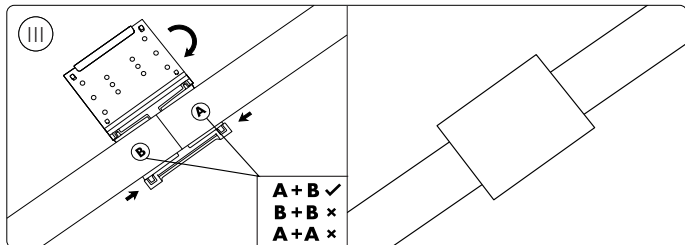
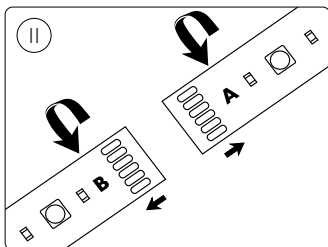
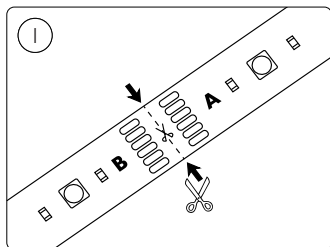
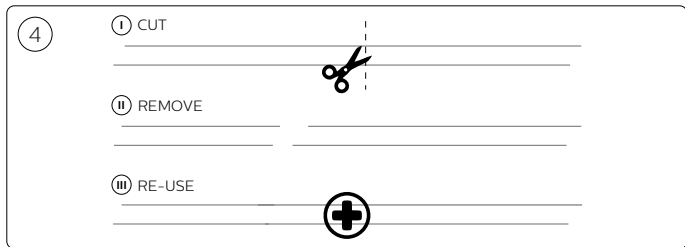

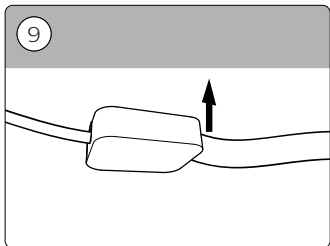
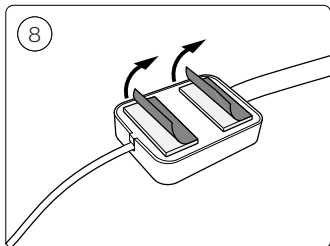
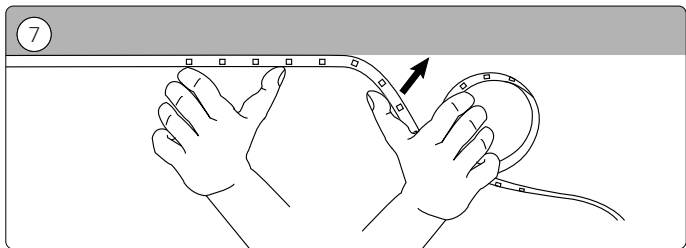
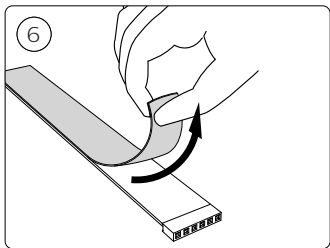
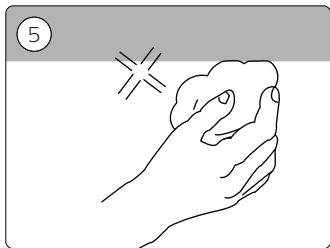

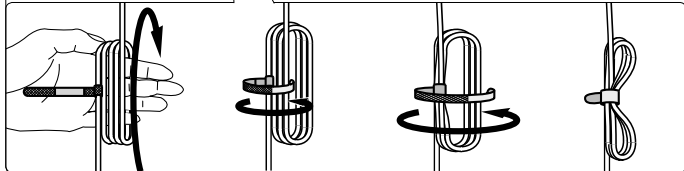
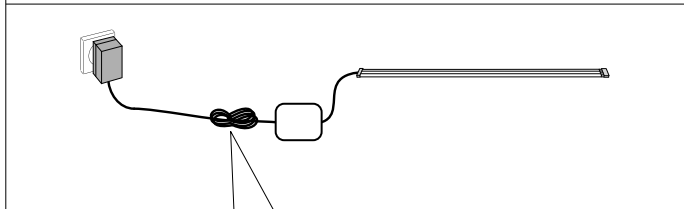
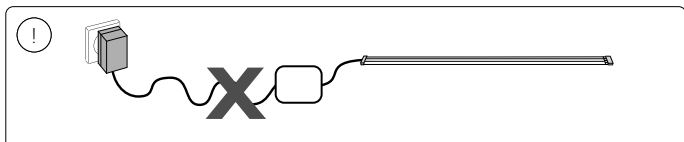
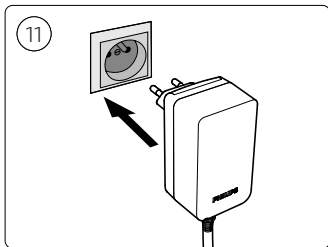
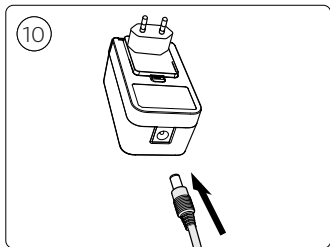

To connect your new Hue luminaire, select the installation instruction (A or B) that is applicable for you.

#### Discover

For more information visit  
[philips-hue.com](http://philips-hue.com)

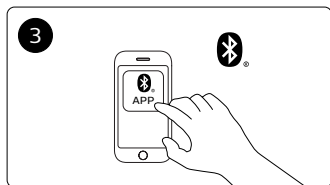
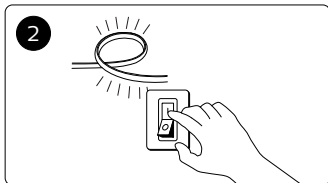
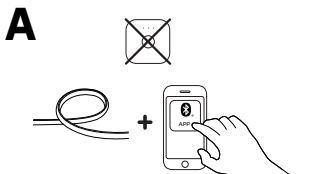

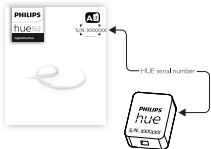
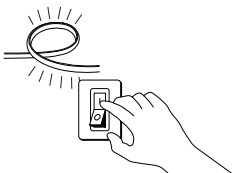

**B****1****2****3****4****5**

[www.philips-hue.com/philiphueapp](http://www.philips-hue.com/philiphueapp)

**6**

**DE**

Zum Verbinden Ihrer neuen Hue-Leuchte wählen Sie die für Ihre Situation zutreffende Installationsanweisung (A oder B)

**Entdecken**

Weitere Informationen finden Sie unter [www.philips-hue.com](http://www.philips-hue.com)

**FR**

Pour raccorder votre nouveau luminaire, sélectionnez la consigne d'installation (A ou B) qui s'applique à vous.

**Découverte**

Pour plus d'informations, rendez-vous sur [www.philips-hue.com](http://www.philips-hue.com)

**ES**

Para conectar su nueva luminaria Hue, seleccione la instrucción de instalación (A o B) que sea aplicable en su caso.

**Descubrir**

Para obtener más información, visita [www.philips-hue.com](http://www.philips-hue.com)

**PT**

Para ligar a sua nova luminária Hue, seleccione as instruções de instalação (A ou B) que se aplicam a si.

**Descobrir**

Para mais informações, visite [www.philips-hue.com](http://www.philips-hue.com)

**IT**

Per collegare il nuovo apparecchio per l'illuminazione Hue White, selezionare le istruzioni di installazione (A o B) adatte alle proprie esigenze.

**Scoperta**

Per ulteriori informazioni, visita il sito Internet [www.philips-hue.com](http://www.philips-hue.com)

**NL**

Kies de installatie-instructies (A of B) die voor jou van toepassing zijn om je nieuwe Hue armatuur aan te sluiten.

**Ontdek**

Meer informatie vindt u op [www.philips-hue.com](http://www.philips-hue.com)

**EL**

Για να συνδέσετε το νέο φωτιστικό Hue, επιλέξτε τις οδηγίες εγκατάστασης (Α ή Β) που ισχύουν για το δικό σας προϊόν.

**Ανακαλύψτε**

Για περισσότερες πληροφορίες, επισκεφθείτε την τοποθεσία [www.philips-hue.com](http://www.philips-hue.com)

**PL**

Aby podłączyć nową oprawę oświetleniową Hue, wybierz odpowiednią instrukcję instalacji (A lub B).

**Odkrywanie**

Więcej informacji można znaleźć na stronie internetowej [www.philips-hue.com](http://www.philips-hue.com)

**CZ**

Před připojením svítidla Hue zvolte montážní pokyny (A nebo B) relevantní pro váš systém.

**Nabídka**

Více informací naleznete na [www.philips-hue.com](http://www.philips-hue.com)

**HU**

Az új Hue lámpatest csatlakoztatásához válassza ki a körülményeknek megfelelő telepítési útmutatót (A vagy B).

**Fedezze fel**

A további tudnivalók a [www.philips-hue.com](http://www.philips-hue.com) oldalon olvashatók

**DA**

Tilslut det nye Hue White-armatur som angivet i den relevante installationsanvisning (A eller B).

**Opdage**

Du kan finde flere oplysninger på [www.philips-hue.com](http://www.philips-hue.com)

**SV**

Vid anslutning av en ny Hue-armatur väljer du den installationsanvisning (A eller B) som gäller för dig.

**Upptäck**

Mer information finns på [www.philips-hue.com](http://www.philips-hue.com)

**NO**

For å koble til den nye Hue-lysarmaturen, velg installeringsinstruksjonen (A eller B) som gjelder for deg.

**Bli kjent**

Du finner mer informasjon ved å gå til [www.philips-hue.com](http://www.philips-hue.com)

**FI**

Kytke uusi Hue-valaisin valitsemalla soveltuva asennusohje (A tai B).

**Tutustu**

Lisätietoja on osoitteessa [www.philips-hue.com](http://www.philips-hue.com)

**SK**

Ak chcete pripojiť svoje nové svetidlo Hue, vyberte montážne pokyny (A alebo B), ktoré sa naň vzťahujú.

**Objavte**

Ďalšie informácie získate na lokalite [www.philips-hue.com](http://www.philips-hue.com)



Signify  
I.B.R.S. / C.C.R.I. Numéro 10461  
5600 VB Eindhoven,  
the Netherlands  
☎00800-74454775

© 2021 Signify Holding  
All rights reserved

[www.philips-hue.com](http://www.philips-hue.com)

3222 639 05763  
Last update: 06/2021