

### **Consejos de Conservación**

1. No debe utilizarse en la limpieza, abrasivos como lana de acero, alcohol, limón, o productos corrosivos que puedan rayar o quitar la película en los muebles.
2. Cuando la limpieza de muebles en general, napa y formica, deben utilizarse un paño ligeramente humedecido y jabón suave.
3. Para mover el mueble, es importante que este se eleve desde el suelo, debido a que el arrastre puede causar daño estructural.
4. No deje el mueble en exposición a la intemperie.

### **Conservation Tips**

1. Do not use abrasive products to clean such as steel wool, alcohol, vinegar, lemon, scouring powder, or corrosive products which can scratch or peel off the protective film of the furniture.
2. The best way to clean your furniture is to use a slightly moistened cloth with a mild soap.
3. To move the furniture assembled, it is important that it is lifted off the ground, because the drag it can cause structural damage.
4. Do not leave your furniture in weather exposure.

### **Dicas de conservação**

1. Não utilizar na limpeza produtos abrasivos tais como: palha de aço, álcool, vinagre, limão, saponáceo ou produtos corrosivos que possam riscar ou descolar a película protetora dos móveis.
2. Na limpeza de móveis em geral, napa e fórmicas, deve ser utilizado um pano levemente umedecido e sabão neutro.
3. Para a movimentação do móvel, é importante que este seja levantado do chão, pois ao arrastá-lo pode causar avarias estruturais.
4. Não deixe o móvel em exposição a intempéries.

### **Conseils d'entretien**

1. Ne pas utiliser de produits abrasifs dans le nettoyage, tels que: laine d'acier, alcool, vinaigre, citron, poudre à récurer ou autres produits corrosifs pouvant rayer ou faire décoller la pellicule protectrice des meubles.
2. Pour le nettoyage du meuble, il est recommandé d'utiliser un chiffon humide et du savon neutre.
3. Pour déplacer le meuble, il est important de le soulever du sol car le tirer pourrait causer des dommages dans sa structure.
4. Ne pas exposer le meuble aux intempéries.

**LISTA DE PEÇAS / PARTS LIST / LISTA DE PEÇAS / LISTE DES PIÈCES**

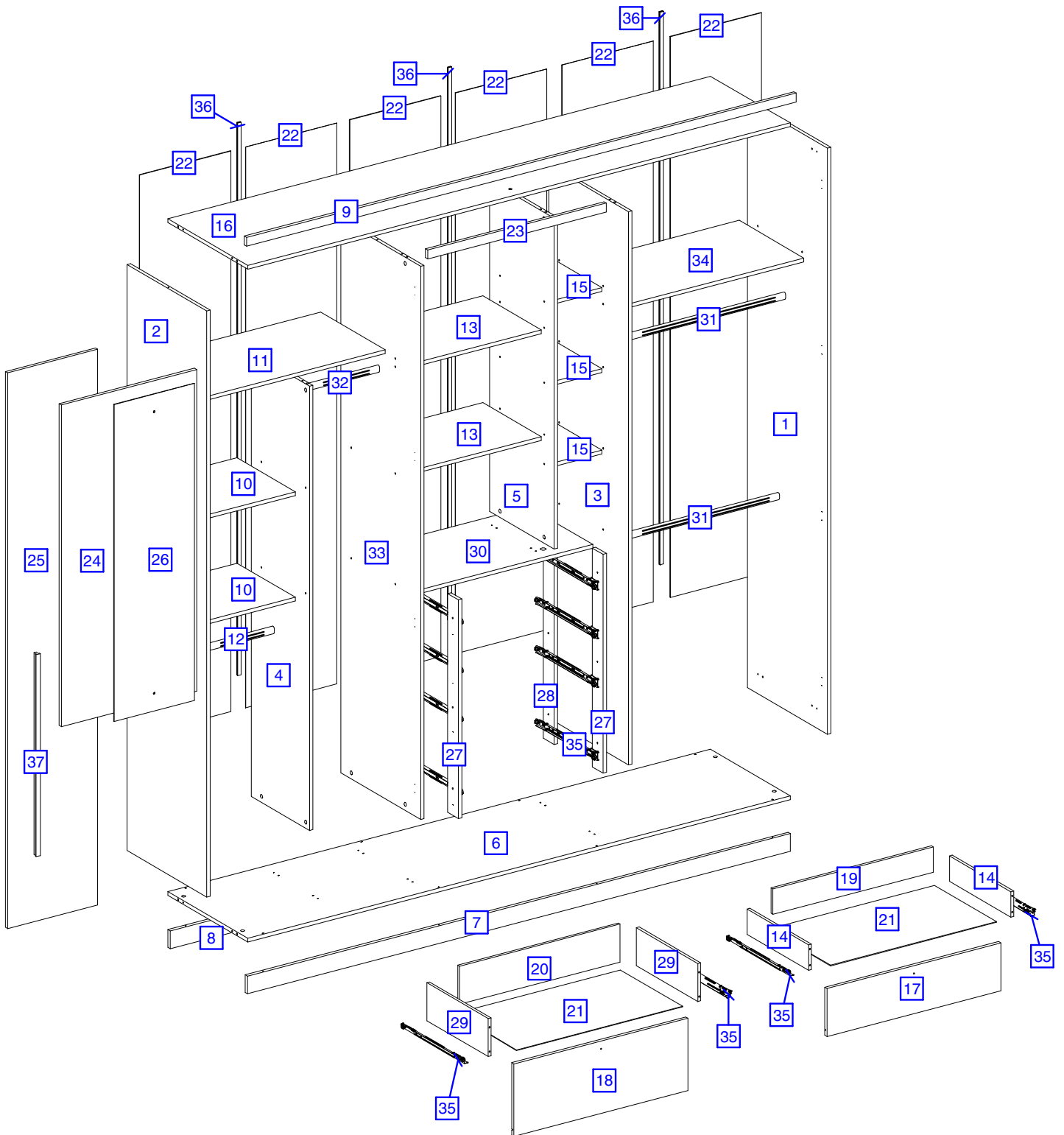

**HERRAMIENTAS / HARDWARE  
FERRAMENTAS / OUTILS**



**PERSONAS NECESARIAS PARA EL MONTAJE  
PEOPLE REQUIRED FOR ASSEMBLY  
PESSOAS NECESSÁRIAS PARA A MONTAGEM  
NOMBRE DE PERSONNES NÉCESSAIRES À L'ASSEMBLAGE**



## LISTA DE PEÇAS / PARTS LIST / LISTA DE PEÇAS / LISTE DES PIÈCES

#	Cantidad Quantity Quantidade Quantité	Piezas	Pieces	Peças	Pièces	Dimensiones Dimension Dimensões Dimension
1	1	Lateral Derecha	Right Side Panel	Lateral Direita	Côté Droit	2310 x 520 x 15
2	1	Lateral Esquerda	Left Side Panel	Lateral Esquerda	Côté Gauche	2310 x 520 x 15
3	1	División Derecha	Right Division	Divisão Maior Direita	Grand Séparateur Droit	2180 x 520 x 15
4	1	División Media	Medium Division	Divisão Média	Séparateur Moyen	1751 x 380 x 15
5	1	División Menor	Small Division	Divisão Menor	Petit Séparateur	1303 x 420 x 15
6	1	Base	Base Panel	Base	Fond	2370 x 520 x 15
7	1	Zócalo Delantero	Front Baseboard	Rodapé Dianteiro	Socle Avant	2370 x 70 x 15
8	1	Zócalo Trasero	Back Baseboard	Rodapé Traseiro	Socle Arrière	2370 x 70 x 15
9	1	Marco Superior	Upper Frame	Moldura Superior	Cadre Supérieur	2400 x 35 x 15
10	2	Repisa Fija	Fixed Shelf	Prateleira Fixa	Étagère Fixe	410 x 380 x 15
11	1	Repisa Maior	Large Shelf	Prateleira Maior	Grande Étagère	780 x 420 x 15
12	1	Rolizo Percha Menor	Small Hanger Rail	Cabideiro Menor	Petit Cintre	400mm
13	2	Repisa Media	Medium Shelf	Prateleira Média	Étagère Moyenne	567 x 380 x 15
14	6	Lateral Cajón	Drawer Side	Lateral de Gaveta	Côtés Droit et Gauche Tiroir	400 x 100 x 12
15	3	Repisa Menor	Small Shelf	Prateleira Menor	Petit Étagère	198 x 380 x 15
16	1	Tapa	To Panel	Tampo	Pièce du Dessus	2370 x 520 x 15
17	3	Frente Cajón Menor	Small Drawer Front	Frente Gaveta Menor	Façade Petit Tiroir	760 x 189 x 15
18	1	Frente Cajón Maior	Large Drawer Front	Frente Gaveta Maior	Façade Grand Tiroir	760 x 285 x 15
19	3	Trasero Cajón	Drawer Back	Costa Gaveta	Pièce Arrière Tiroir	701 x 100 x 12
20	1	Trasero Cajón Mayor	Large Drawer Back	Costa Gaveta Maior	Pièce Arrière Grand Tiroir	701 x 150 x 12
21	4	Fondo Cajón	Drawer Bottom	Fundo Gaveta	Fond Tiroir	725 x 405 x 3
22	6	Costado	Back	Costa	Pièce Arrière	2210 x 398 x 3
23	1	Marco Interno	Internal Frame	Moldura Interna	Cadre Interne	780 x 35 x 15
24	1	Puerta Menor	Smaller Door	Porta Menor	Petite Porte	1268 x 592 x 15
25	4	Puerta Maior	Large Door	Porta Maior	Grande Porte	2190 x 393 x 15
26	1	Espejo	Mirror	Espelho	Miroir	1250 x 350 x 3
27	2	Distanciador Cajón Frontal	Drawer Front Separator	Afastador Dianteiro	Séparateur Avant	862 x 70 x 15
28	2	Distanciador Cajón Trasero	Back Front Separator	Afastador Traseiro	Séparateur Arrière	862 x 70 x 15
29	2	Lateral Cajón Mayor	Large Drawer Side	Lateral de Gaveta Mayor	Côtés Droit et Gauche Grand Tiroir	400 x 150 x 12
30	1	Tapa Cajones	Drawers Top	Tampo Gavetas	Plafond Tiroirs	780 x 420 x 15
31	2	Rolizo Percha	Hanger Rail	Cabideiro	Cintre	770mm
32	1	Rolizo Percha	Hanger Rail	Cabideiro	Cintre	345mm
33	1	División Esquerda	Left Division	Divisão Esquerda	Grand Séparateur Gauche	2180 x 520 x 15
34	1	Repisa	Shelf	Prateleira	Étagère	780 x 420 x 15
35	4	Corredera Metálica	Metalic Sliding	Corred. Metálica	Glissière Métallique	400mm
36	3	Perfil I	Profile I	Perfil I	Profil I	2178mm
37	2	Tirador	Handle	Puxador	Poignée	800mm

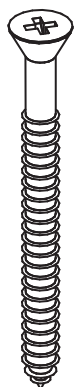

**A-48x**



**B-28x**

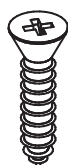

**C-8x**



**D-184x**



**E-40x**



**F-24X**

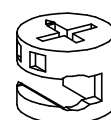

**G-24X**

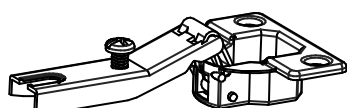

**H-19X**

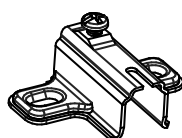

**I-3x**

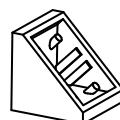

**J-30x**

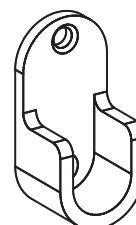

**K-8x**



**L-8x**



**M-8x**



**N-24x**

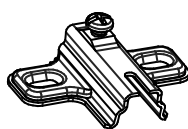

**O-16x**

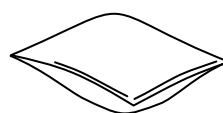

**P-1x**



**Q-8x**



**R-50x**

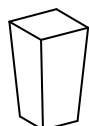

**S-4x**



**T-110x**



**U-56x**

1

Aplique Cola en los Agujeros  
Apply Glue in Holes  
Aplicar Cola nas Furações  
Appliquer de la colle dans les perçages

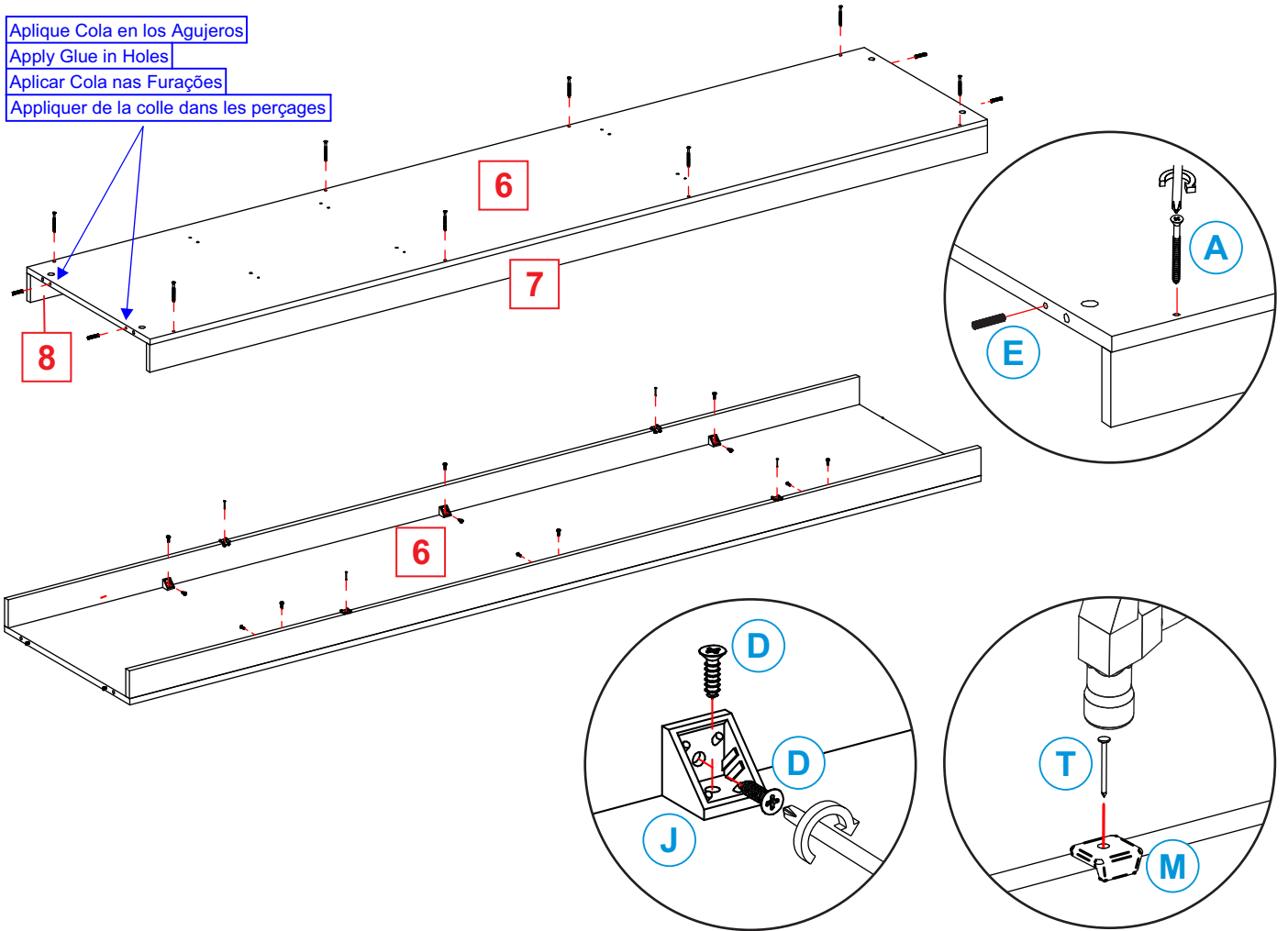

2

Aplique Cola en los Agujeros  
Apply Glue in Holes  
Aplicar Cola nas Furações  
Appliquer de la colle dans les perçages

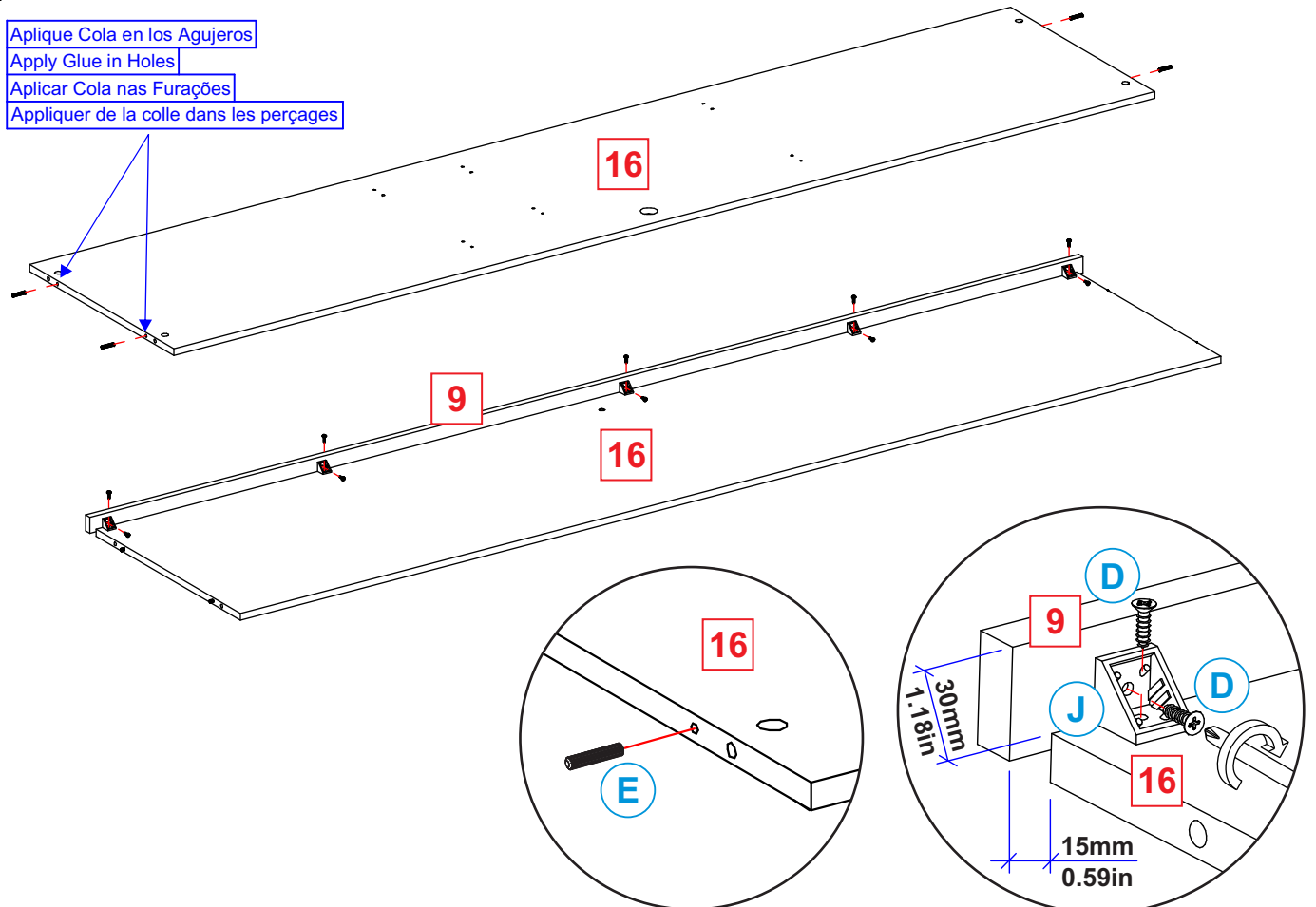

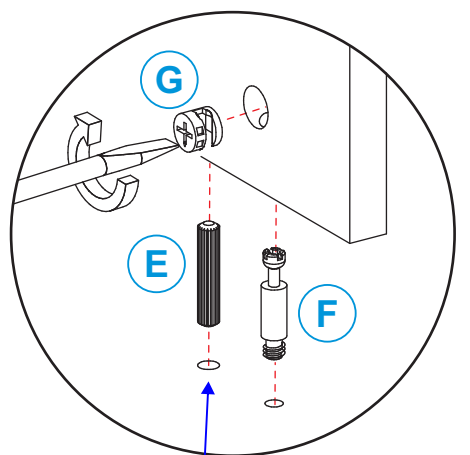
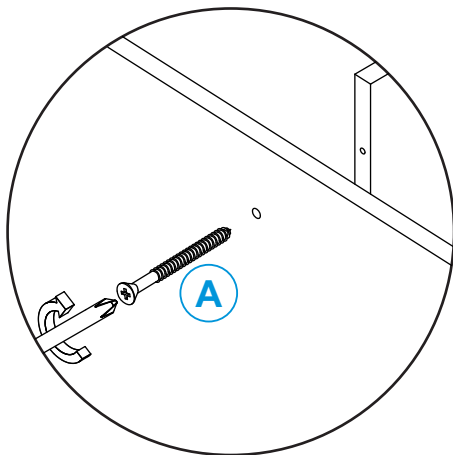
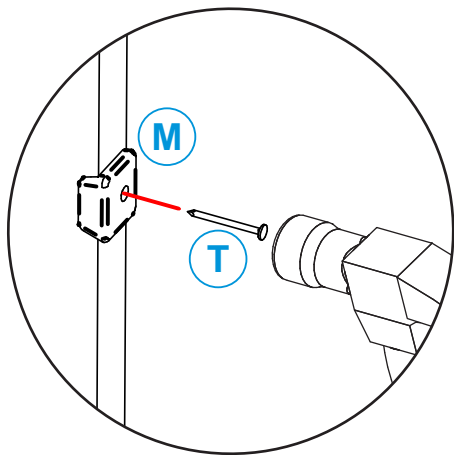
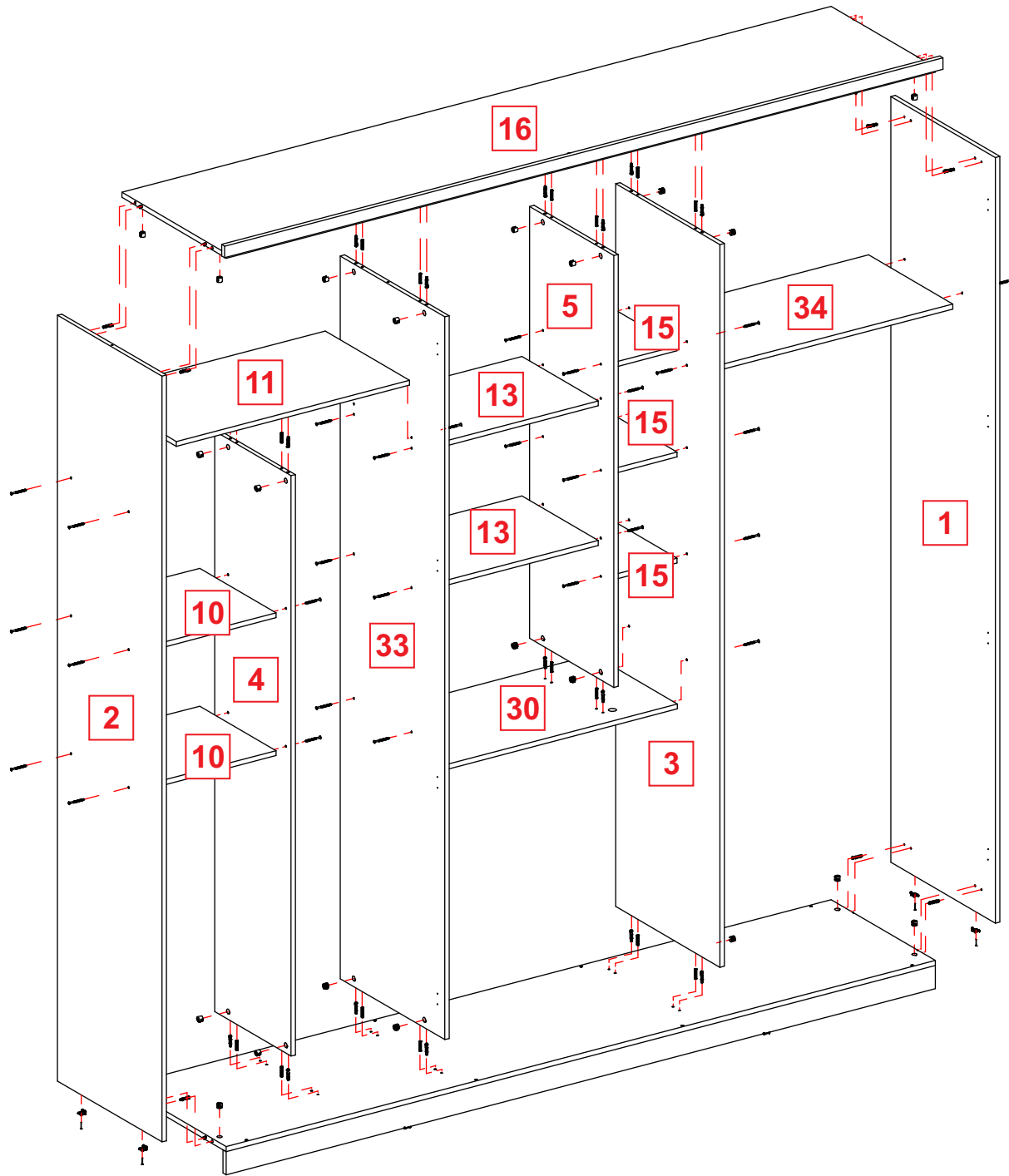

Aplique Cola en los Agujeros  
Apply Glue in Holes  
Aplicar Cola nas Furações  
Appliquer de la colle dans les perçages

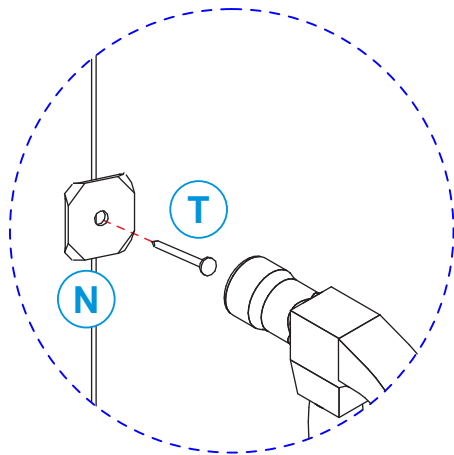
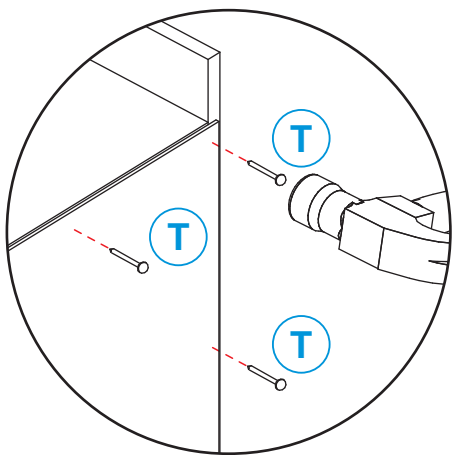
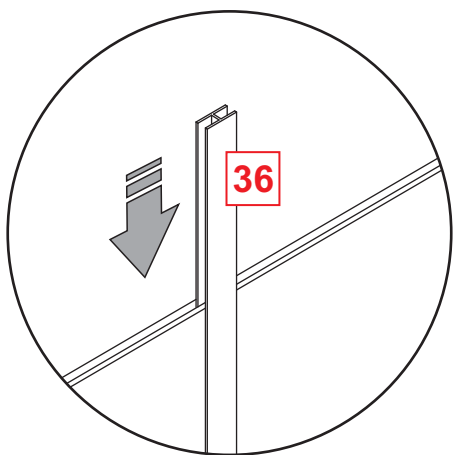
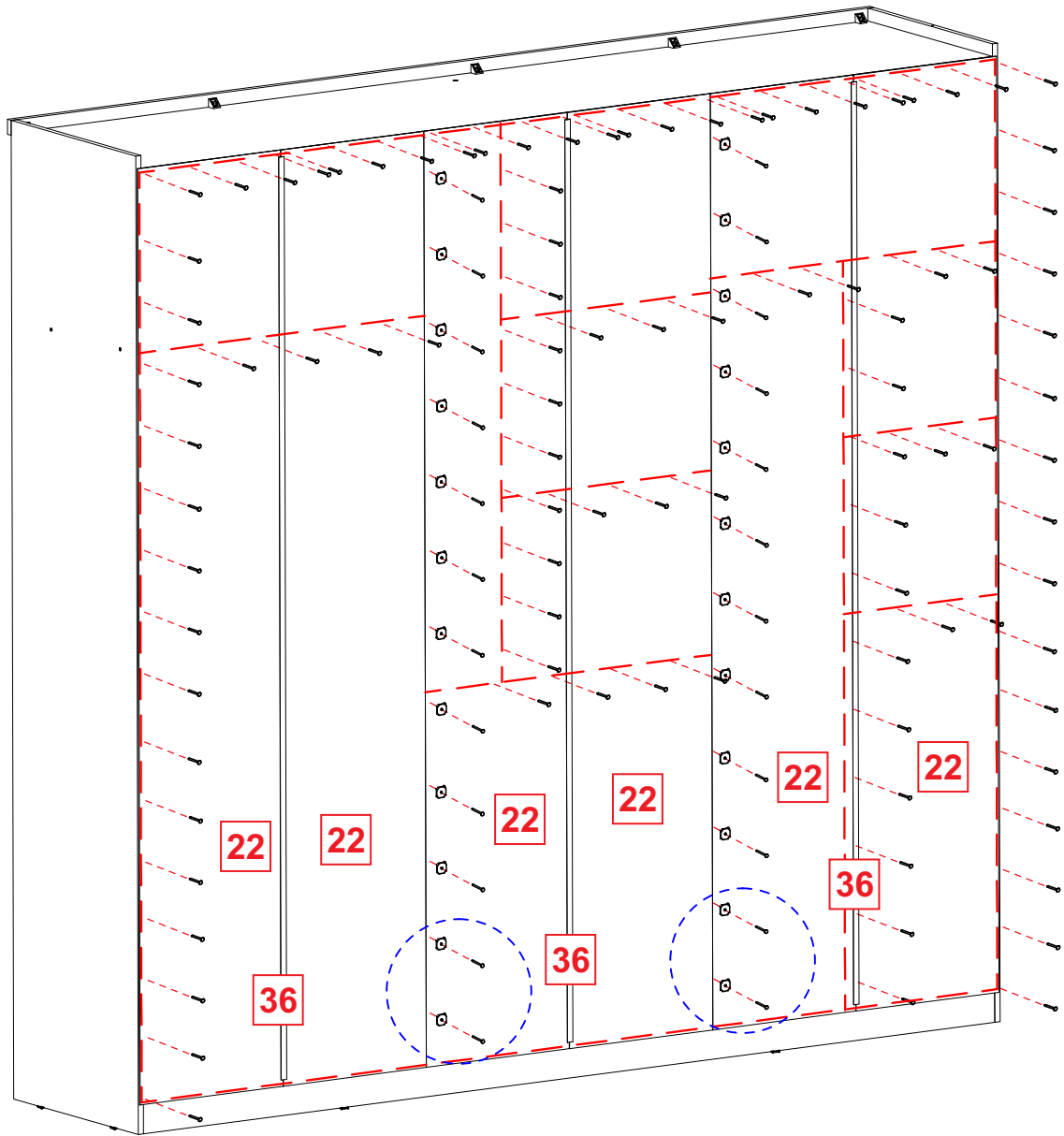

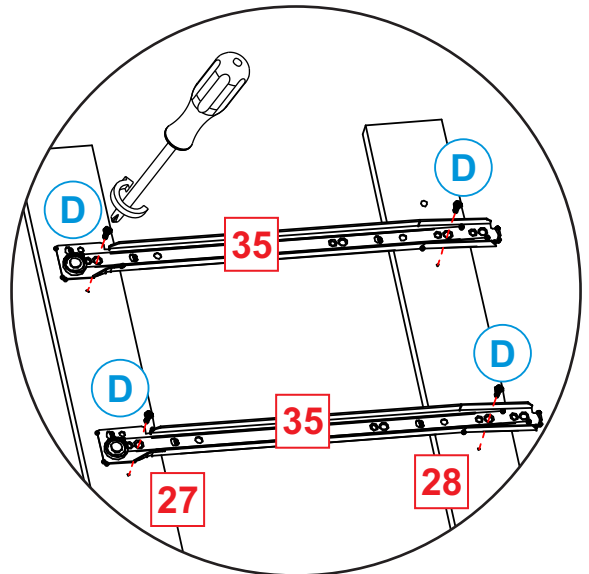
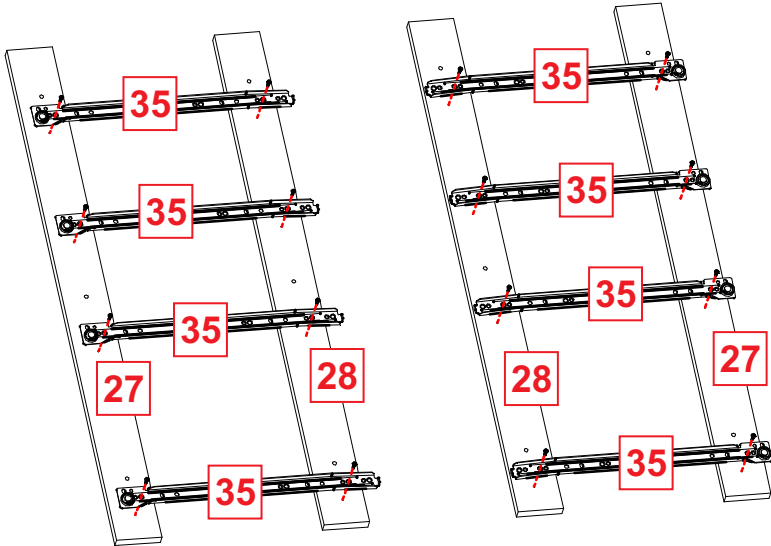
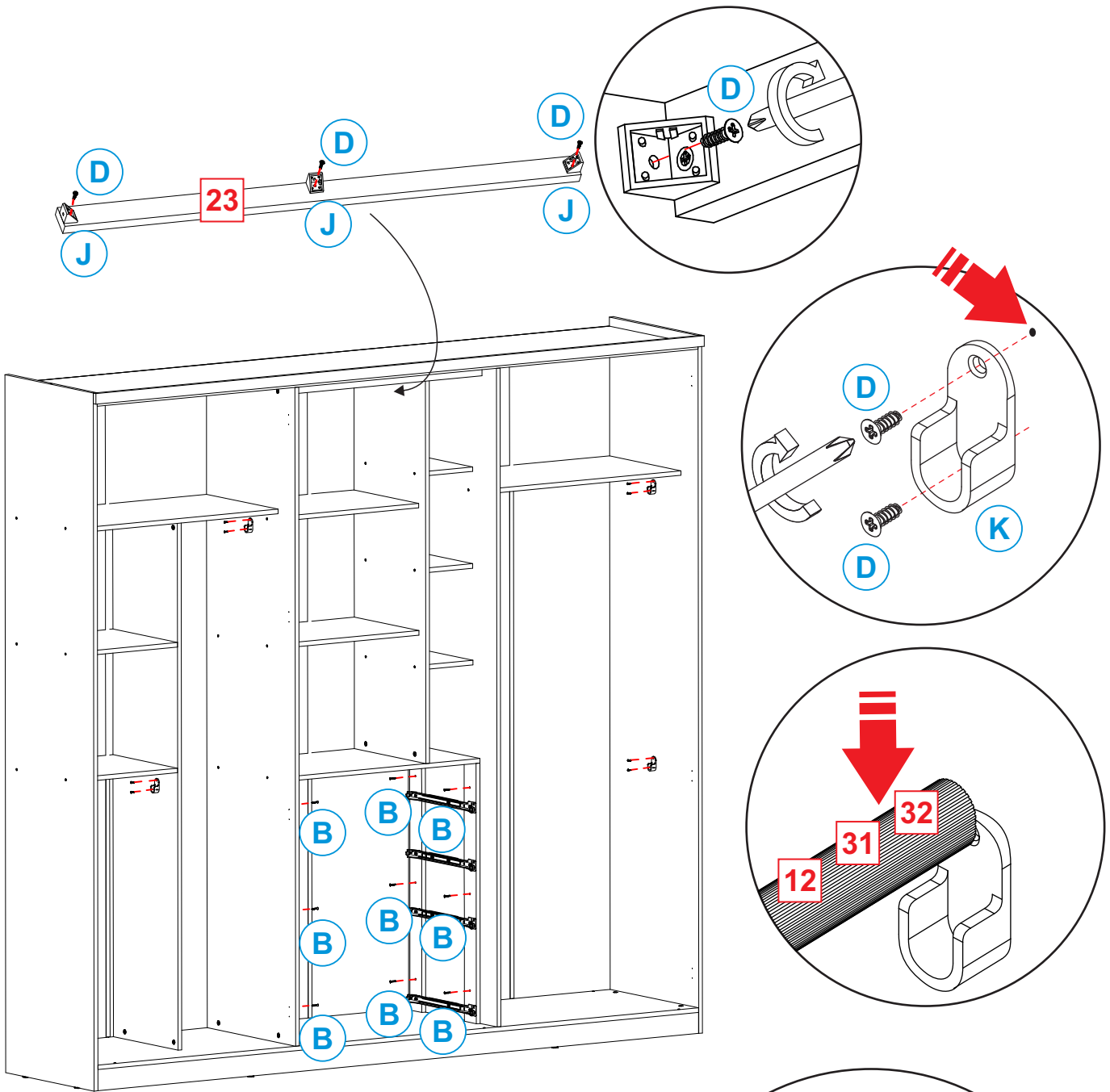

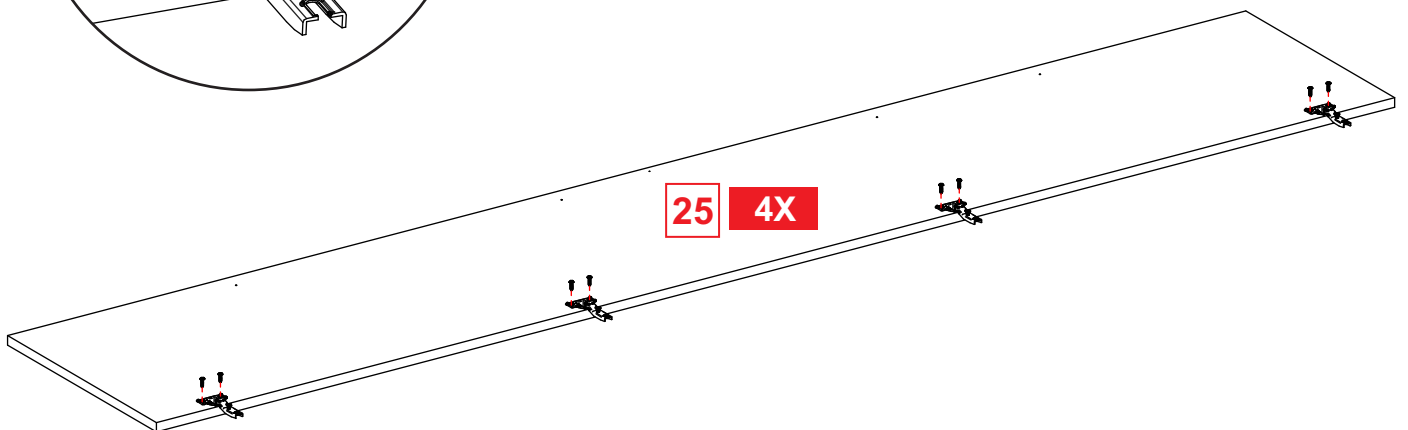
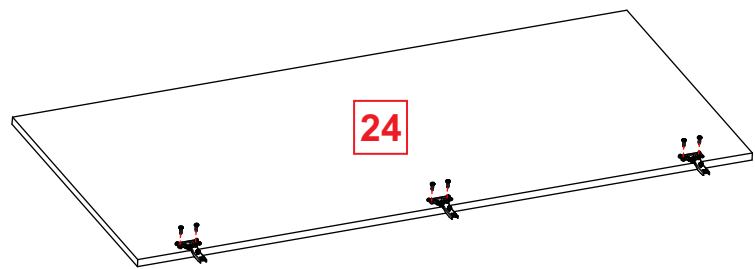
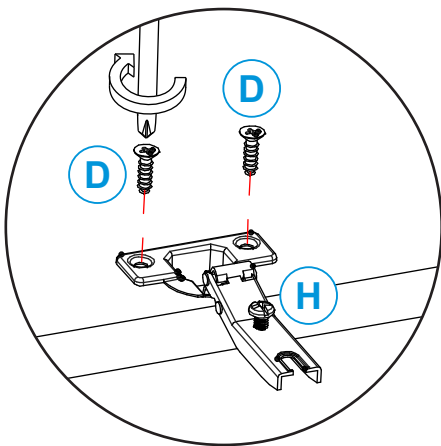
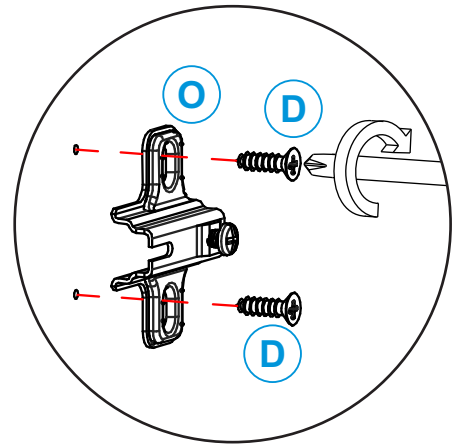
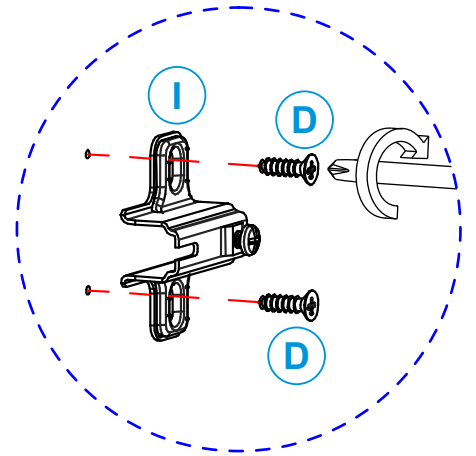
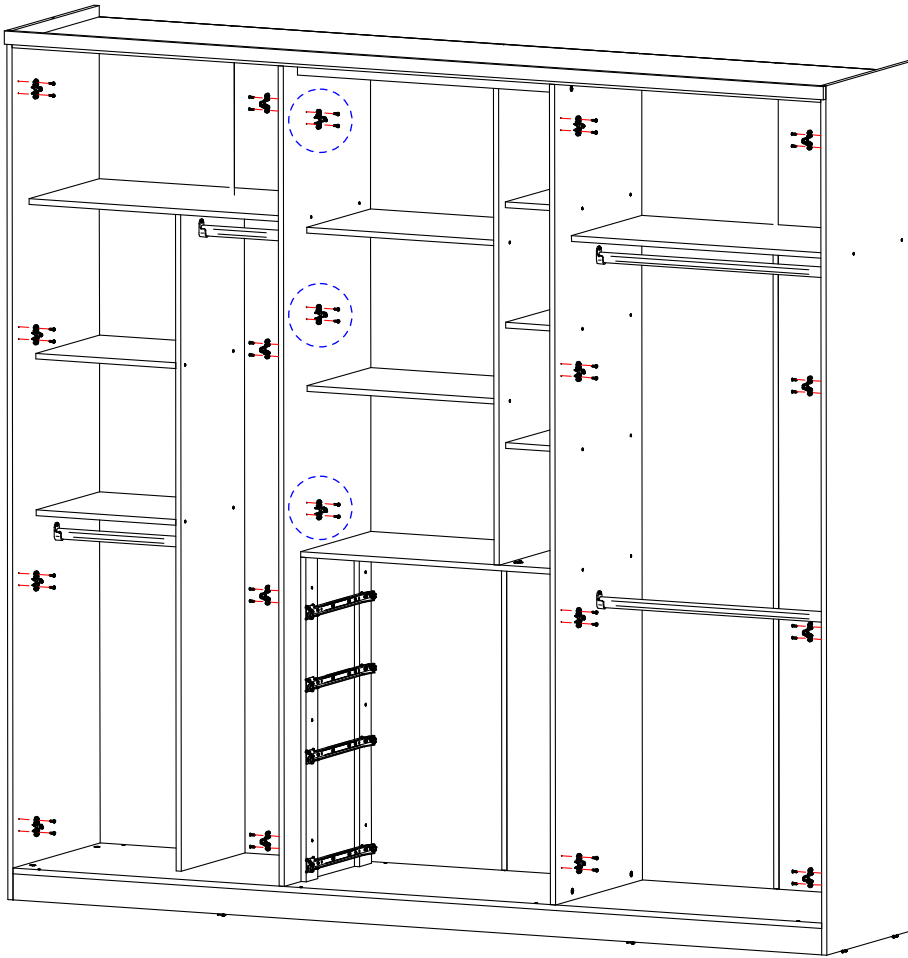

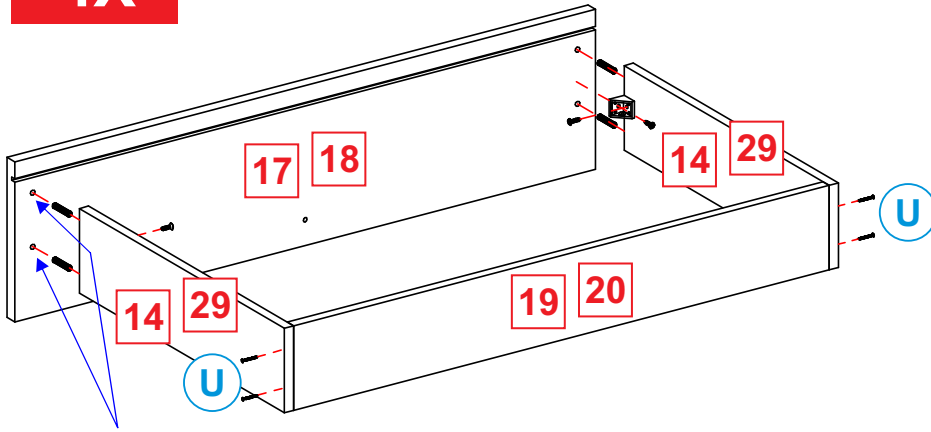

Aplique Cola en los Agujeros  
 Apply Glue in Holes  
 Aplicar Cola nas Furações  
 Appliquer de la colle dans les perçages

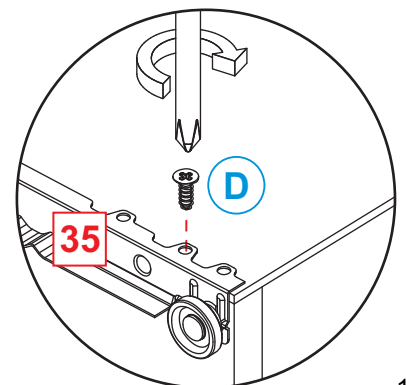
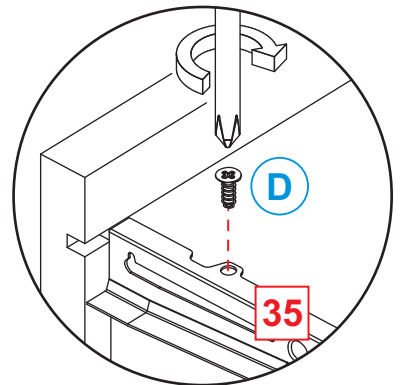
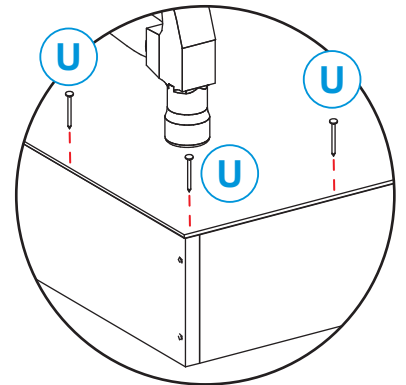
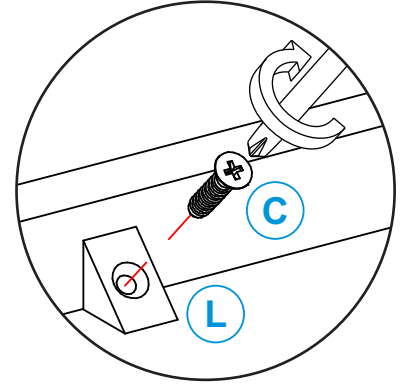
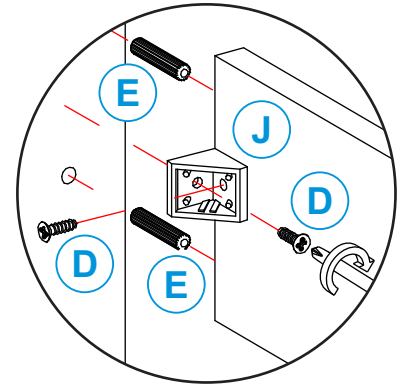
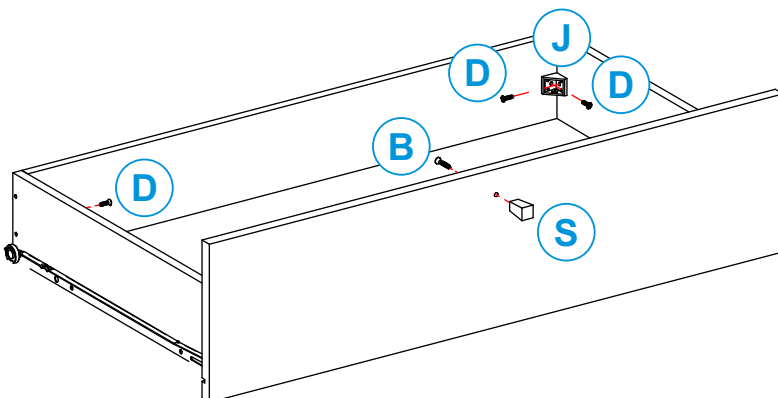
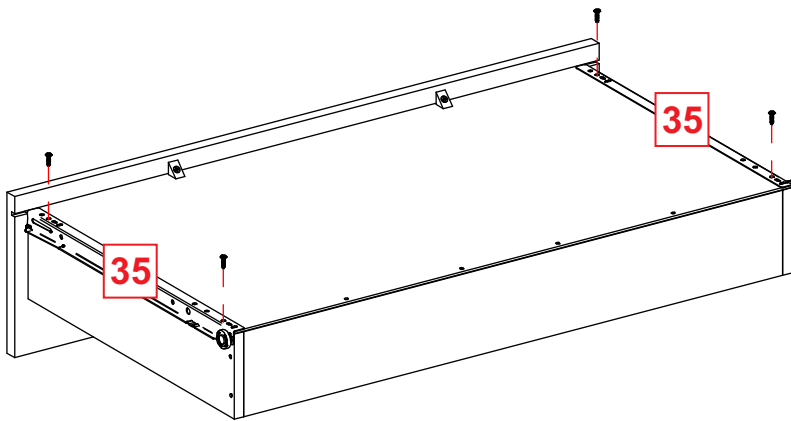
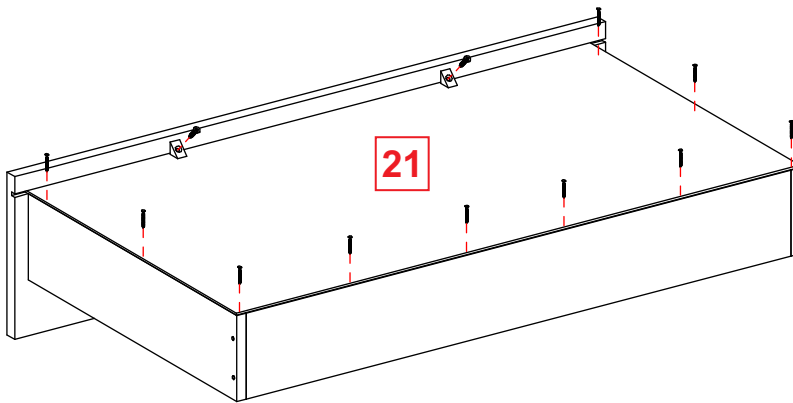

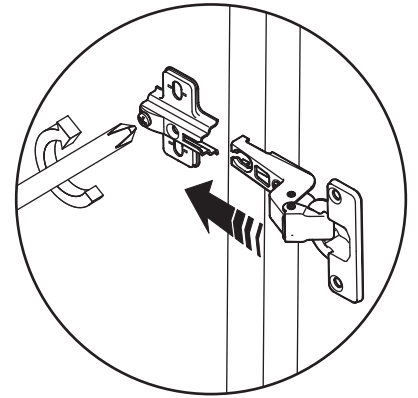
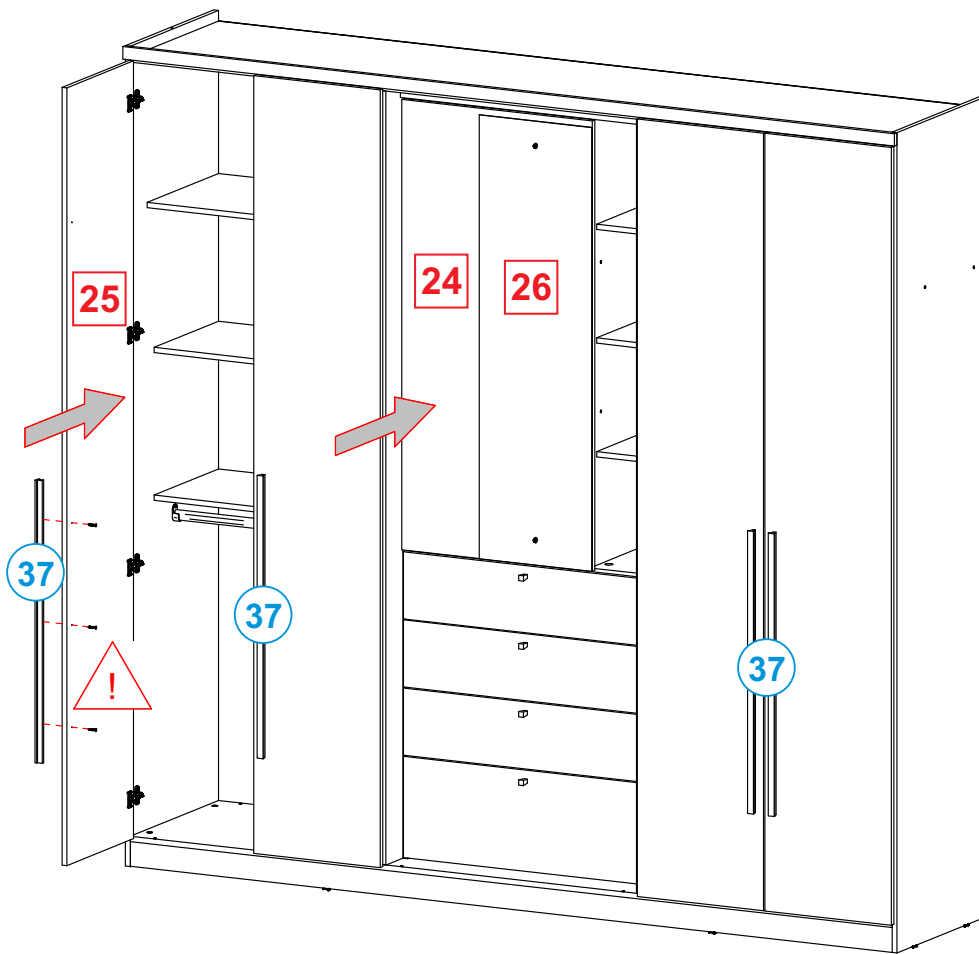

Encaje de la puerta  
Door setting  
Encaixe da porta  
Assemblage des portes

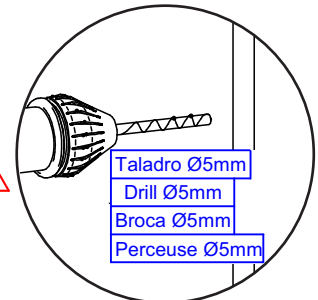
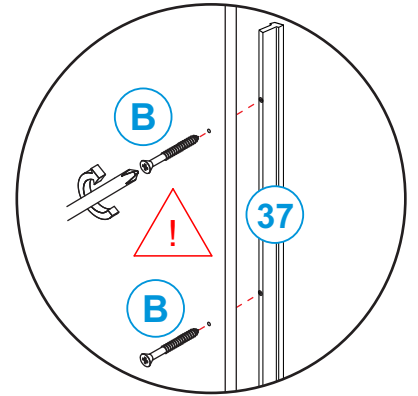

Taladro Ø5mm  
Drill Ø5mm  
Broca Ø5mm  
Perceuse Ø5mm

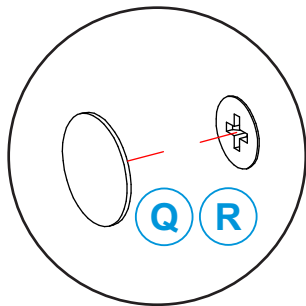

Aplique los adhesivos en los puntos de fijación aparentes.  
Fix the stickers to the drillings.  
Aplique os adesivos nos pontos de fixação aparente.  
Poser les pastilles adhésives dans les trous de fixation des parois.

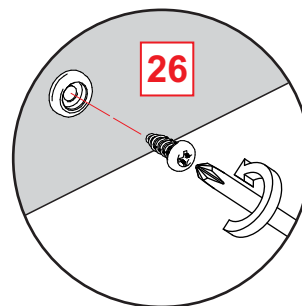

Accesorios se incluyen con el paquete del espejo.  
Accessories come with the package mirror.  
Acessórios acompanham a embalagem do espelho.  
Accessoires inclus dans l'emballage du miroir.

**Ajuste das Portas / Door Adjustment / Ajuste de las Puertas / Réglage des charnières de la porte**

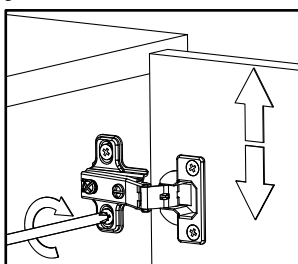

Ajuste del alto  
Height adjustment  
Ajuste de altura  
Réglage en hauteur

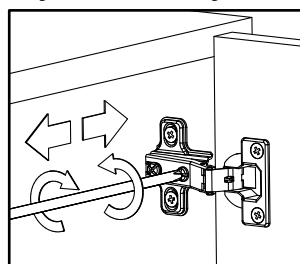

Ajuste interno  
Internal adjustment  
Ajuste interno  
Réglage latéral

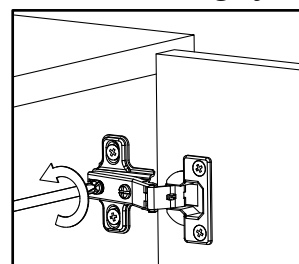

Ajuste de la profundidad  
Depth adjustment  
Ajuste de profundidade  
Réglage en profondeur

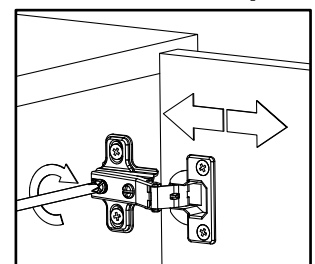

**Installation Lamp Kit / Kit de instalación de la lámpara / Instalação do Kit Luminária / Installation du Kit Limière**

1º: Placing switch and lamp / Colocación interruptor y lámpara / Colocação do interruptor e da luminária / Placement de l'interrepteur et de la lampe

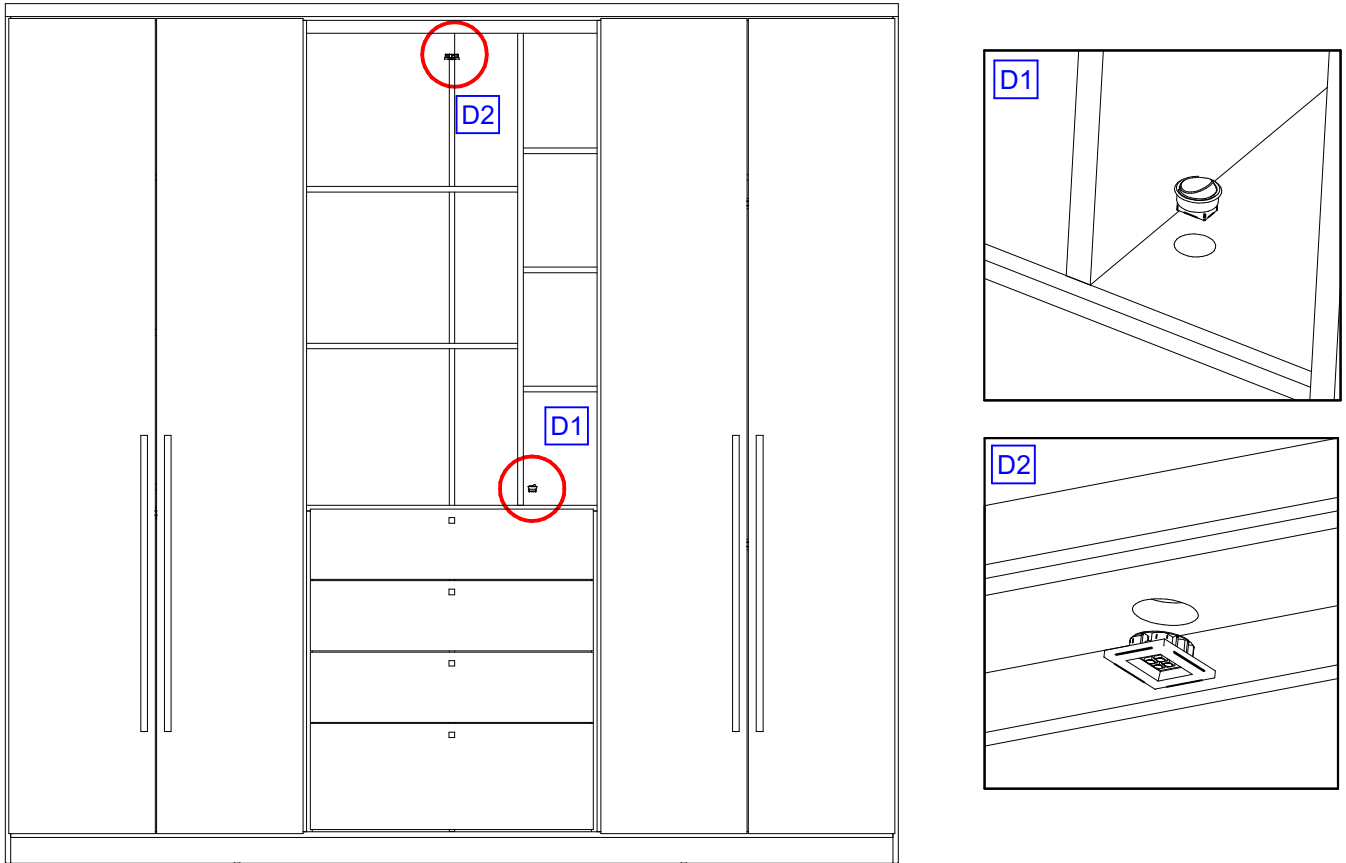

2º: Will need to drill one of the central backs of wardrobe, using a drill  $\text{\O}15\text{mm}$ , as specified measurements. After following the instructions in the manual that came with the lamp kit box, pass the electrical wiring behind the wardrobe, making the connection between lamp and switch correctly.

Tendrá que perforar una de las costas centrales del armario, usando un taladro de  $\text{\O}15\text{mm}$ , como medidas especificadas. Después de seguir las instrucciones en el manual que viene con la caja del kit de la lámpara, pase el cableado eléctrico detrás del armario, por lo que la conexión entre la lámpara y cambiar correctamente.

Será necessário furar uma das costas centrais do roupeiro, usando um broca de  $\text{\O}15\text{mm}$ , conforme medidas especificadas. Após, seguindo as instruções do manual que acompanha a caixa do kit luminária, passar a fiação elétrica por trás do roupeiro, fazendo a ligação entre luminária e interruptor corretamente.

Perçer un trou dans la paroi du milieu arrière de l'armoire, en utilisant une perceuse 15mm, conformément aux mesures apécifiés. Ensuite, en suivant les instructions de la notice incluse dans le Kit Lumière, passer le câble électrique derrière l'armoire, en raccordant correctement la lampe à l'interrupteur.

